

# FLEX+ ASSEMBLY

A	FLEX+ BODY	1
B	FLEX+ LID	1
C	LID GASKET	1
D	V-BAND CLAMP	1
E	1.5" BUTTERFLY VALVE	1
F	TC RACKING ARM	1
G	1.5" GASKET	4
H	1.5" CLAMP	4
I	1.5" TC CAP	1
J	1.5" TC X BARB	1
K	STICK ON THERMO	1
L	4" TC CAP	1
M	4" TC CLAMP	1
N	4" TC GASKET	1

Tighten clamp until hand snug



See below for gasket install instructions

## GASKET LID INSTRUCTIONS



With the lid upside down press the lid gasket into the gasket gland on the lid starting at the 6 o'clock position.

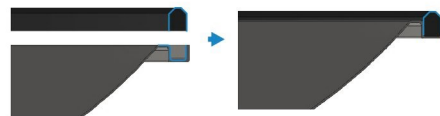

Make sure that the flat side of the gasket goes into the gasket gland with the pointed side facing out.



Finish installing the gasket by pushing it in at the 12 o'clock position and then the 3 and 6 o'clock position.



**Note:** If the gasket is not installed as described it will stretch as it is installed and will appear to be too large like above.