

★WITH THE WHEEL YOU SHOULD HAVE RECEIVED.

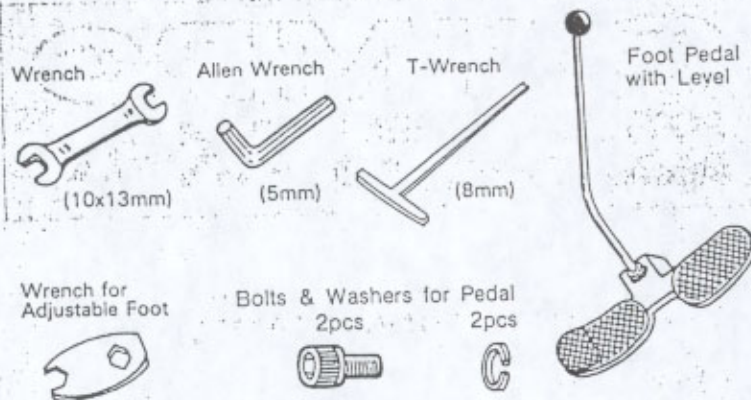

DESCRIPTION OF PARTS

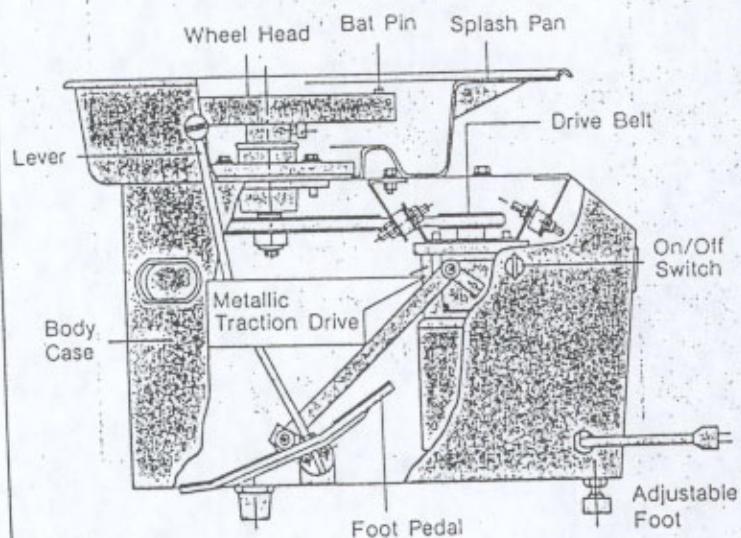

SPECIFICATIONS

- Model : RK-10 BASIC
- Motor : 200W, 1/4HP, 115V, 60Hz Single-Phase
- Speed Control Mechanism : Metallic Traction Drive
- Speed Control System : Foot Pedal with Lever
- Wheel Head-Speed : 0-250rpm
- Direction : Clockwise and Counter-clockwise
- Diameter : 12"
- Material : Light alloy casting
- Dimensions : 26"(Length) × 18"1/2(Width) × 19"(Height)
- Weight : 93 lbs

RK-10

2 HOW TO OPERATE

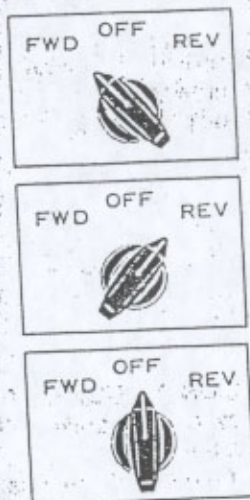

1. PLUG IN FIRMLY.

2. TURN SWITCH TO :

FWD : Wheel head is rotating in a counter-clockwise direction.

REV : Wheel head is rotating in a clockwise direction.

OFF : Motor is off.

Note :

Do not change rotating direction while motor is running. Change only after motor has come to a complete stop. (Approx. 30 seconds after switch has been turned to "OFF".)

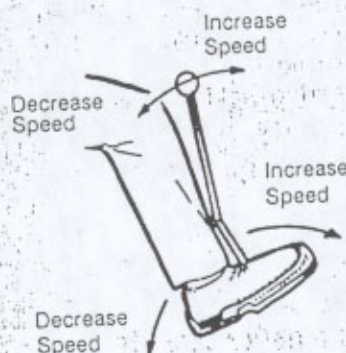

3. SPEED CONTROL

Press pedal forward to increase speed or backward to decrease speed. Unit can be operated at any speed between 0-250rpm.

Note :

With switch in "OFF" — Wheel head can be turned by hand when pedal is in only "High-Speed" position. Do not attempt to turn wheel head by hand when pedal is in "Zero-Speed" position.

3 MAINTENANCE & ADJUSTMENT

Turn switch to "OFF" position and unplug potter's wheel before proceed.

① ZERO SPEED ADJUSTMENT

If wheel head will not stop when pedal is in zero position.

1. Place potter's wheel on side.
2. Loosen lock nut with wrench.
3. If wheel head is rotating counter-clockwise, turn bolt 1/4 turn in clockwise direction.
If wheel head is rotating clockwise, turn bolt 1/4 turn in counter-clockwise direction.
4. Tighten lock nut.
5. Return unit to normal upright position to check zero speed. If wheel head continues to rotate, repeat above adjustment as many times as necessary until wheel head stops completely.

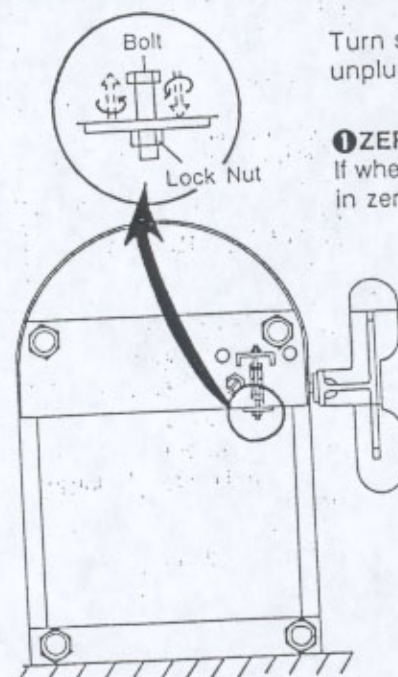

RK-10

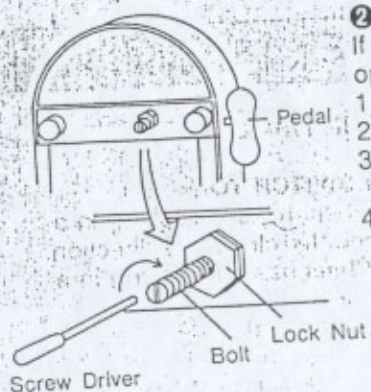

2 BRAKE ADJUSTMENT

If pedal does not hold position during operation, adjust pedal brake.

1. Place potter's wheel on side.
2. Loosen lock nut.
3. Turn bolt 1/2 turn in clockwise direction with screw driver.
4. Gently tighten lock nut.

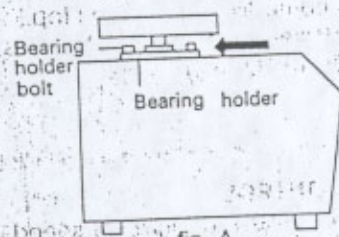

3 DRIVE BELT TENSION ADJUSTMENT

A drop in power may indicate drive belt tension needs adjustment.

1. Loosen bearing holder bolts (4 pcs.)
2. Push bearing holder 1/8" in the direction of arrow (see fig A).
3. Check tension of drive belt. When pressed, drive belt should bend 1/4" to 1/2" (see fig B).
4. Tighten bearing holder bolts.

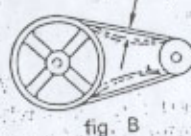

4 DRIVE BELT REPLACEMENT

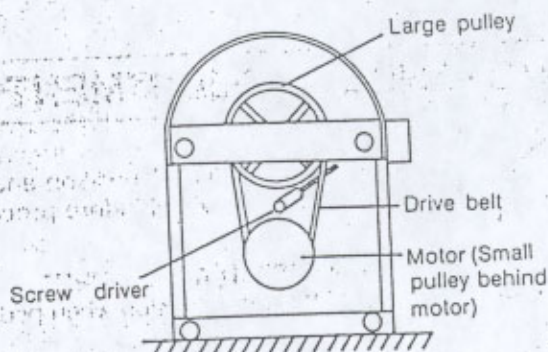

1. Turn switch to "FWD or REV"
2. Press pedal to highest speed position.
3. Turn switch to "Off" and unplug potter's wheel.
4. Place potter's wheel on its side (as shown in fig.).
5. Place screw driver between large pulley and drive belt.
6. Turn large pulley by hand to remove drive belt.
7. Put new drive belt around small pulley. Continue onto large pulley by turning large pulley by hand.

RK-10

⑤ LUBRICATION

After several years, if lubrication becomes necessary.

1. Turn unit on side.
2. Oil at points indicated in diagram.

Note : Keep oil off pad.

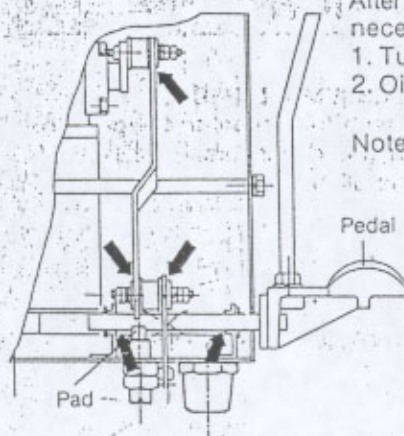

RK-10

SHIMPO-WEST, INC.

14400 Lomitas Ave.,
City of Industry, CA 91746 U.S.A.
Telex: 691226 WESTWOOD COLD
Phone: (818) 336-5707

Manufactured by
SHIMPO INDUSTRIAL CO., LTD.
Kyoto, JAPAN

PRINTED IN JAPAN I-841001000