

SECTION A-A

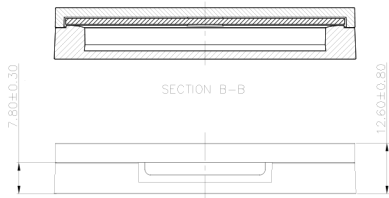
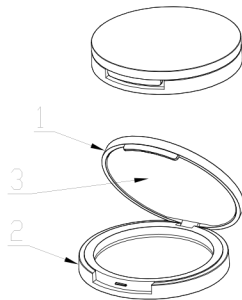

SECTION B-B

GEL TOL:  $\pm 0.20$

Part	Parts Name	Material	Weight
3	MIRROR	Glass	14.0g
2	BASE	AS/ABS+AS	16.5g
1	COVER	AS/ABS+AS	11.4g

PRODUCT CODE: EHSTD60MUCPT

SCALE: 1:1

PRODUCT: COMPACT

DATE: 9/17/19

DOC TYPE: TECHNICAL DRAWING

REVISION: R2

These drawings and specifications are the property of Instockpack and shall not be copied, reproduced, or used in any manner without the prior consent of Instockpack.

**instockpack.**

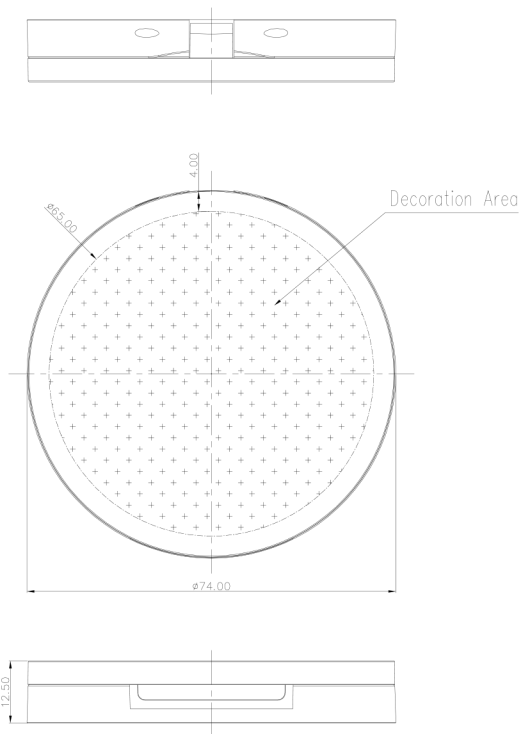

Logo Normal size  
For Reference:



PRODUCT CODE: EHSTD60MUCPT	SCALE: 1:1
PRODUCT: COMPACT	DATE: 9/17/19
DOC TYPE: PRINT AREA	REVISION: R2

These drawings and specifications are the property of Instockpack and shall not be copied, reproduced, or used in any manner without the prior consent of Instockpack.

