

DIMENSIONS

Ø 7,5 cm x H 8,5 cm
Ø 3.0 in x H 3.3 in

PACKAGING

1 Box
10 cm x 10 cm x 13 cm
3.9 in x 3.9 in x 5.1 in

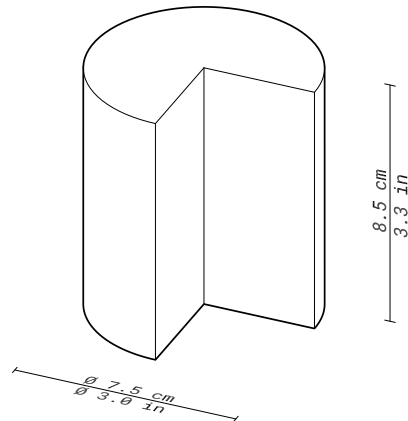

BRASS POLISHED



STEEL POLISHED

DIMENSIONS

Ø 7,5 cm x H 10,0 cm
Ø 3.0 in x H 3.9 in

PACKAGING

1 Box
10 cm x 10 cm x 13 cm
3.9 in x 3.9 in x 5.1 in

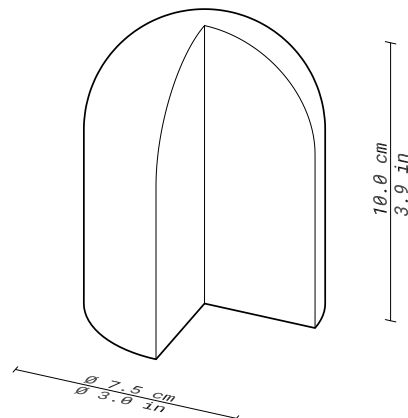

DIMENSIONS

Ø 7,5 cm x H 11,0 cm
Ø 3.0 in x H 4.3 in

PACKAGING

1 Box
10 cm x 10 cm x 13 cm
3.9 in x 3.9 in x 5.1 in

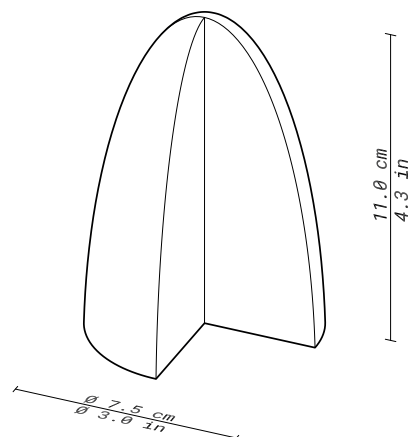

PRODUCT

NOOK bookends offer a simple, refined way to keep your books upright. Crafted from solid brass or steel, they are as sturdy as they are elegant. Each of the three shapes features a subtle cut-out corner, giving your books the perfect nook to lean into. Heavy, stable, and built to last.

MATERIALITY AND SURFACES

- Solid brass, polished
- Solid stainless steel, polished

dieter rams

the
complete
works

ALBERTINA

ERWIN MORA

HIRMER

