



SERVICE MANUAL

600 // INDUCTION HOB - TOUCH TIT63E

DISCLAIMER // THE INFORMATION CONTAINED IN THIS SERVICE MANUAL IS INTENDED FOR LICENSED PERSONNEL ONLY. PLEASE CONTACT ARISIT FOR FUTHER INFORMATION.
[AUSTRALIA] 1300 762 219 [NEW ZEALAND] 09 306 1020



Version 1.0



www.tisira.com

Exploded View

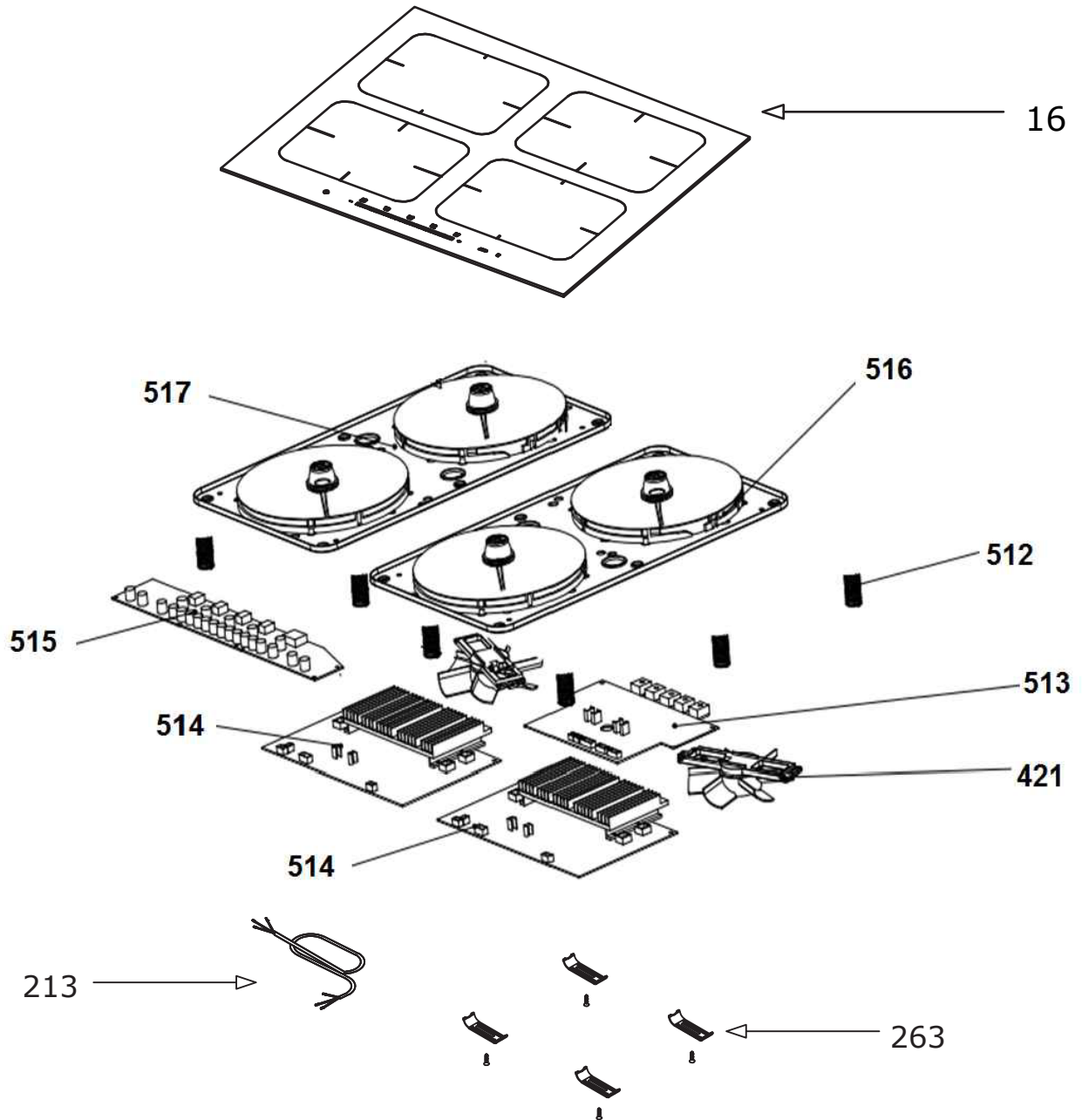

Parts List

ID	Part Number	Factory ID	Description
421	5291919	H35-30-340-033	Cooling Fan
263 + VD	5291928	H25-70-140-201 H60-10-240-015	Installation Bracket + Screws - Induction Hob
213	5291520	H35-10-200-001	Flexible Power cord
513	5291517	H35-30-480-017	Filter Board
514	5291515	H35-30-480-018	Power Board
515	5291516	H35-30-480-021	Touch Display Board
516	5291518	H35-30-480-024	Right Zones Assembly - Induction
517	5291519	H35-30-480-025	Left Zones Assembly - Induction
16	5291802	YOA60-12SC-041-097	Tisira Glass Assembly - Induction Hob 600mm



Wiring Diagram

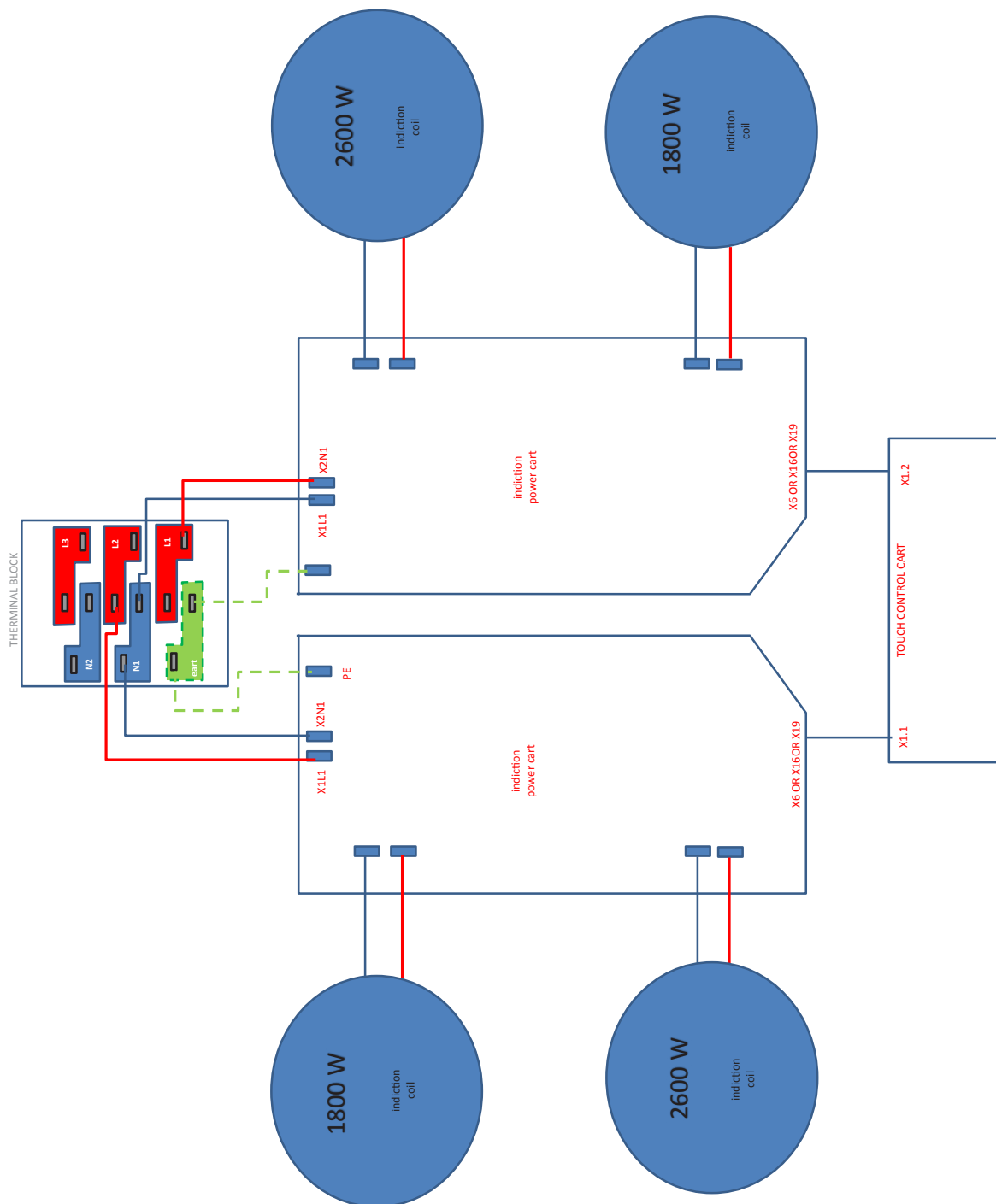

CONTACT DETAILS

AUSTRALIA

ARISIT PTY LIMITED

40-44 Mark Anthony Drive,
Dandenong South, VIC 3175,
Australia

P // 1300 762 219

F // 03 9768 0838

consumer.care@arisit.com

NEW ZEALAND

ARISIT PTY LIMITED

PO Box 68-140
Newton, Auckland 1145,
New Zealand

P // 09 306 1020

F // 09 302 0077

sales@aristonappliances.co.nz

Tisira is committed to ongoing research and development. Every effort has been made to ensure all information in this service manual is correct at time of going to print. Dimensions should be used as a reference only and actual dimensions should be taken from the physical product only.

Manufacturer reserves the right to change specifications without notice.



www.tisira.com