



SERVICE MANUAL

600 // INDUCTION HOB - SLIDE

TIS60B

DISCLAIMER // THE INFORMATION CONTAINED IN THIS SERVICE MANUAL IS INTENDED FOR LICENSED PERSONNEL ONLY. PLEASE CONTACT ARISIT FOR FUTHER INFORMATION [AUST] 1300 762 219 [NEW ZEALAND] 09 306 1020



Version 4.1



www.tisira.com

Exploded View

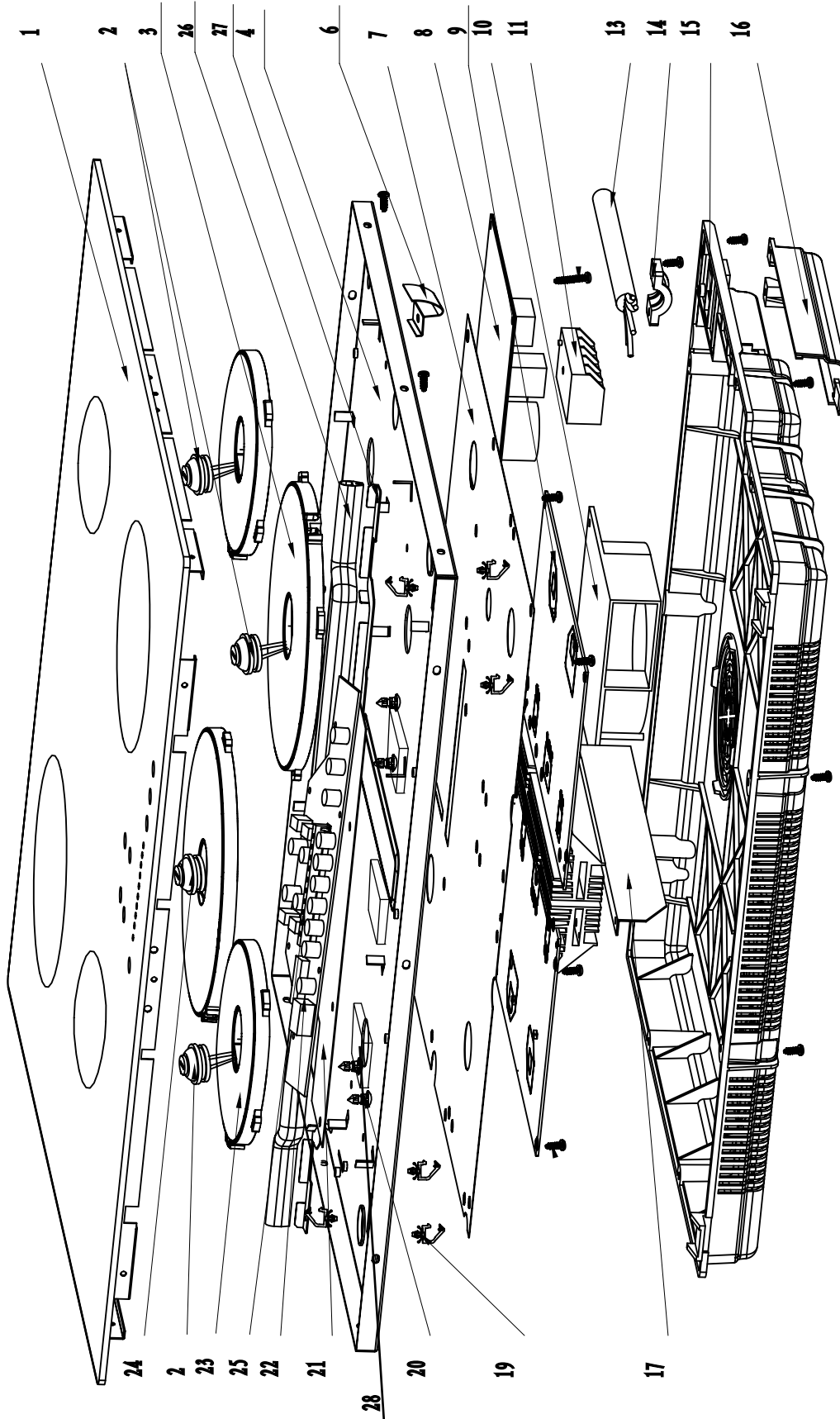

Parts List

ID	PART NUMBER	DESCRIPTION
1	G-TIS60B	Glass Assembly
2 / 24	541600200011	Ceramic Plate Temperature Sensor 275mm (3-pin connector)
	**17466000000194	**Ceramic Plate Temperature Sensor 275mm (2-pin connector)
3	303203501131	Hot Plate (220) 2300/2600W 220-240V
4	541400300009	Radiator Board
6	541410500003	Bracket
7	541700300005	Insulation Panel (B)
8	541500200005	Accessory Power
9	541500000047	Power Board (3-pin connector)
	**17166000000239	**Power Board (2-pin connector)
10	541600100004	Cooling Fan
11	541810000001	Junction Port Holder
13	541800000017	Power Cord
14	303207300213	Fixed Board (Power Wire Clamp)
15	541300100005	Base
16	541300600009	Power Cord Case Cover
17	303207300215	Insulating Panel
19	303207300212	Wire Clamp
20	303207300211	Knighthead (Board Clip)
21	541700300021	Insulation Panel (A)
22	541500100036	Display Board
23	542300300004	Hot Plate (140) 1200/1500W 220-240V
25	541300600005	LED Cover
26	541700200008	Silicone Seal
27	541400200015	Heat Insulating Bracket
28	541700700001	Supporting Foam

** The power board design was amended in 2014:

Old part number: 541500000047 (3-pin connector)

New part number:

17166000000239 is suitable from serial numbers MA-04440-XXXXX (Feb 2015).

NOTE 1: These two power boards are not interchangeable. (3 and 2-pin connectors)

NOTE 2: The change from a 3 to a 2-pin connector also affects one of the Temperature Sensors (541600200011). Please refer to codes listed in the table above. Items 2/24.

Wiring Diagram

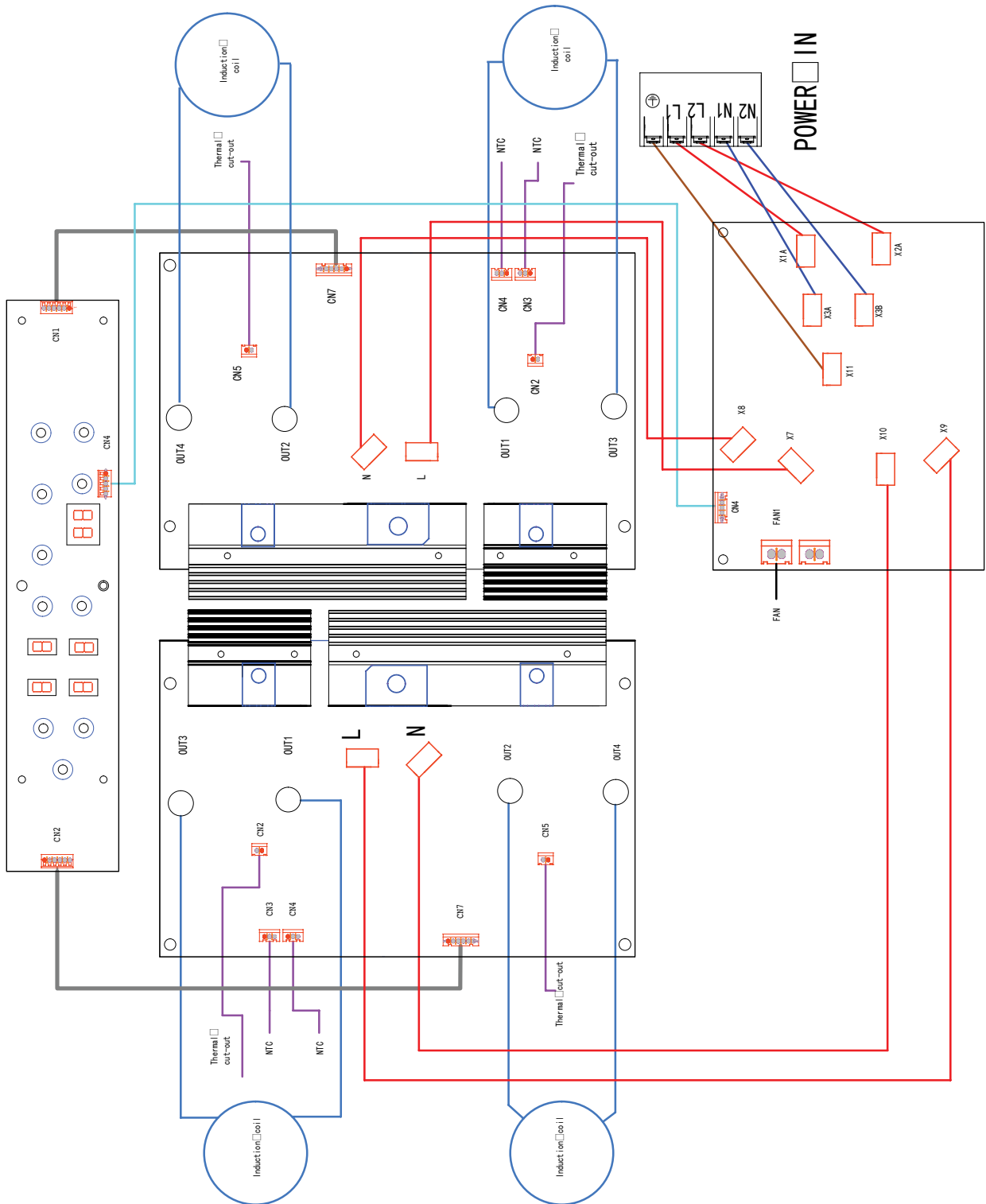

Error Codes

When a common malfunction occurs, the appliance displays error codes to direct you to the possible cause of the problem. Please refer to the following table:

Codes	Description	Possible Solutions
F3 - F8	Temperature Sensor Failure	<ul style="list-style-type: none"> • If the connections, wiring and connectors have been checked, replace the temperature sensor; • If the problem persists, replace the relevant main board.
F9 or FA - FE	Temperature sensor of the IGBT failure	<ul style="list-style-type: none"> • Replace the relevant main board.
FC	Problems with the connection between the display board and the main board	<ul style="list-style-type: none"> • Replace the display board first and if the problem persists, replace the relevant main board.
E1/E2	Abnormal supply voltage	<ul style="list-style-type: none"> • Check if the flexible power supply is damaged; • Check if the power connection of the power board and main boards are properly connected; • Disconnect the left and right main boards separately to identify if one of them is the cause of the error code. Replace the relevant main board if the problem disappears when one of the boards is disconnected; • If the problem persists, replace the power board.
E3/E4	Glass plate temperature is high	<ul style="list-style-type: none"> • Check if the error still occurs after the cooktop has cooled down; • If the problem persists, replace the temperature sensor of the zone that was being used; • If the problem still occurs, replace the relevant main board.
E5/E6	Temperature sensor of the IGBT is high	<ul style="list-style-type: none"> • Check if the error still occurs after the cooktop has cooled down; • If the problem still occurs, replace the relevant main board.

Common Scenarios

When a malfunction occurs and the cooktop doesn't display any error codes, please refer to the most common scenarios and their possible solutions listed in the table below:

Problem	Possible Cause	Possible Solutions
The cooktop doesn't turn ON	No power.	<ul style="list-style-type: none"> • Check the electrical installation (hardwired); • Replace the display board; • If the problem persists, replace the power board.
	Bad connection between Accessory Power and Display Boards	<ul style="list-style-type: none"> • Check connectors and wires. • If that is not the case, replace the Accessory Power Board
	Display Board is damaged	<ul style="list-style-type: none"> • Replace the display board.
Unresponsive touch controls	Damaged display board or low voltage being supplied to the display board	<ul style="list-style-type: none"> • Replace the display board; • If the problem persists, replace the power board.
The cooking mode indicator comes on, but the cooking zone does not start	Glass plate temperature is high	<ul style="list-style-type: none"> • High ambient temperature or air intake/air vent is blocked
	Faulty Fan	<ul style="list-style-type: none"> • Check if the fan is running normally. • If not, replace the fan.
	Damaged Power Board	<ul style="list-style-type: none"> • Replace the power board.
Touch controls work intermittently	Buttons are not touching the bottom surface of the glass or the display board is damaged	<ul style="list-style-type: none"> • Check if the buttons are tilted or misaligned and if they are being correctly supported by springs. • If that is not the case, replace the display board.
Two zones on the same side of the cooktop (front and rear) don't work and display shows "U"	Bad connection between display board as respective power board	<ul style="list-style-type: none"> • Check the connection
	Damaged display board	<ul style="list-style-type: none"> • Replace the display board
	Damaged power board	<ul style="list-style-type: none"> • Replace the power board



CONTACT DETAILS

AUSTRALIA
ARISIT PTY LIMITED

40-44 Mark Anthony Drive,
Dandenong South, VIC 3175,
Australia

P // 1300 762 219
F // 03 9768 0838
consumer.care@arisit.com

NEW ZEALAND
ARISIT PTY LIMITED

PO Box 68-140
Newton, Auckland 1145,
New Zealand

P // 09 306 1020
F // 09 302 0077
sales@aristonappliances.co.nz

Tisira is committed to ongoing research and development. Every effort has been made to ensure all information in this service manual is correct at time of going to print. Dimensions should be used as a reference only and actual dimensions should be taken from the physical product only.

Manufacturer reserves the right to change specifications without notice.

 **tisira**



www.tisira.com