



SERVICE MANUAL

900 // GAS HOB

TGWF91

DISCLAIMER // THE INFORMATION CONTAINED IN THIS SERVICE MANUAL IS INTENDED FOR LICENSED PERSONNEL ONLY. PLEASE CONTACT ARISIT FOR FUTHER INFORMATION.
[AUSTRALIA] 1300 762 219 [NEW ZEALAND] 09 306 1020



tisira

Version 1.4



www.tisira.com

Exploded View

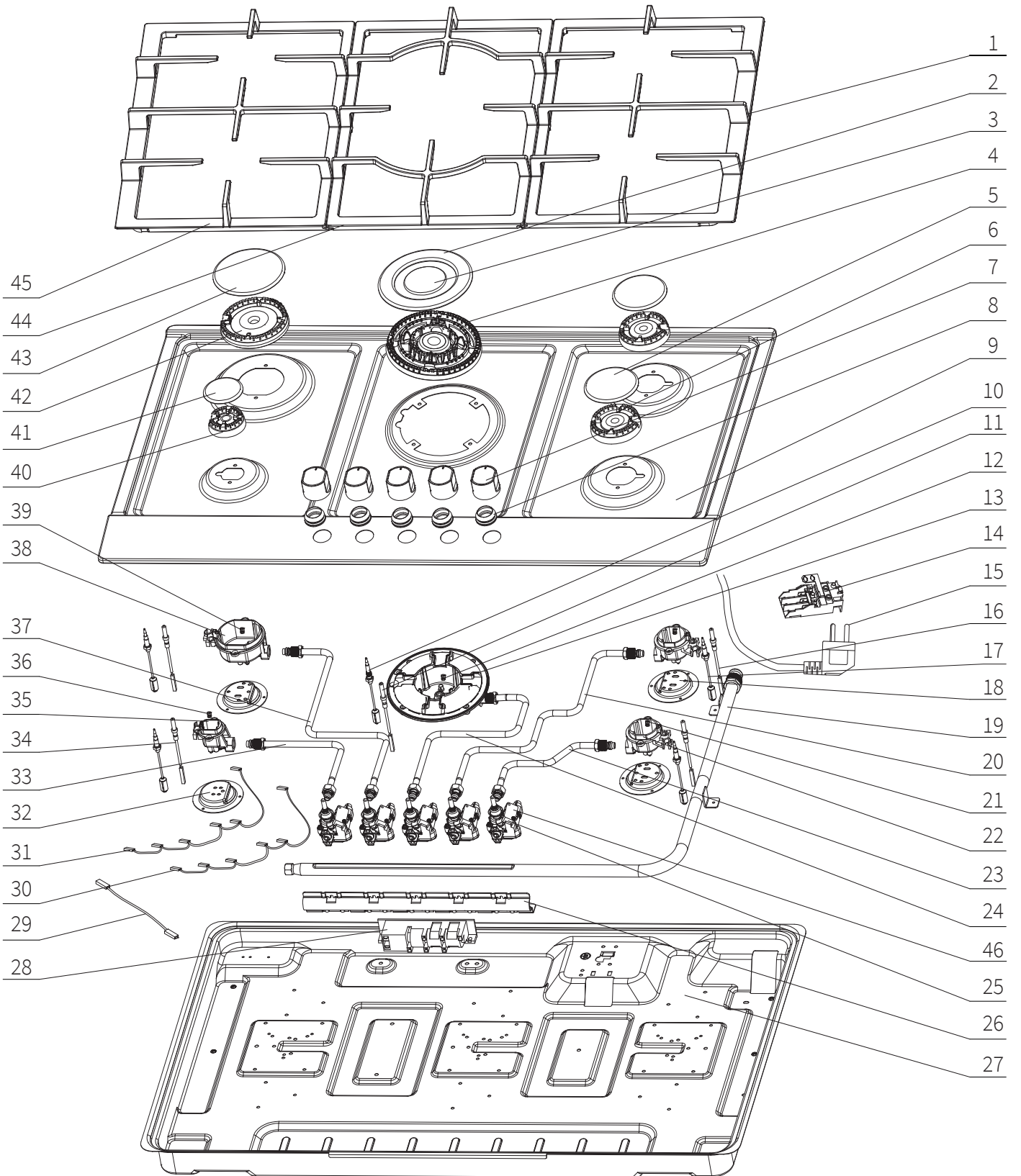

Parts List

ID	Part Number	Description
1	2299315	Right trivet (900mm)
3	2299328	Wok inner burner cap
2	2299327	Wok outer burner cap
4	2299329	Wok burner diffuser
5	2299321	Semi-rapid burner cap
6	2299322	Semi-rapid burner diffuser
7	2299407	Knob - Brushed silver
8	2299403	Gasket - top plate knob cutouts
9	2206102	Top plate - stainless steel (Tisira)
10	2299516	Thermocouple FFD - wok burner
11	2299519	Ignition candle - wok burner
12	2299652	Gas injector Ø 1.72 - wok burner
13	2299330	Wok burner cup (base)
14	2299513	Electrical terminal block
15	2299512	Flexible power cord - AUS 10A
16,34	2299527	Ignition candle - rapid, semi-rapid & aux. burners (850mm)
17	2299524	Thermocouple FFD - rapid, semi-rapid and aux. burners (650mm)
18	2299103	Burner cup support - rapid & semi-rapid
19	2299615	Gas Inlet manifold
20	2299616	Gas pipe - rear right semi-rapid burner
21	2299651	Gas injector Ø 1.15 - semi-rapid burner
22	2299323	Semi-rapid burner cup (base)
23	2299617	Gas pipe - front right semi-rapid burner
24	2299618	Gas pipe - wok burner
25,46	2299600	Gas valve, FFD - aux. burner & ignition switch
25,46	2299601	Gas valve, FFD - semi-rapid burner & ignition switch
25,46	2299602	Gas valve, FFD - rapid burner & ignition switch
25,46	2299603	Gas valve, FFD - wok burner & ignition switch
26	2299105	Bracket for gas valves
27	2299106	Bottom plate
28	2299520	Ignition generator - 5 points
29	2299507	Connection wire
30	2299521	Wire for microswitches 1
31	2299522	Wire for microswitches 2
32	2299104	Burner cup support - aux.
33	2299619	Gas pipe - front left aux. burner
35	2299320	Aux. burner cup (base)
36	2299621	Gas injector Ø 0.85 - aux. burner

Parts List

ID	Part Number	Description
37	2299620	Gas pipe - rear left rapid burner
38	2299326	Rapid burner cup (base)
39	2299613	Gas injector Ø 1.50 - rapid burner
40	2299319	Aux. burner diffuser
41	2299318	Aux. burner cap
42	2299325	Rapid burner diffuser
43	2299324	Rapid burner cap
44	2299317	Central trivet
45	2299316	Left trivet (900mm)
ULPG Kit	2299634	Gas injector Ø 0.72 - semi-rapid burner
	2299657	Gas injector Ø 0.93 - rapid burner (& aux burner)
	2299636	Gas injector Ø 1.04 - wok burner
	2299629	Gas injector Ø 0.53 - aux. burner
	2299638	Test point - gas pressure
-	2299637	Gas regulator - Laite
-	2299078	Wok Support Trivet - Ring
-	2299639	Elbow - gas fitting
-	2299107	Mounting bracket
-	2299917	Rubber Foot

Consumption Table

TGWF91	Natural Gas			Universal LPG		
	Inj. diam. (mm)	MJ/h	Gas pressure	Inj. diam. (mm)	MJ/h	Gas pressure
Wok burner x 1	1.72	13.68	1.0kPa	1.04	13.68	2.75kPa
Rapid burner x 1	1.50	10.80	1.0kPa	0.93	10.80	2.75kPa
Semi-rapid burner x 2	1.15	6.30	1.0kPa	0.72	6.30	2.75kPa
Auxiliary burner x 1	0.85	3.60	1.0kPa	0.53	3.60	2.75kPa
Total NHGC	40.68			40.68		



Wiring Diagram

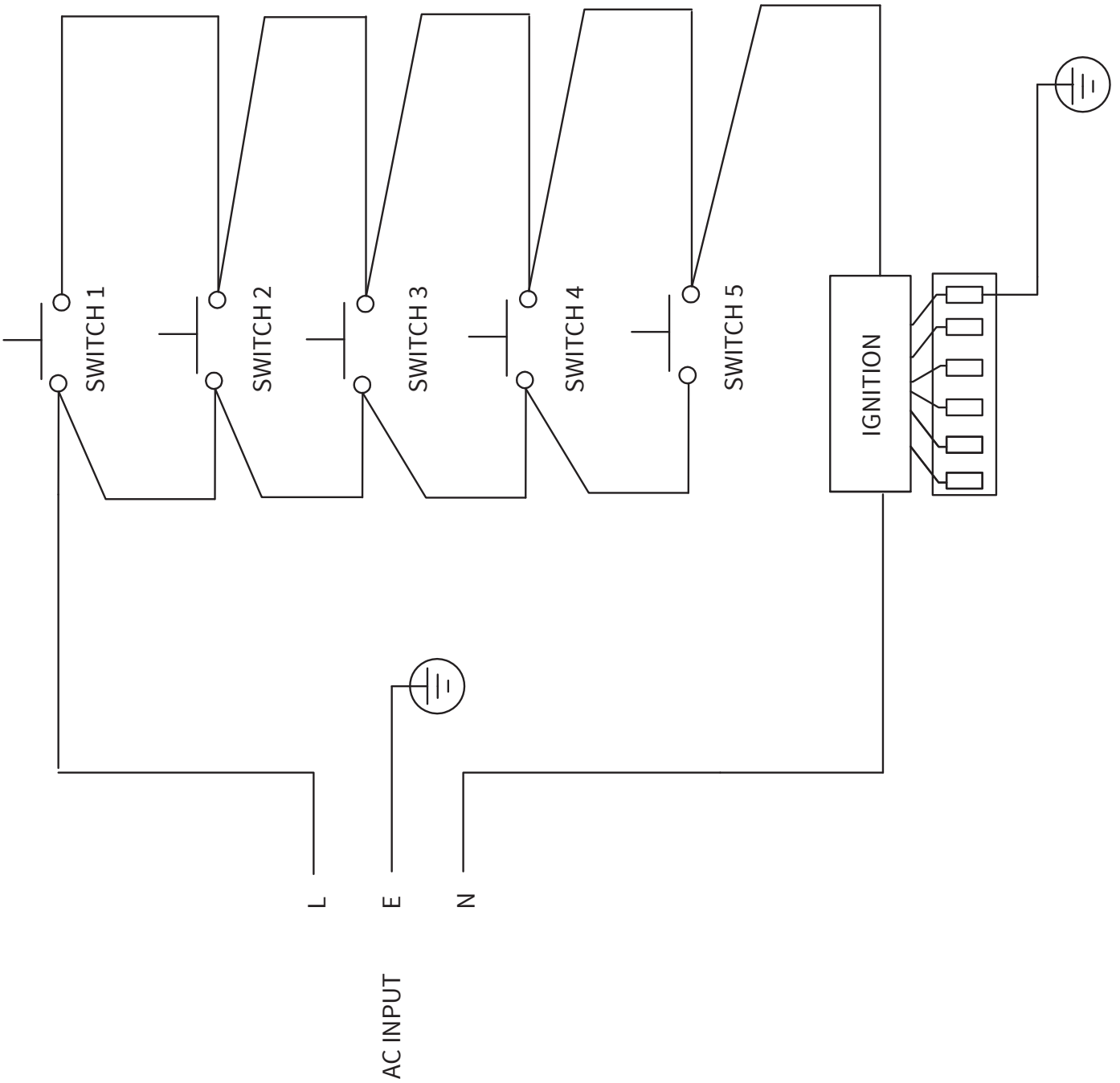

CONTACT DETAILS

AUSTRALIA

ARISIT PTY LIMITED

40-44 Mark Anthony Drive,
Dandenong South, VIC 3175,
Australia

P // 1300 762 219

F // 03 9768 0838

consumer.care@arisit.com

NEW ZEALAND

ARISIT PTY LIMITED

PO Box 68-140
Newton, Auckland 1145,
New Zealand

P // 09 306 1020

F // 09 302 0077

sales@aristonappliances.co.nz

Tisira is committed to ongoing research and development. Every effort has been made to ensure all information in this service manual is correct at time of going to print. Dimensions should be used as a reference only and actual dimensions should be taken from the physical product only.

Manufacturer reserves the right to change specifications without notice.



www.tisira.com