



Electrolux

ELECTROLUX HOME PRODUCTS PTY LTD

ABN 51 004 762 341

Technical Publication N° RH1052

Issue: 1

Date: 2/20

PARTS & VIEWS

Westinghouse

Canopy Rangehood

MODEL

WRC924SC

PNC

942022472 00

MAINTENANCE LEVEL CHANGE SUMMARY

ML	Description	Product Release Date
00	First release.	03/20

MODEL NUMBER IDENTIFICATION

FREE-STANDING COOKERS										
W Brand	B Construction	E Oven Fuel Type	S Added Features	# Width	# Hob Type	# Specification Level	W Colour	A Series	R Side Opening Door Type	G Gas Type
W = Westinghouse C = Chef E = Electrolux Z = Zanussi S = Simpson	E = Elevated Cooker F = Front Control Freestanding Cooker L = Rear Control Freestanding Cooker	E = Electric G = Gas	Leave blank for all except the below: S = Side Opening Door P = Pyro	5 = 60 - 64cm 6 = 60 - 66cm 7 = 70 - 76cm 8 = 80 - 86cm 9 = 90 - 96cm 1 = 100cm and above	IF FUEL TYPE = G 0 = No wok 1 = Wok 2 3 4 5 6 7 8 9 = Highest Spec IF FUEL TYPE = E 2 = Radiant Coil 3 = Solid 4 = Ceramic 5 = Induction 6 = Dual fuel	Even = GIO, Odd = Sep Grill 0 = Lowest Spec 1 2 3 4 5 6 7 8 9 = Highest Spec	W = White S = Stainless Steel B = Black	A = SAFR B = 1st series change C = 2nd series change etc	L = Left Hand Opening R = Right Hand Opening	LP = Liquefied Petroleum NG = Natural Gas
BUILT-IN OVENS										
W Brand	B Construction	E Oven Fuel Type	S Added Features	# Width	# Cavity Type	# Specification Level	W Colour	A Series	G Gas Type	R Side Opening Door Type
W = Westinghouse C = Chef E = Electrolux Z = Zanussi S = Simpson	V = Built-in oven	E = Electric G = Gas	Leave blank for all except the below: S = Side Opening Door M = Microwave P = Pyro	3 = 30cm - 36cm 4 = 40cm - 46cm 5 = 50cm - 56cm 6 = 60cm - 66cm 7 = 70cm - 76cm 8 = 80cm - 86cm 9 = 90cm - 96cm 1 = 100cm - 110cm 2 = 120 cm +	1 = Single 2 = Duo 3 = Double 4 = Combo Oven 5 = Sep grill and bench 6 = Sep grill wall oven 7 = Compact 8 9 = Highest Spec	0 = Lowest Spec 1 2 3 4 5 6 7 8 9 = Highest Spec	W = White S = Stainless Steel B = Black	A = SAFR B = 1st series change C = 2nd series change etc	LP = Liquefied Petroleum NG = Natural Gas	L = Left Hand Opening R = Right Hand Opening
BUILT-IN HOBS										
W Brand	B Construction	# Hob Type	# Width	# No. Burners/Zones	# Specification Level	W Colour	A Series			
W = Westinghouse C = Chef E = Electrolux Z = Zanussi S = Simpson	H = Hob	IF ELECTRIC HOB: S = Solid C = Ceramic I = Induction R = Radiant Coil M = Mix IF GAS HOB: G = Gas D = Dual Fuel	3 = 36cm or below 4 = 40cm - 46cm 5 = 50cm - 56cm 6 = 60cm - 66cm 7 = 70cm - 76cm 8 = 80cm - 86cm 9 = 90cm - 96cm 1 = 100cm - 110cm 2 = 120 cm and above	1 2 3 4 5 6 7 8 9	0 = Lowest Spec 1 2 3 4 5 6 7 8 9 = Highest Spec	W = White S = Stainless Steel B = Black	A = SAFR B = 1st series change C = 2nd series change etc			

CONTENTS

MAINTENANCE LEVEL CHANGE SUMMARY	2
MODEL NUMBER IDENTIFICATION.....	2

EXPLODED VIEWS & PARTS LISTS

MODEL: WRC924SC	4
EXPLODED VIEW	4
MODEL: WRC924SC	6
CIRCUIT DIAGRAM.....	6

NOTE: In Parts Listings

N.I.	=	Not Illustrated
N.P.A.	=	No Part Available
N.P.N.	=	Not Used on this Model

MODEL: WRC924SC

EXPLODED VIEW

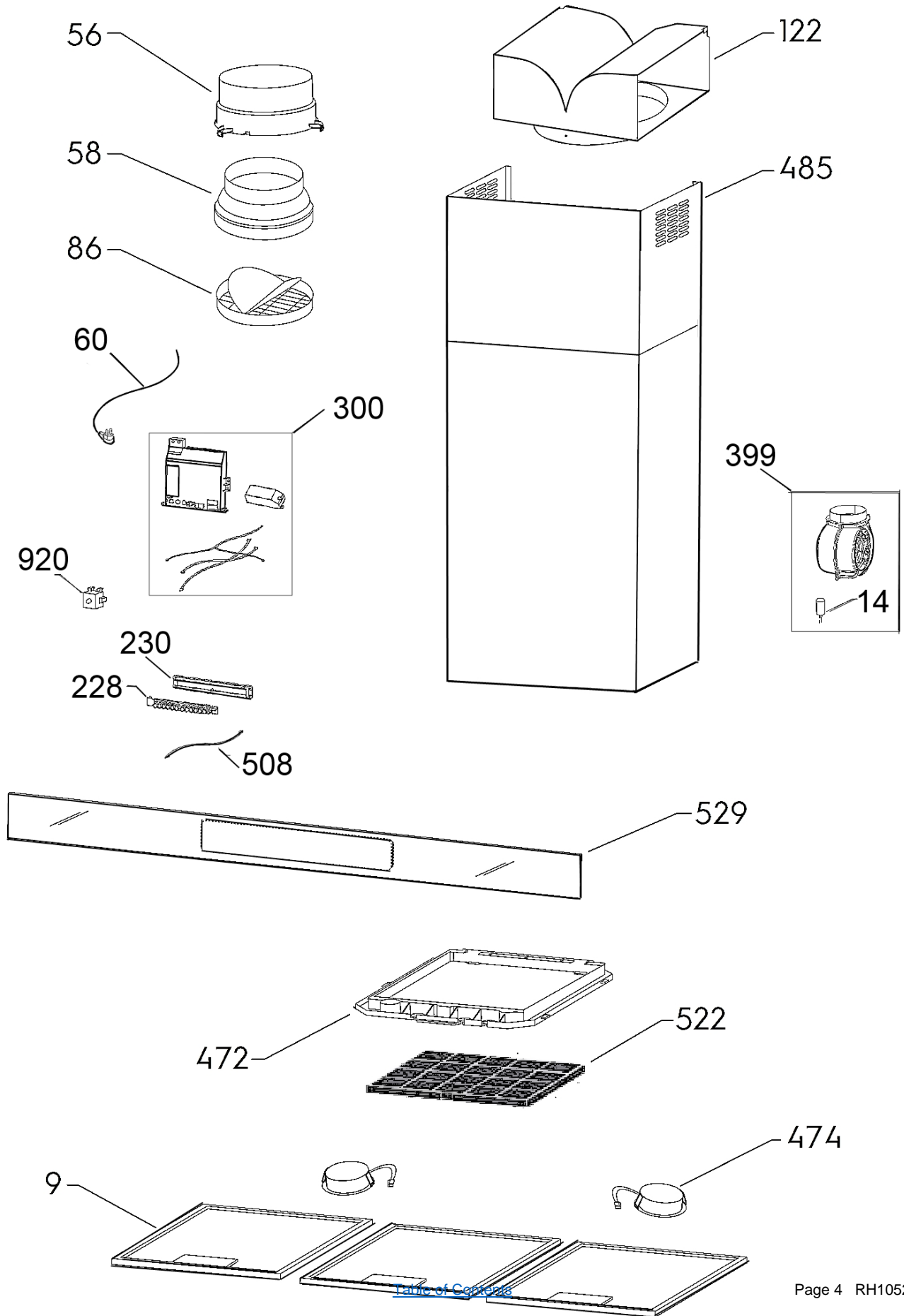

ITEM	PART No.	DESCRIPTION	QTY
9	80877665	FAT FILTER, 343, 5x285mm	3
14	023203862	CAPACITOR, 5uf 425/475V 10000H	
56	32931412	AIR OUTLET, CONNECTOR, d150mm	1
58	32920993	VALVE, REDUCTION,150/125mm	1
60	23001282	POWER CABLE, AUS 3, 75 1, 6 CL1	
86	80883622	FLANGE, WITH NON-RETURN VALVE, d150mm	1
122	32933616	DEFLECTOR	1
228	4055487609	USER INTERFACE BOARD	1
230	32933863	COVER, CONTROL PANEL	1
300	61435301	ASSEMBLY, INSTALLATION, ELECTRIC, HALOGEN	1
399	60023140	ASSEMBLY, MOTOR, 265W	1
472	32932204	BRACKET, PLASTIC, 240x196	1
474	23203870	LED, LAMP, 2, 1W 3V 700MA	2
485	80170160	CHIMNEY, COMPLETE	1
508	23010754	FLAT CABLE	1
522	33005299	CARBON FILTER, 240x193x10 141 5x4A	1
522	33005521	CARBON FILTER, 240x193x10 TYPE 5x4a	1
529	80943970	GLASS PANEL, USER INTERFACE BOARD, BETAGLASS	1
920	61028031	SENSOR, ASSEMBLY, BLACK, H2H PASSIVE	1
N.I.	43021757	DRILL TEMPLATE	1
N.I.	808110613	SET, FITTINGS	1
N.I.	32932220	COVER, CONNECTOR,BLOWER, 6PIN FEMALE	1

MODEL: WRC924SC

CIRCUIT DIAGRAM

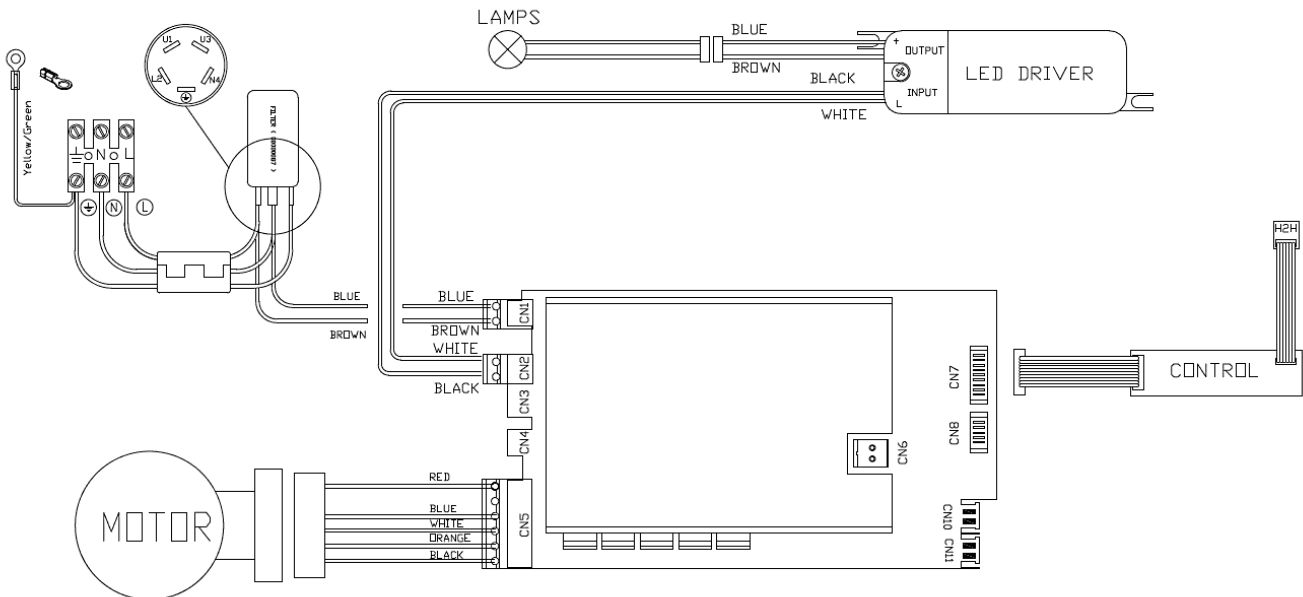

WARNING

IT IS ILLEGAL FOR PERSONS OTHER THAN LICENSED ELECTRICAL MECHANICS OR PERSONS AUTHORISED BY LEGISLATION TO WORK ON THE FIXED WIRING OF ANY ELECTRICAL INSTALLATION. PENALTIES FOR CONVICTION ARE SEVERE.

IMPORTANT SAFETY NOTICE

This diagram has been prepared for use by electrically qualified service technicians. Electrolux cannot be held responsible for the interpretation of its service publications nor for any injury or damage that may occur in connection with their use.

Publication Version Control Chart		
Issue Number	Reason	Date
1	Original Document	03-02-2020