

Platinum.™

Service Manual

600 Ceramic Cooktop Touch

AUPL-VCR4T

DISCLAIMER

The information contained in this Service Manual is intended for licensed service personnel only.

Exploded View

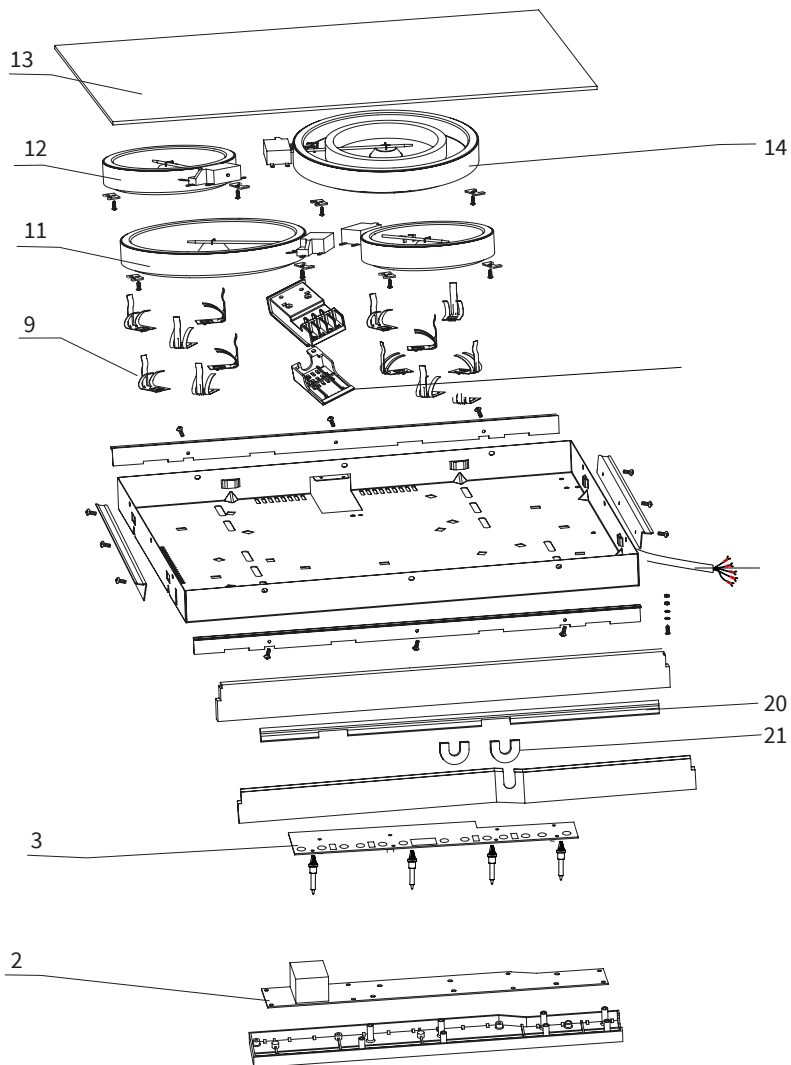

Parts List

ID	Part Number	Description
2	2299544	Main PCB Assembly
2**	2299558**	**Main PCB Assembly
3	2299545	Display / Touch Control Board Assembly
3**	2299559**	**Display / Touch Control Board Assembly
9	2299110	Spring clip for hot plate
11	2299536	Left Front Hot Plate
12	2299546	Left Rear Hot Plate / Right Front Hot Plate
13	2201104	Ceramic Glass Assembly
14	2299547	Right Rear Hot Plate
20	2299903	Silicone Heat Insulator
21	2299904	Silicone Gasket

****NOTE:** New PCBs were adopted from Product Serial Number MD-07653-00XXX.

Main PCB Assmebly (2299544 > 2299558*)

Display / Touch Control Board Assembly (2299545 > 2299559*)

These new boards* are not individually suitable for hobs with previous serial numbers and vice versa.

However, if these two boards are replaced as a pair, they are suitable for all generations of cookotps.

Please refer to relevant wiring diagram in the following pages.

Wiring Diagram

up to S/N MD-07653-00XXX

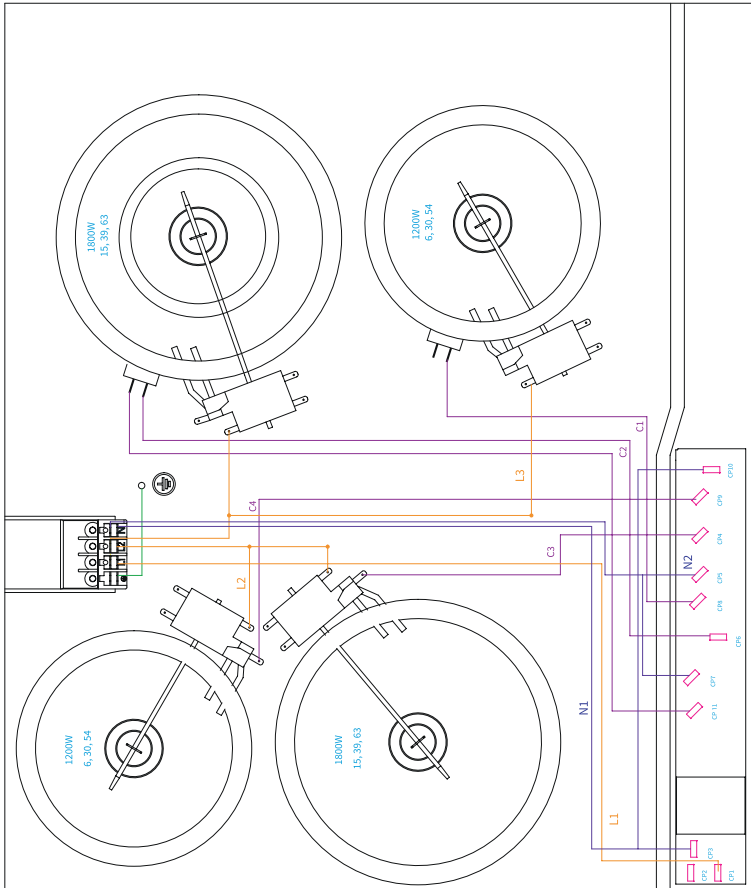
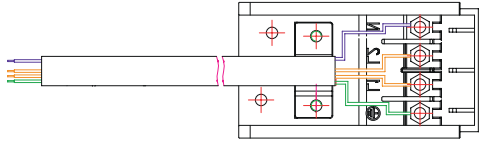
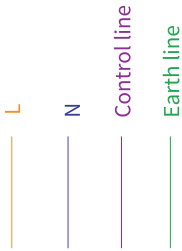

2299544 - Main PCB

from S/N MD-07653-00XXX

Wiring Diagram

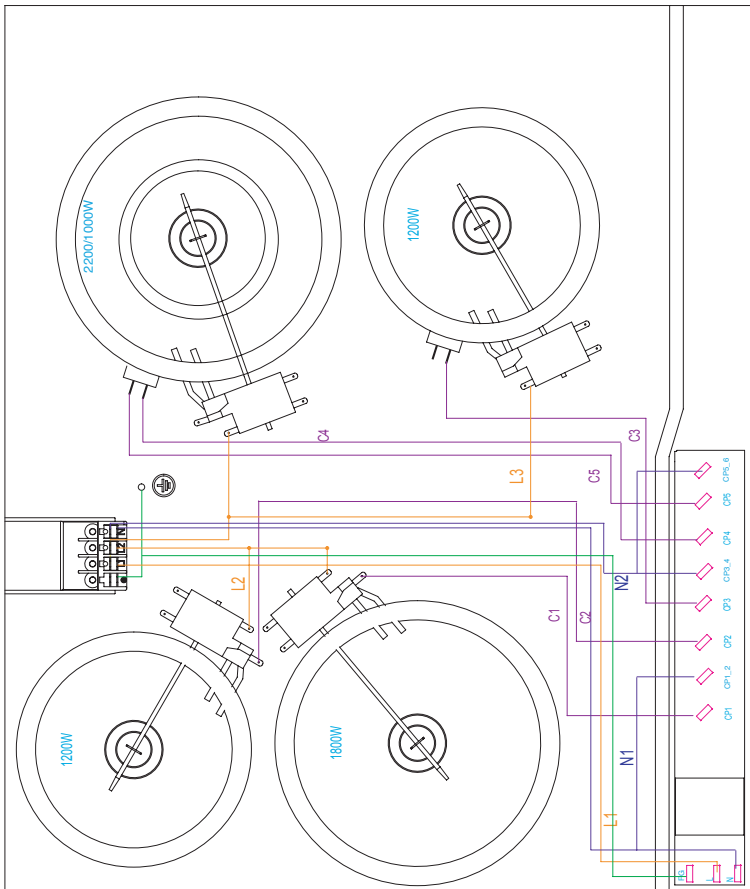
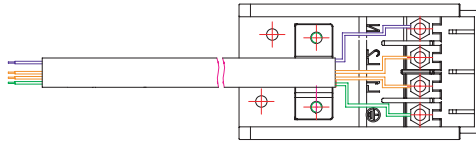
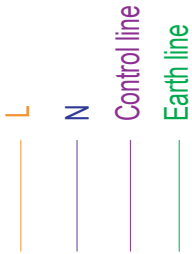

2299558 - Main PCB (current)

Platinum.™

CONTACT DETAILS

Australia

Platinum Appliances

 PO Box 7785
Baulkham Hills BC
NSW 1755

 1300 985 815

 customercare@platinumappliances.com.au

 platinumappliances.com.au

Platinum is committed to ongoing research and development. Every effort has been made to ensure all information in this service manual is correct at time of going to print. Dimensions should only be used as reference only and actual dimensions should be taken from the physical product only.

Manufacturers reserves the right to change specifications without notice.

Version 5.0

| platinumappliances.com.au