



USER INSTRUCTIONS



Before performing any steps, all ammunition must be removed from the firearms. Remove the magazine from the firearm. Fully pull the slide or bolt group to eject the round from the chamber. Visually inspect through the ejection port to verify that no ammunition is in the chamber. Always keep the muzzle pointed in a safe direction. Without performing this safety precaution may cause serious injury or death to persons. MECHFORCE is not liable for any damage or injury sustained through improper installation.

- 1 Remove the four flange nuts and the top plate from the Barrel Vise.
- 2 Remove the top layer of cowhide from the four studs but leave the bottom one on the Barrel Vise.
- 3 Position the barrel or any other tubular that intended to be constrained onto the Barrel Vise. Ensure the barrel sits on top of the groove and above the bottom layer of cowhide.
- 4 Install the top layer of the cowhide through the four studs, then install the top plate and four flange nuts back to the Barrel Vise.
- 5 Torque the four flange nuts snug tight to secure the barrel with the Barrel Vise. Torque the four flange nuts further more if slippage occurs. It is the best practice to follow the order shown in the figure below to achieve a balanced stud tension.

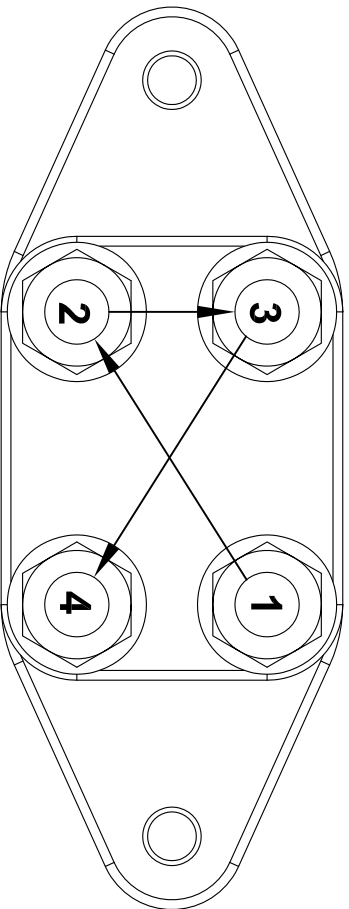

NOTE:

The replacement parts can be purchased at www.Mechforce-USA.com or send purchasing request via email to info@mechforce-usa.com.

VISIT US AT WWW.MECHFORCE-USA.COM
FOR OTHER EXCITING PRODUCTS



PRODUCT SPECIFICATIONS

Product Name: Mechforce Professional Grade Heavy Duty Barrel Vise
Part Number: PN70056

Designed for Barrel Outside Diameter from 0.67" to 1.375"

Materials:

Bodies - Aircraft Grade Aluminum Alloy
Studs and Nuts - Grade 8 High Strength Steel, ASTM A354BD
Leather Inserts - Raw Cowhide, Special Surface Treated

Dimensions: 7.25" L x 2.75" W x 3.25" H

Weight: 2 LB 7 OZ

MADE IN USA

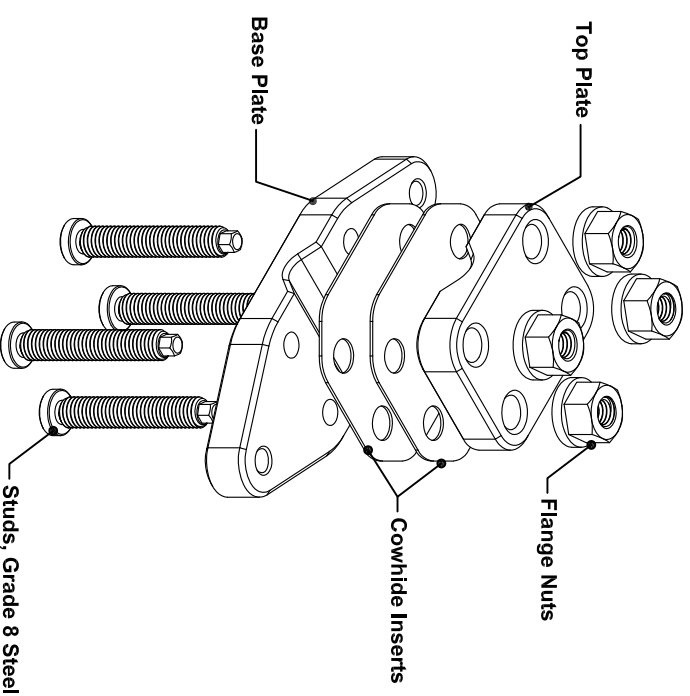

VISIT US AT WWW.MECHFORCE-USA.COM
FOR OTHER EXCITING PRODUCTS