

E

SAFETY INSTRUCTIONS

Thank you for purchasing this product. Please read and follow the instructions carefully and keep this manual for future reference.

- This device is not intended for use by persons (including children) with reduced physical, sensory or mental capabilities, or lack of experience and knowledge, unless they have been given supervision or instruction concerning use of the device by a person responsible for their safety.
- Keep this device out of reach of children. Do not let them play with the device.
- Stop using if the plug or cord is damaged, or the plug fits loosely in the outlet.
- In case of malfunction, get the device repaired by the authorised service centre.
- This device must be earthed. Make sure the mains voltage corresponds to that printed on the rating plate of the device.
- Unplug the device when not in use or before cleaning.

IMPORTANT

- Operate the cooker on a flat surface away from the edge of counter to prevent accidental tipping. Do not let the cooker, base or cord contact any hot surfaces.
- **Warning:** Do not overfill. Never fill the cooker beyond the maximum water level mark. Boiling liquid may be ejected and cause scald or leakage if overfilled.
- **Caution:** Do not operate the cooker without or with insufficient water or soup. Power will be cut OFF if boiled dry. To reset and use again, remove cooker from the base and let it cool down for 10 minutes. Do not fill the cooker until it is cold.
- Beware of hot steam. Do not touch hot surfaces, always use handles and knobs.
- Do not immerse the cooker, base or cord in water, nor wash the entire unit.

PRODUCT OVERVIEW

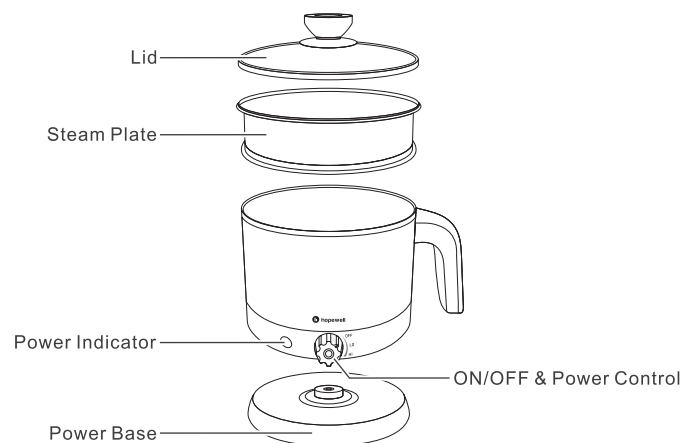

HOW TO OPERATE

Cooking

1. Lift the cooker, then remove the lids
2. Fill the cooker with water and ingredients (do not exceed the " MAX " mark), then put the lid back on.
3. Connect the Power Base to the power outlet, and place the cooker onto the Power Base.
4. Turn the [ON/OFF & Power Control] knob to " LO " or " HI ". Cooker starts cooking, and the Power Indicator turns ON.

Switch Off

Turn the [ON/OFF & Power Control] knob to " OFF " to switch the cooker off. Do not forget to turn it off when cooking is done.

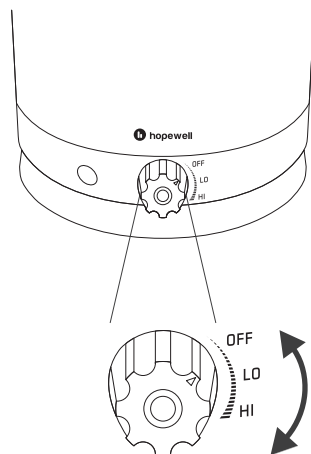

INSTALLING EGG RACK

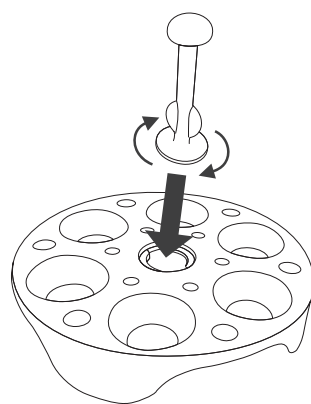

CARE AND CLEANING

NOTES

- Unplug and let the cooker cool down before cleaning.
- Never immerse the cooker, plug or cord in water.
- The electrical connections or switches must not come into contact with water or liquid.



- Wipe dust off the surface of the cooker using a dry, soft cloth. If necessary, use a damp well-wrung cloth containing a few drops of mild detergent to remove persistent stain, then clean and dry.
- Do not use abrasive tools, they will scratch the cooker surface.

DESCALING

Depending on the hardness of water, white small spots may appear on the heating element as scale builds up over time. It is perfectly normal and harmless, but can hinder the cooker performance. To extend cooker's life and save energy, descale regularly (every 1 - 3 months, more often for frequent usage or with hard water).

Using White Vinegar

1. Boil water up to three quarters of the " MAX " indication in the cooker.
2. After water is boiled, add white vinegar (8%) up to the " MAX " indication.
3. Leave the solution in the cooker to soak overnight.
4. Empty the cooker and rinse the inside thoroughly.
5. Boil with clean water, empty the cooker and rinse it with clean water again. Repeat if necessary.

Using Descaler

1. Buy a suitable descaler for kettle. Follow the manufacturer's instruction.
2. Empty the cooker and rinse the inside thoroughly.
3. Boil with clean water, empty the cooker and rinse it with clean water again. Repeat if necessary.

Reducing Scale Build-Up

To reduce scale build-up, fill the cooker with filtered water.

TROUBLESHOOTING

Problem	Possible Cause	Solution
Boiling / cooking does not start.	Heating function has not been powered ON.	Check if the power outlet has been switched ON, and if the [ON/OFF & Power Control] knob has been turned to " LO " or " HI ".
Cooker seems to be leaking.	Cooker is overfilled.	Always keep the water level below the maximum water level mark.
Cooker is boiled dry.	Cooker is empty or filled with insufficient water or soup.	Always fill the cooker with sufficient water or soup before boiling or cooking. Turn the cooker off when cooking is done.
Cooker cannot be switched ON after boiling dry.	Power has been cut off by the dry boil protection function.	Remove the cooker from the base, and let it cool down for 10 minutes. Then the cooker is reset and can be used again.
Heating element is scorched after boiling dry.	Heating element is overheated and burnt as a result of dry boiling.	The scorched heating element will not affect the operation of the cooker and is perfectly safe to use. The scorch marks cannot be removed. Do not boil dry again to avoid any further damage.
Performance of cooker has dropped.	Scales building up on the heating element.	Follow the instruction in the " Descaling " section and descale regularly.