

User Guide

HAP-70



PRODUCT OVERVIEW

1. Microphone
2. Earphone
3. Volume Control Knob
4. Ear Tip
5. ON/OFF Switch
6. Battery Cover

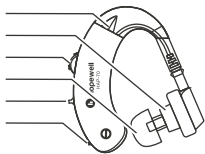

- " N " : Power ON
" O " : Power OFF
" + " : Positive electrode of battery
" - " : Negative electrode of battery
" 0-4 " : Volume (0=min; 4=max)

INSTALLING BATTERY

1. Open the " Battery Cover " .
2. Insert 1 pc AG13 / LR44 battery. Battery must be placed according to the polarities indicated.
3. Close the " Battery Cover " .

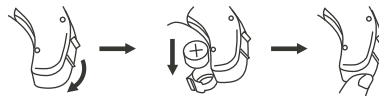

 Remove the battery if the hearing aid is not being used for a long period of time.

HOW TO OPERATE

1. Turn the volume to minimum before use.
2. Insert the hearing aid over the top of your ear.
3. Switch ON the hearing aid. Adjust the volume.

* Choose a correct ear tip size. A whistling sound may occur if the tip is not firmly inserted into your ear.



TROUBLE SHOOTING

In case of no sound, please check the followings:

1. If the volume is turned up;
2. If the battery is inserted correctly;
3. If the battery has run dry;
4. If the earphone is damaged.

MAINTENANCE

Clean your hearing aid regularly:

1. Remove the ear tip.
2. Wipe the hearing aid body with a clean, dry cloth.
3. Soak the ear tip in warm, soapy water. Remove any earwax built-up that may block the passage of the ear tip.
4. Rinse the ear tip with clean water.
5. Allow the ear tip to dry before installing it.

SAFETY INSTRUCTIONS

1. This product is not suitable for patients with tympanitis or ear pyogenesis.
2. Avoid listening at high volume for a long period of time to avoid possible hearing damage.
3. Stop using immediately if you feel any discomfort.
4. Please maintain your hearing aid all the time. Avoid the ear tip and microphone being blocked by foreign objects, as it will affect the result of sound amplification.
5. Avoid shaking or dropping your hearing aid.
6. Do not keep your hearing aid in an environment of high humidity or high temperature.

SPECIFICATIONS

1. Max sound output: 130 ± 5 dB
2. Volume input: ≥ 50 dB
3. Total harmonic distortion: $\leq 5\%$
4. Frequency range: 300 ~ 40000Hz
5. Input noise: ≤ 30 dB
6. Voltage: DC 1.5V
7. Current: ≤ 4 mA

 hopewell / since 1985

hopewell-living.uk

© hopewell. All right reserved. The hopewell logo is a registered trademark of Norm Design Ltd. Information in this document is subject to change without notice.

