

User Guide

HAP-120



CHARGING - FIRST TIME USE

1

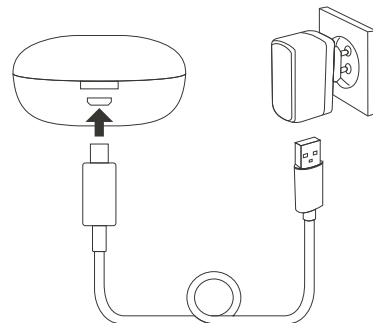

Charge the case and hearing aids using the USB cable connected to a computer or wall charger.

2

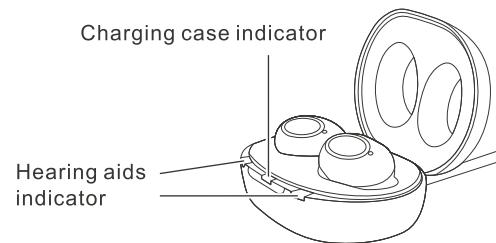

- Indicator turns blue while charging.
- Indicator turns white when fully charged.

TURN ON

3

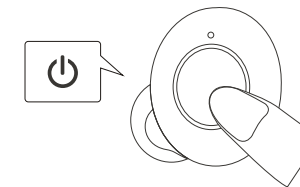

- Remove the hearing aid from the charging case.
- Tap and hold it for 3 seconds to turn it on.
- The indicator turns white, 2 beep sound is heard, and the hearing aid is ready for use.

INSERT HEARING AIDS

4

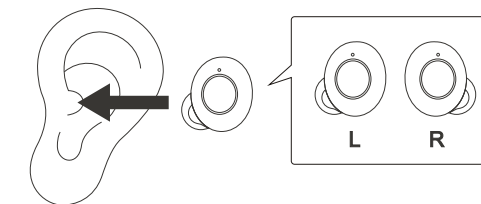

ADJUST VOLUME

5

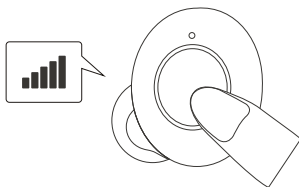

- Tap the hearing aid repeatedly to increase volume.
- 2 beep sound is heard when it reaches the highest volume level (level 6).
- Tap once more and it will return to level 1.

TURN OFF

6

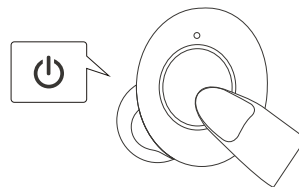

- Tap and hold the hearing aid for 3 seconds to turn it off.
- The indicator turns blue, 2 beep sound is heard, and the hearing aid is turned off.

CHARGING - HEARING AIDS

7

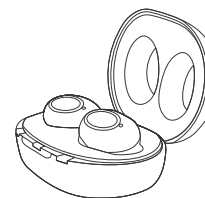

⚠ Turn hearing aids off before charging.

- To charge your hearing aids, place them in the charging case and close the lid.
- A fully charged case provides 4 extra hearing aids charges when on-the-go.

CHARGING - CHARGING CASE

8

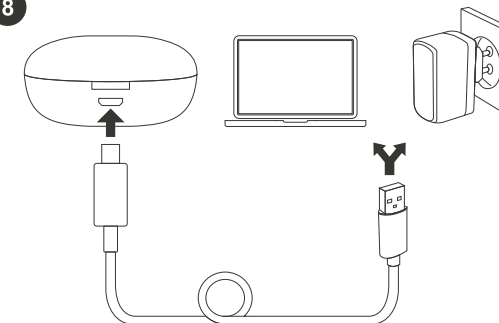

Charge the case using the USB cable connected to a computer or wall charger.

SPECIFICATIONS

Charging Time	
- Charging case	Approx. 2.5 hours
- Hearing aid	Approx. 1.5 hours
Usage Time	Approx. 16 hours

hopewell / since 1985

© hopewell. All right reserved. The hopewell logo is a registered trademark of Norm Design Ltd. Information in this document is subject to change without notice.

hopewell-living.uk

