

Battery-Free Wireless Doorbell
w/ Sensor Nightlight

DN SERIES

User Guide



E

SAFETY INSTRUCTIONS

Thank you for purchasing this product. Please read and follow the instructions carefully and keep this manual for future reference.

- This device is not intended for use by persons (including children) with reduced physical, sensory or mental capabilities, or lack of experience and knowledge, unless they have been given supervision or instruction concerning use of the device by a person responsible for their safety.
- Keep this device out of reach of children. Do not let them play with the device.
- Stop using if the plug or cord is damaged, or the plug fits loosely in the outlet.
- In case of malfunction, get the device repaired by the authorised service centre.
- This device must be earthed. Make sure the mains voltage corresponds to that printed on the rating plate of the device.
- Unplug the device when not in use or before cleaning.

PRODUCT OVERVIEW

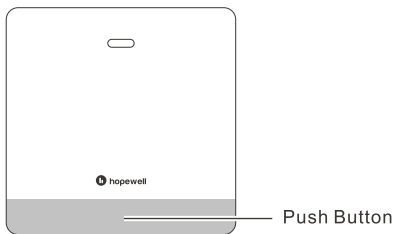
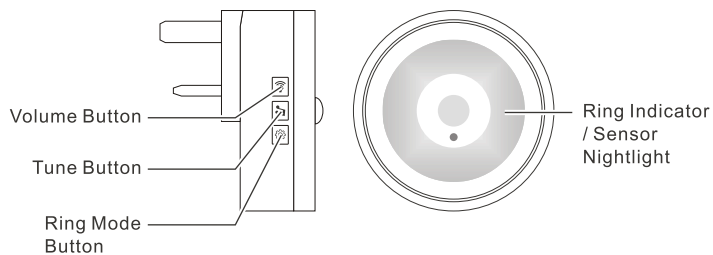

HOW TO INSTALL & OPERATE

- 1 Installing bell push :
- Attach the double sided tape to the back of the bell push and mount the bell push to the wall.

OR

- Unclip the bell push cover with your thumbs gently.
- Mount the bell push to the wall using the screws.
- Close the cover.

Unclip the cover gently. Stop pulling further first when the bottom is opened and a click sound is heard.

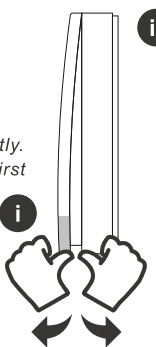

ii Continue to pull the bell push cover open slowly and carefully to unfasten the upper corners of the cover from the joints. If the cover is locked too tight by the joints, try to sway the cover slightly to loosen it up..

- 2 Plug the chime into the socket outlet.
- Press the [Tune Button] repeatedly to select tune.
- Press the [Volume Button] repeatedly to adjust the ring volume.
- Press the [Ring Mode Button] repeatedly to select the ring mode.
* 4 modes : ring + flash, ring-only, mute + flash, ring + nightlight.

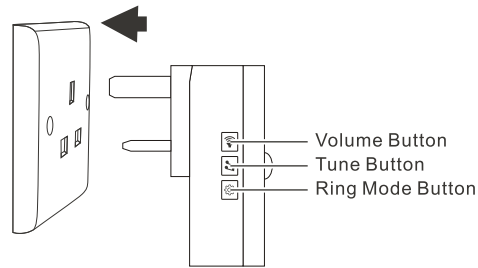

- 3 Your doorbell is ready to use. Press the [Push Button] to ring the chime.

PAIRING ADDITIONAL BELL PUSHES / CHIMES

- 1 Press and hold the [Ring Mode Button] for 3 seconds until you hear a tone and the indicator flashes.

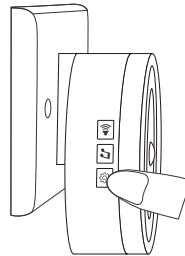

- 2 Press the [Push Button], pairing successful if the tune is heard.

(Note : Please complete this step within 30 seconds after the tone is heard. The chime will exit the set-up mode after 30 seconds. To re-enter the set-up mode, press and hold the [Ring Mode Button] for 3 seconds again.)

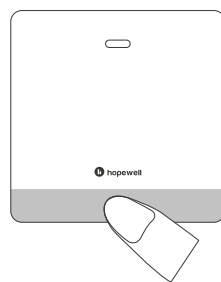

- 3 To pair multiple bell pushes or chimes, simply repeat the step 1 - 2 above.
- 1 bell push can be paired with multiple chimes; multiple bell pushes can be paired with 1 chime; or multiple bell pushes can be paired with multiple chimes.
- E.g. If you wish to pair 2 bell pushes with 3 chimes, pair the first bell push with the 3 chimes first, then pair the second bell push with the 3 chimes.

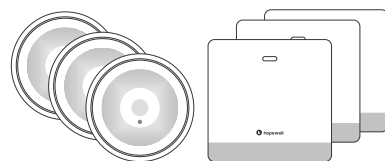

* Expandable with all DN models

- 4 To unpair a chime with all bell pushes and reset the tune, press and hold the [Ring Mode Button] for 10 seconds until you hear the chime rings.

FAQ

My chime does not ring by pressing the [Push Button], any fix?

Your chime and bell push may have been accidentally unpaired. You can try to reconnect them by following step 1 - 2 in the " PAIRING ADDITIONAL BELL PUSHES / CHIMES " section above.

SENSOR NIGHTLIGHT

A warm white sensor nightlight with light and motion sensor is included.

Darkness + motion sensor : The sensor nightlight turns ON automatically when it is dark and movement is detected. It turns OFF automatically after 30 seconds of non-motion. The sensor nightlight does not turn ON when the Ring Mode is set to ring + nightlight mode.

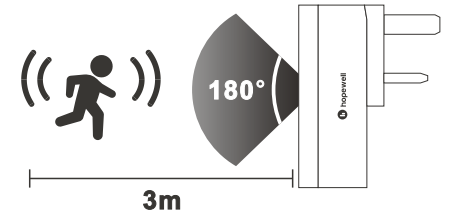

CARE AND CLEANING

NOTES

- Switch off and unplug the device before cleaning.
- Never immerse the device, plug or cord in water.
- The electrical connections or switches must not come into contact with water or liquid.



- Wipe dust off the surface of the device using a dry, soft cloth. If necessary, use a damp well-wrung cloth containing a few drops of mild detergent to remove persistent stain, then clean and dry.
- Do not use abrasive tools, they will scratch the device surface.

PROPER DISPOSAL



To help protect the environment, dispose of your device separately from household waste at the end of its working life. It can be taken to appropriate collection points provided in your country. Product marked with a crossed-out wheeled dustbin means that it must be disposed of properly according to local laws and regulations.

TROUBLESHOOTING

Problem	Possible Cause	Solution
Chime has no sound even by pressing the [Volume Button] or [Tune Button] or [Ring Mode Button].	No power.	Check if the chime has been firmly plugged into the power outlet. Check if the power outlet has been switched ON.
	Unstable or incorrect voltage.	Check if your voltage is stable and corresponds with that printed on the rating plate at the back of the chime.
Chime does not ring while pressing the [Push Button].	Chime and bell push have been accidentally unpaired.	Follow the steps in the " PAIRING ADDITIONAL BELL PUSHES / CHIMES " section to reconnect them.