

PapabliC

INSTRUCTIONS FOR USE



DUCKBILL VALVES

For Spectra,
Medela breastshields

IMPORTANT SAFEGUARD

Warning

Read all the instructions before you start.

1. Before first use, clean it with boiling water for 5 minutes. Do not clean with solvents or harsh chemicals.
2. Do not expose the adapter to extreme heat and do not place it in direct sunlight.
3. Always use this product with adult supervision.

COMPATIBLE MODELS

1. For Spectra S1, S2, 9 Plus, Spectra Dew 350

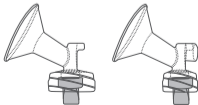

2. For Nenesupply / Maymom Breastshield



3. For Medela: Pump In Style, Swing, Harmony, Lactina, Symphony and Mini Electric



One-piece
breastshield



Swing
breastshield



PersonalFit
breastshield

Note: It is not defective when you see a small gap between the lips of the valves. When the pump generates suction, the gap will be closed and valves will function properly.

HOW TO USE

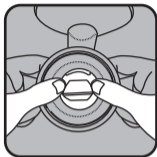

Attach duckbill valves onto breastshields. Push all the way up. **Make sure it attaches tightly.**

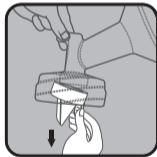

When detaching duckbill valve, grab the pull tab and slightly drag down.

HOW TO CLEAN

Wash in warm soapy water and rinse in clean water.

Sanitize with water steam for 15 mins or boiling water for 5 minutes.

Note: Do not use hard brushes.

Note: Do not use abrasive or antibacterial cleaning agent.

SPECIFICATION

Material: Silicone, BPA free material

Size: 1.1x1.1x1.2 inches



www.papablic.com



service@papablic.com



LIFETIME GUARANTEE SERVICE

All Papablic products are covered by a LIFETIME guarantee after registering your product at **www.papablic.com**. That means Papablic will replace (free of charge!) your defective silicone diaphragms for as long as you still own it. Not for as long as the guy you sold it to at the flea market has it. Simply, upon receipt of the product and proof of purchase, we will send you a brand new unit (USA and Canada only). Negligent abuse of the product voids this guarantee.

Questions? If so, feel free to contact us at **service@papablic.com**, and one of our overly eager customer service representatives will get right back with you.

Note: Medela, Pump In Style, Swing, Lacyina, and Symphony are registered trademarks of Medela AG Switzerland. Spectra is registered trademark of Spectra Baby USA. Maymom is registered trademark of Maymom LLC. Nenesupply is

registered trademark of NENESUPPLY LLC. This is a generic product manufactured and distributed by Papablic Inc. Papablic has no affiliation with or endorsement from Medela, Spectra, Maymom and Nenesupply. Any use of the Medela, Spectra, Maymom, NENESUPPLY brand names, model or any other related designations are made solely for purposes of describing and illustrating compatibility.