

Ergoplan Cupboard 1800H

Assembly Instructions

Tools Required: Powered Screwdriver



Assembly Instructions

- To prevent possible scratches or damage, assemble the product on a soft surface such as a blanket, carpet or packaging.

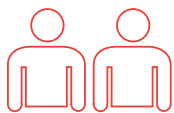

Recommended
2-person Step

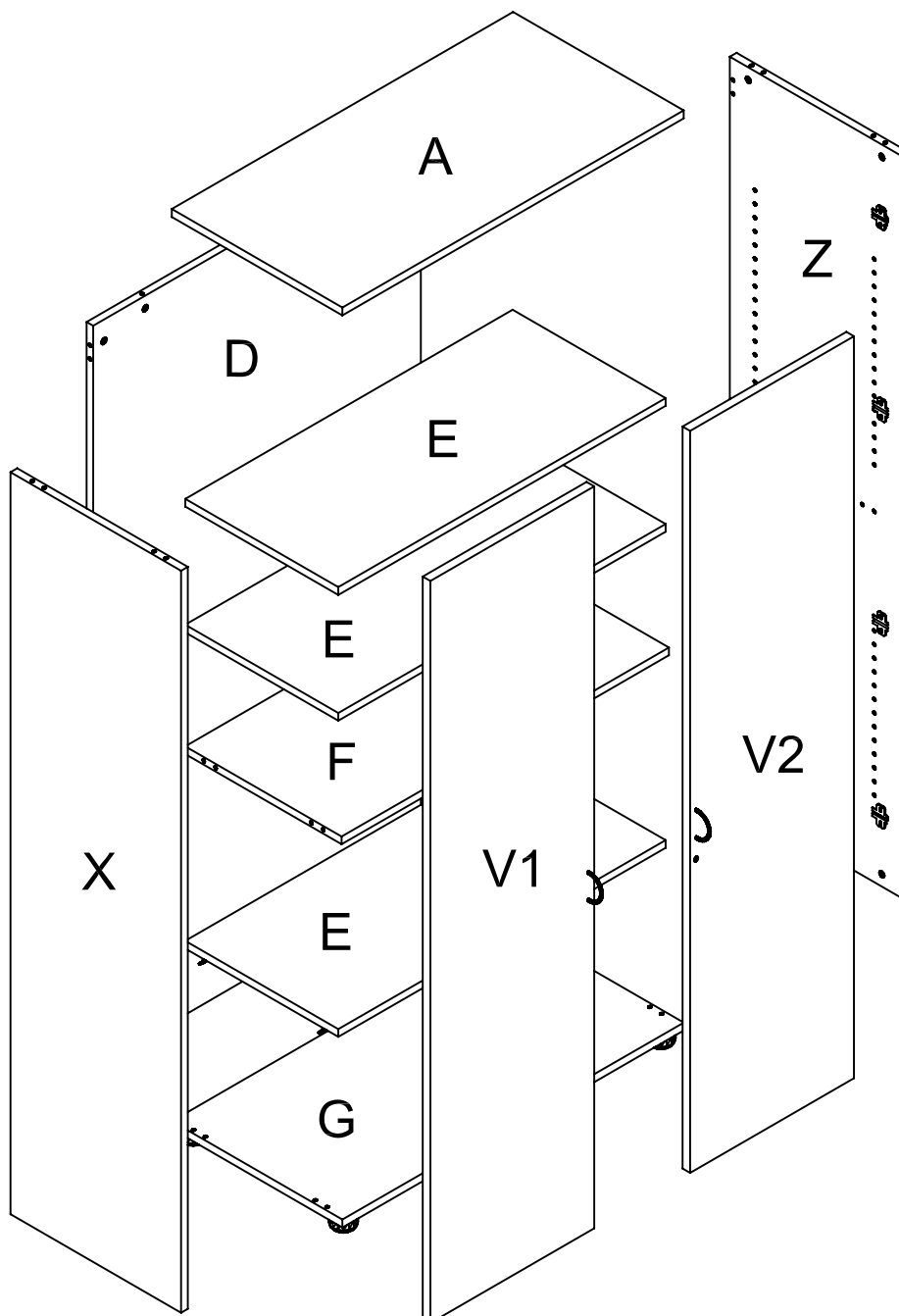

Assembly Instructions

Parts

| Item | Description | Qty | Item | Description | Qty |
|------|------------------|-----|-----------|--------------------|-----|
| A | Top Panel | 1 | c1 | 6*35 Cam Bolt | 25 |
| X | Left Side Panel | 1 | d1 | 8*30 Dowel Pin | 24 |
| Z | Right Side Panel | 1 | c2 | 5/8" Cam Cover | 25 |
| D | Immovable Panel | 1 | h3 | Handle | 4 |
| G | Back Panel | 1 | k1 | Lock Catch | 1 |
| F | Immovable Panel | 1 | s1 | 4*16 Screw | 38 |
| E | Moveable Shelf | 3 | s7 | 4*22 Fix Bolt | 4 |
| V1 | Door Panel | 1 | g2 | Hinge Body | 8 |
| V2 | Door Panel | 1 | g1 | Hinge Stand | 8 |
| | | | p1 | Threaded Dowel Pin | 12 |
| | | | k4 | Lock | 1 |
| | | | k5 | Lock Catch | 1 |
| | | | s2 | 4*35 Catch | 4 |
| | | | c6 | Cushion | 4 |



c1 25 x 6*35 Cam Bolts

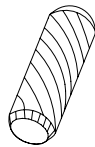

d1 24 x 8*30 Dowel Pin



c2 25 x 5/8" Cam Cover



h3 2 x Handle

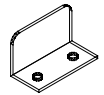

k1 1 x Lock Catch



s1 38 x 4*16 Screw

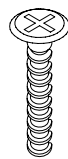

s7 4 x 4*22 Fix Bolt

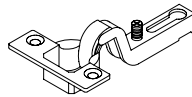

g2 8 x Hinge Body



g1 8 x Hinge Stand



p1 12 x Threaded Dowel Pin

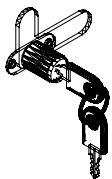

k4 1 x Lock

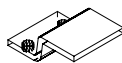

k5 1 x Lock Catch

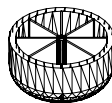

c6 4 x Cushion



s2 4 x 4*35 Screw

Pre-installed Parts



c5 Cam

Assembly Instructions

Step 1

Preparation for top panel A, bottom panel G, left side panel X, right side panel Z, immovable panel F, door panel V1 and V2.

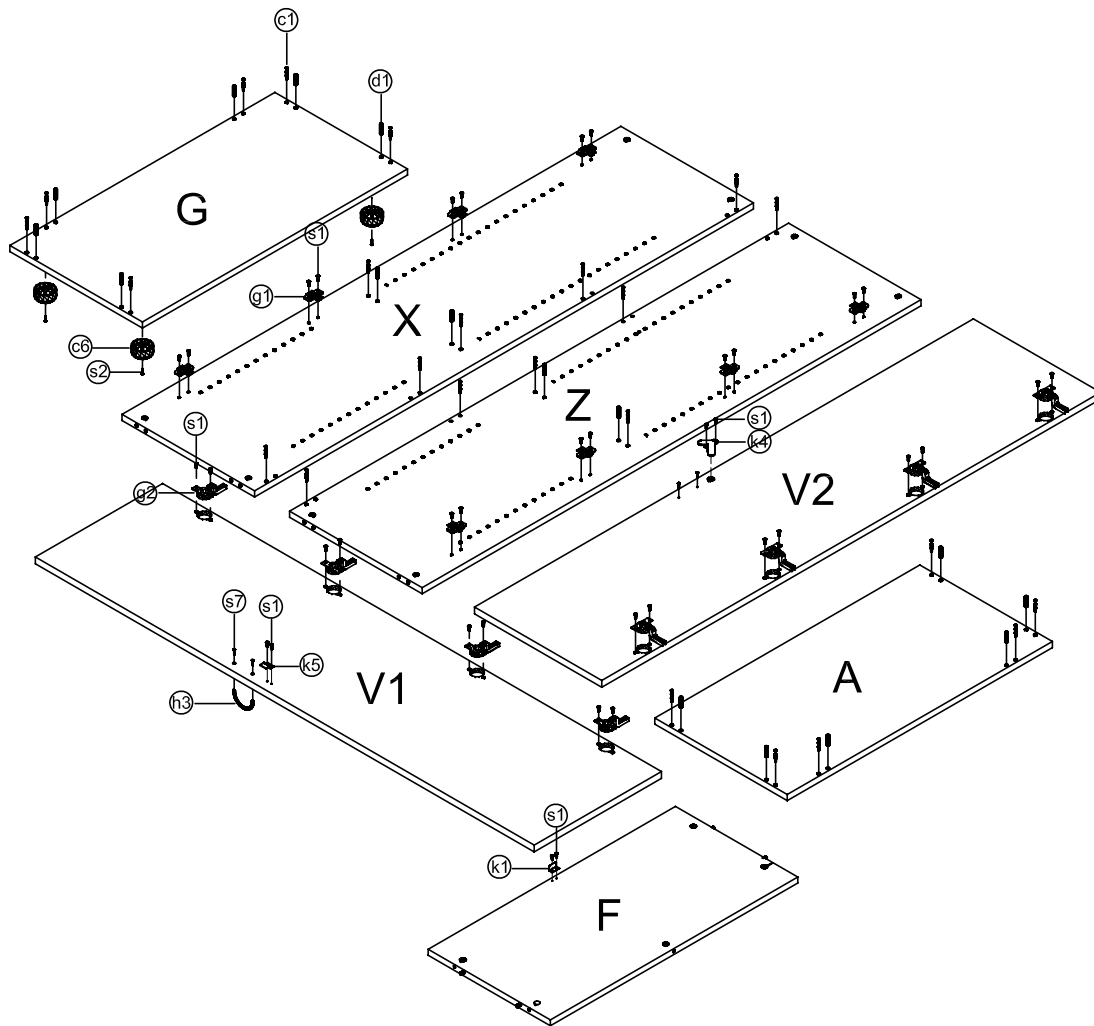

1. Insert cam bolts (c1) and dowel pins (d1) into panels A, G, X and Z.
2. Fix the lock catch (k1) to panel F with screws (s1).
3. Fix hinge stands (g1) to panels X, Z with screws (s1).
4. Fix hinge bodies (g2) to panels V1 and V2 with screws (s1).
5. Fix handles (h3) to panels V1 and V2 with fix bolts (s7).
6. Fix the lock catch (k5) to panel V1 with screws (s1).
7. Fix the lock (k4) to panel V2 with screws (s1).
8. Fix cushion (c6) to panel G with screws (s2).

Step 2

Immovable panel F, Back panel D and Left side panel X assembly.

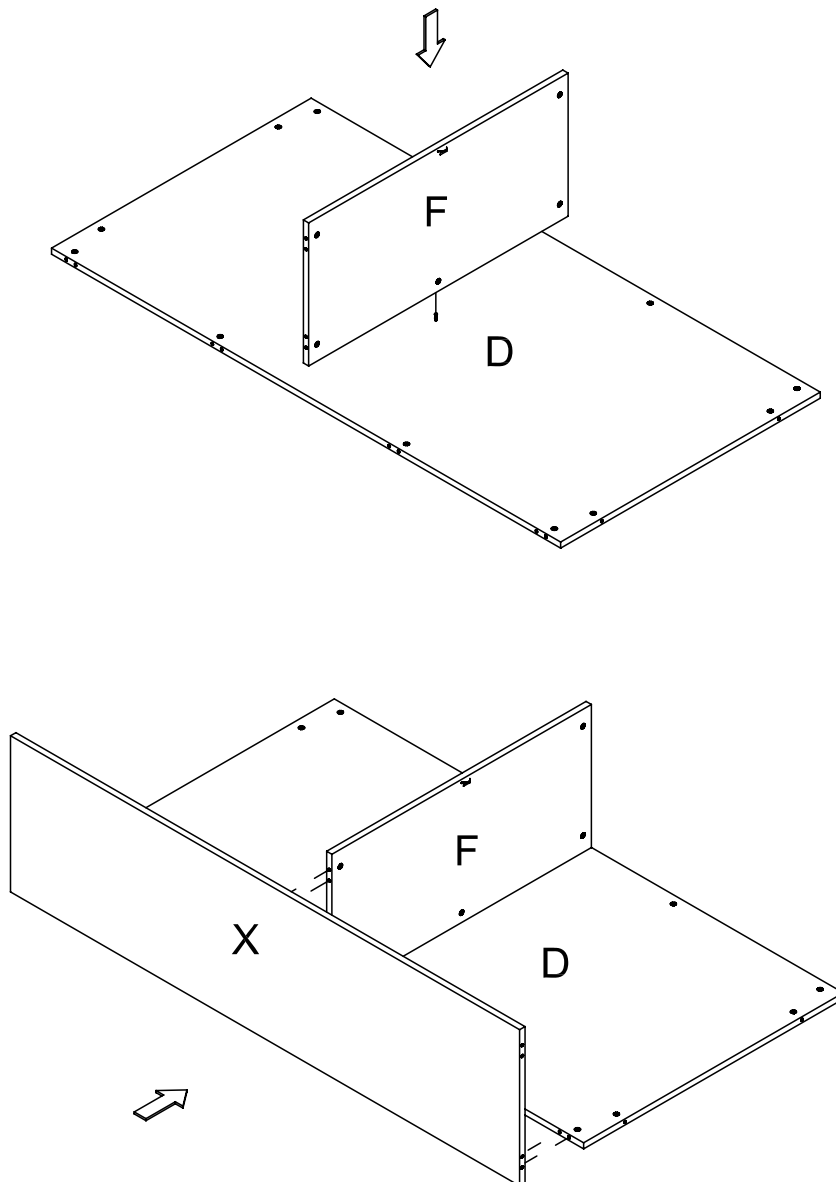

1. Fix cams on panel F into cam bolts (c1) on panel D and tighten in a clockwise direction.
2. Fix cams on panel F and D into cam bolts (c1) on panel X and tighten in a clockwise direction.

Step 3

Top panel A, Bottom panel G and Right side panel Z assembly.

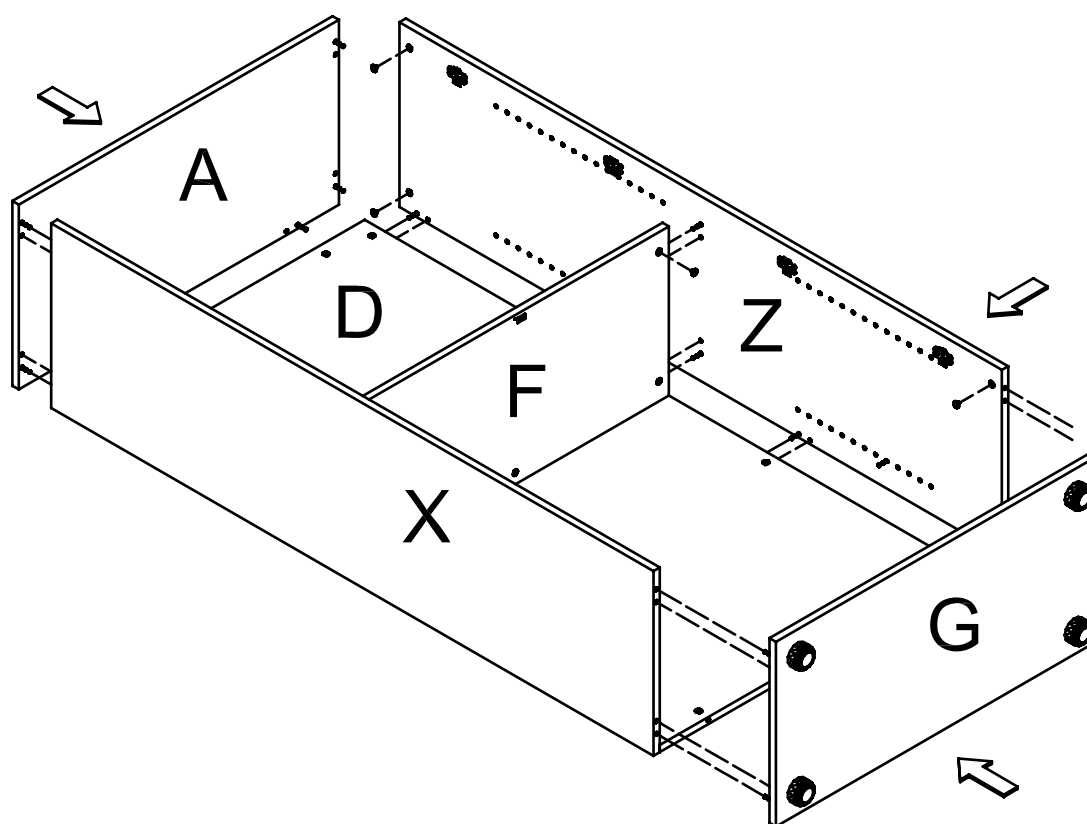

1. Fix cams on panel F and D into cam bolts (c1) on panel Z and tighten in a clockwise direction.
2. Fix cams on panel X, Z and D into cam bolts (c1) on panel A and G, and tighten in a clockwise direction.
3. Cover with cam covers (c2) on the top of all the cams.

Step 4

Moveable shelf E assembly.

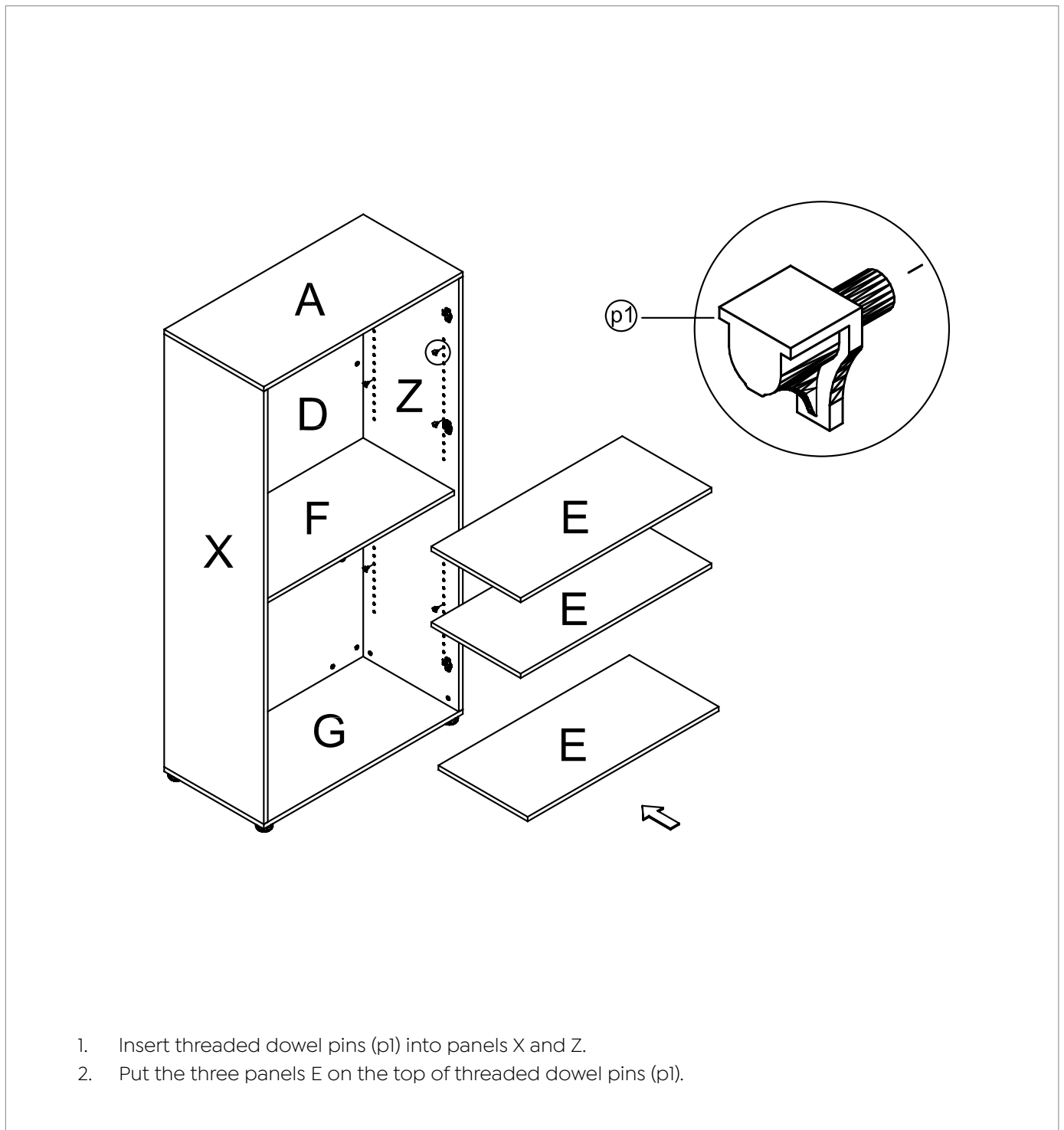

Step 5

Door panel V1 and door panel V2 assembly.

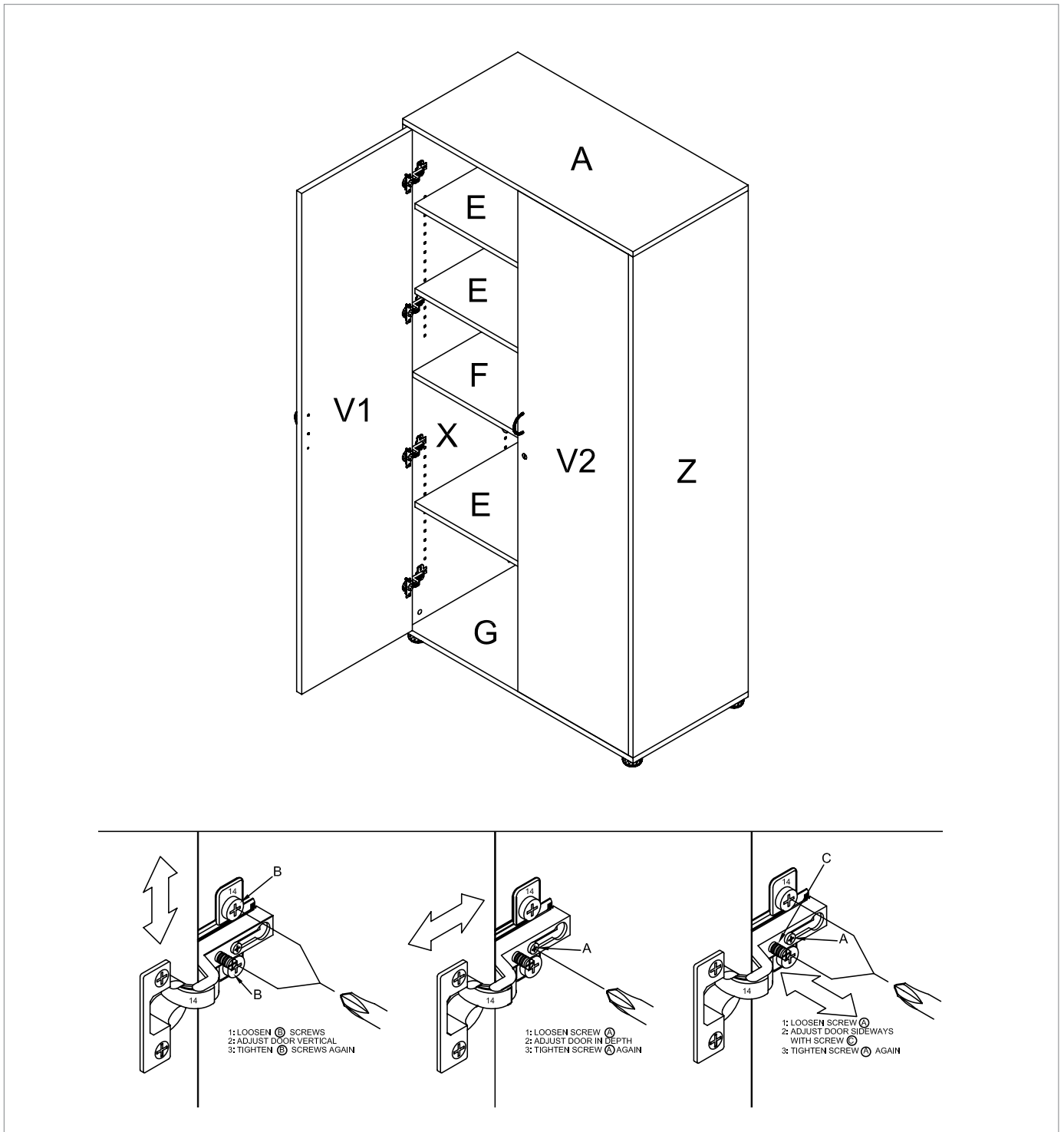

Completed

