



**INSTALLATION INSTRUCTIONS  
NO DRILL LICENSE PLATE MOUNT  
VEHICLES WITH HORIZONTAL SLAT OR EGG  
CRATE GRILLE DESIGN**

Thank you for choosing to purchase a Carbonio product. Please take the time to fully read over these instructions before attempting to install the kit. This will greatly speed up the installation process and minimize any difficulties you may encounter.

These instructions explain the procedure to install a No Drill License Plate Mount on a particular **style** of front grille. Individual kits are vehicle specific and may contain pieces that differ slightly from the images contained in this manual.

**Tools Required:**

- Phillips head (star) screwdriver (for North American installs)

**NOTE:** The license plate mount is almost infinitely adjustable comes pre-assembled with a generic setup. Before mounting the plate it first needs to be fitted to the car and sized depending on the particular vehicle and license plate size that is being used. Once sized it can be removed and installed without any need to make any further adjustments.

**SIZING THE PLATE MOUNT TO THE CAR**

**Step 1a:** Begin by ensuring that the rear rubber coated hooks are turned 90 degrees and are clear of the front mounting hook (see photo right).

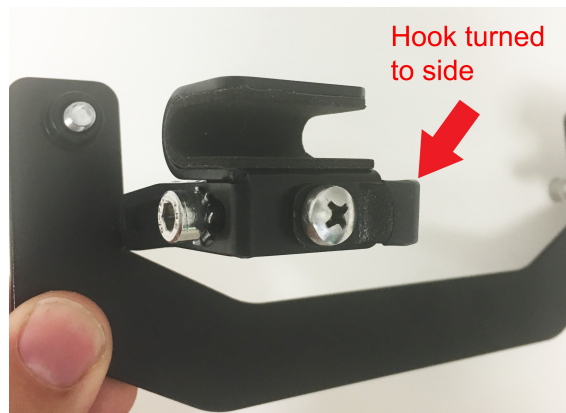

**Step 1b:** Slide the mount onto the grille

**Step 2:** Fix the mount in place by grabbing the serrated finger grips and pushing the rubber coated hook back on the spring loaded pin until the hook is clear of the backside of the grille. Once the hooks is clear, rotate the hook upwards until it is vertical and then gently release the spring pressure. Repeat this procedure for the opposite side.

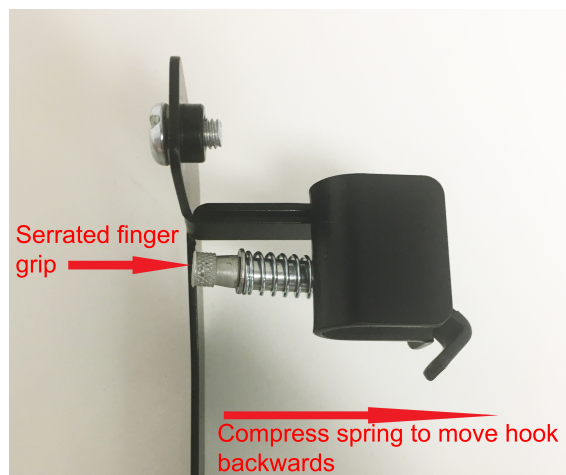

**Step 3:** With the mount in place take the included hex tool and loosen the screws on either side of the front plate mount. With the screws loose slide the plate mount forwards or backwards as needed to get the plate clearance and angle desired. When the final position is achieved, firmly tighten the Allen head (hex) bolts.

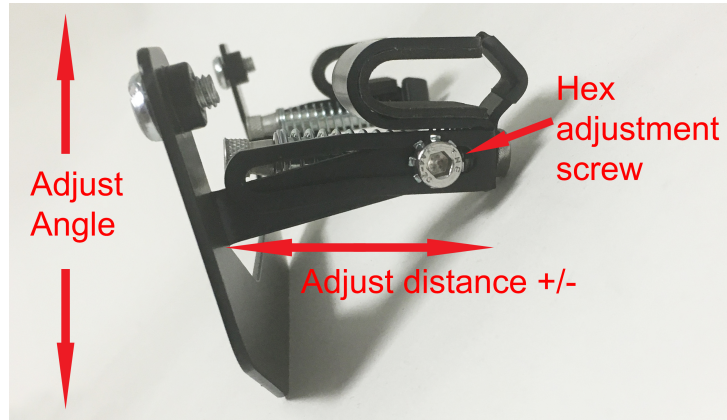

## CUSTOM MOUNT COMBINATIONS

The images right illustrate some of the combinations that can be achieved by removing the side hex screws and reconfiguring the mount.

By changing the position and orientation of the mounts it is possible to truly tailor a mount to a particular car or the preferences of an owner.

No matter the orientation the mount is designed to operate at its best regardless of its setup.

In addition to being able to change the position of the mounts, the plate bracket itself can be oriented with either the mounting screws to the top or oriented with the screws on the bottom to vary the way that the license plate is mounted.



## **FITTING THE LICENSE PLATE TO THE MOUNT**

### **North American License Plates**

Using a Phillips (star) head screwdriver affix your license plate to the mount using the two screws provided. Note: These screws should be long enough to accommodate most aftermarket license plate frames and there is no issue using a plate frame or cover with the Carbonio mount.

### **Rest of World (ROW) License Plates** (must have been specified at time of order)

Rest of world cars have their license plates adhered to the plate mount using high strength 3M mounting tape. Included in your kit is a small alcohol cleaning wipe. After ensuring that the backside of the license plate is clean and dry, peel off the red covering on the 3M tape and then adhere the license plate to the exposed 3M tape.

**NOTE: The bond between the 3M tape and the bumper is VERY STRONG. Be sure of its positioning before touching the license plate to the tape because you will only get one chance to make the bond.**

### **Recommended Additional Protection**

Depending on the country / size of the front plate, it is possible that with extreme wind pressure or if bumped, that the plate can contact the body. In order to eliminate the chance of any paint damage, 2 self-adhesive rubber bumpers have been included.

One or more of these bumpers should be adhered to the backside of the number plate to act as an additional guard for the front bumper or grill. Ultimately the final location of these bumpers is **up to the discretion of the installer** however the goal of the bumper is to act as a point of contact in a worst case scenario and should be positioned accordingly.