

## 5. MAINTENANCE

---

**⚠ WARNING: Power should be disconnected before beginning preventive maintenance on the concentrator.**

**⊘ DO NOT service or maintain while in use.**

The concentrator regularly performs a self-check to verify pressure and oxygen purity. In addition, yearly maintenance by a qualified service professional is recommended for optimal performance. In environments that collect dust easily, it may need to be serviced more often.

### 5. Maintenance

#### 5.1 Cleaning the Cabinet

Check the cabinet once a month and clean if visibly dirty.

- Turn off the power switch and unplug the concentrator from the wall outlet.
- Only the outside of the concentrator needs to be cleaned. Use a soft dry cloth, a damp sponge, or wipes with an alcohol-based cleaning solution. Do not use acetone, solvents or any other flammable products. Do not spill liquids inside the cabinet.

#### 5.2 Cleaning or Replacing the Filters

Clean and replace the filters as often as specified below in order to protect the compressor and extend the concentrator's life:

- ⊘ DO NOT operate the concentrator without the filters installed, or if the filters are wet. This can permanently damage the concentrator.

1. **Transom filter** - Clean as needed. Check the filter every 2 weeks and clean if visibly dirty. Use a small screwdriver to unscrew the block of transom filter holder, then take the transom filter holder out from the access door. Separate the holder pieces and take the filter out.



Transom filter is the black vent on the side

## 5. MAINTENANCE

---

2. **Intake filter** - Clean as needed (usually annually or until it turns black.) If necessary, replace the filter.
  - The intake filter door is on the left side of the concentrator. The intake filter is behind the Transom Filter. Using a small screwdriver, open the access door. Unscrew the filter core. Remove the intake filter.
  - The maintenance frequency of the filter is based on actual time used and the environment. Replace the filtration core when it turns black. Check more frequently if in an environment that collects dusty easily and clean when visibly dirty.

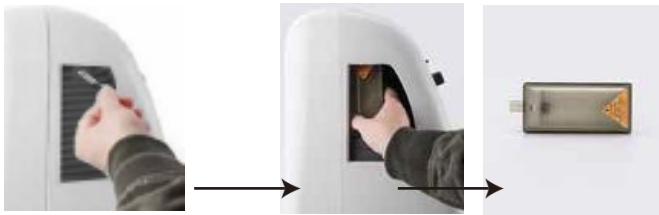

### 5.3 Cleaning the Optional Humidifier Bottle

- Change the water in the humidifier bottle every day.
- To Clean: Wash the humidifier bottle weekly using household detergent. Then rinse it completely under running water and dry.
- To Disinfect: Disinfect the humidifier parts by immersing them in a disinfecting solution, or a solution of 1-part vinegar diluted with 10 parts water. Then rinse it completely under running water and dry.
- To remove and disassemble the humidifier bottle:
  - (1) Disconnect the tubing from the humidifier bottle and the device
  - (2) Remove the humidifier bottle from the holder on the device and remove the cover from the humidifier bottle to clean and disinfect.

### 5.4 Oxygen Nasal Cannula

Refer to the nasal cannula manufacturer's instructions for cleaning.