



DreamStation Modem Removal and Installation Instructions

⚠ Please note: You must complete these steps for modem installation to ensure prescription delivery to your replacement device.

These instructions will allow you to utilize your existing modem for your replacement device, or in the case you receive a replacement modem separately.

You may have one of two different modem models.

Determine your current modem type and choose the instruction option that matches your modem.

You will only need to use one instruction path based on your modem type.

Option A: Standalone Modem Cartridge

* Instructions below

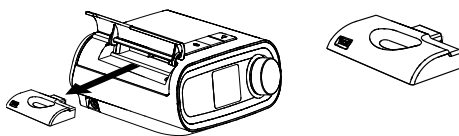

OR Option B: Combo Modem/Door Cartridge

* Instructions on back page

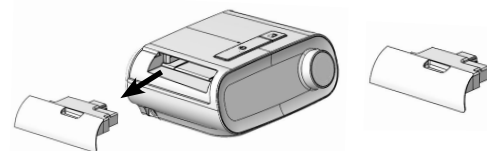

A: Instructions for Standalone Modem Cartridge Removal:

- 1 • Ensure the therapy device is off and not blowing air. You can keep the unit plugged in for this procedure.
- 2 • Open the modem door located on the left side of your current therapy device (FIG. A).
 • Gently, pull the old modem out of your therapy device (FIG. B).
 • Set modem aside for later instruction.
 • See separate **"BASIC SETUP & RETURN"** instructions for proper return of your old device.

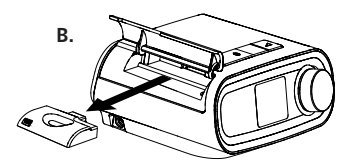
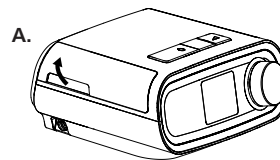

A: Instructions for Standalone Modem Cartridge Installation:

- 1 • Take the modem that you removed from your older DreamStation device.
 • Open modem door (FIG C) on your replacement DreamStation device and slide the modem into place (FIG. D).
 • Close modem door.
 • Please keep the unit plugged in for at least 5 minutes to ensure your new modem connects successfully. This will happen automatically, and no additional steps are required.

⚠ Please Note: You must complete these steps for modem installation to ensure prescription delivery to your replacement device.

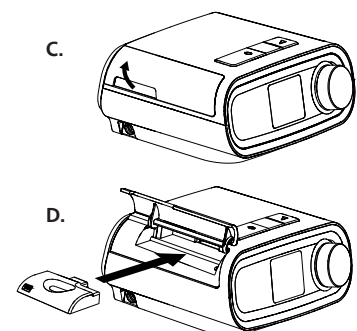

DreamStation

Modem Removal and Installation Instructions

Option B: Combo Modem/Door Cartridge

* Instructions below

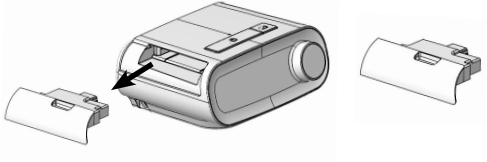

B: Instructions for Combo Modem/Door Cartridge Removal:

- 1 • Ensure the therapy device is off, and not blowing air. You can keep the unit plugged in for the procedure.
- 2 • Gently, pull the old modem/door combo out of your current therapy device (**FIG. A**).
• Set modem aside for later instruction.
• See separate **“BASIC SETUP & RETURN”** instructions for proper return of your old device.

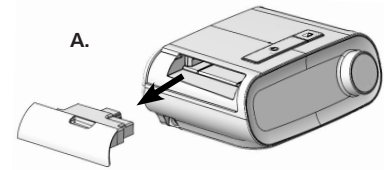

B: Instructions for Combo Modem/Door Cartridge Installation:

- 1 • Your replacement DreamStation device will come with a modem door attached. You will have to remove it if you have a combo modem/door cartridge model.
• Take the modem that you removed from your older DreamStation device or the replacement modem that may have been sent to you separately and use in the steps below.
- 2 • Remove the modem door from the left side of your replacement DreamStation device by lifting the door open and firmly sliding the door to the left (**step 1**) and pulling the right side of the door toward you until the hinge pops out (**step 2**). This may take a couple of attempts (**FIG. A**). Keep the door for possible future use.

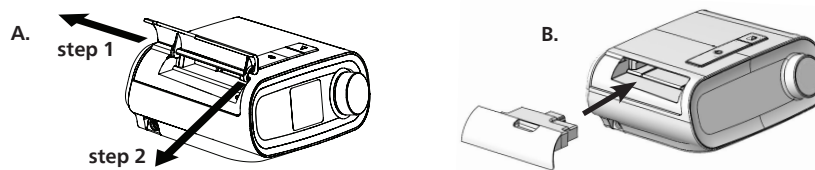

- Slide your existing or new modem into the accessory slot until it clicks into place (**FIG. B**).
- Please keep the unit plugged in for at least 5 minutes to ensure the modem connects successfully. This will happen automatically, and no additional steps are required.

① **Please Note: You must complete these steps for modem installation to ensure prescription delivery to your replacement device.**

Visit us at www.philips.com/ds1-replacement for a digital copy of all of the materials, information about setting up this device, and an introduction to product features.

Thank you for your cooperation in this effort.

Please contact us at 833-262-1871 or www.philips.com/SRC-update if you have any questions.