

## THE BOLTONS BOTTLE TRAP

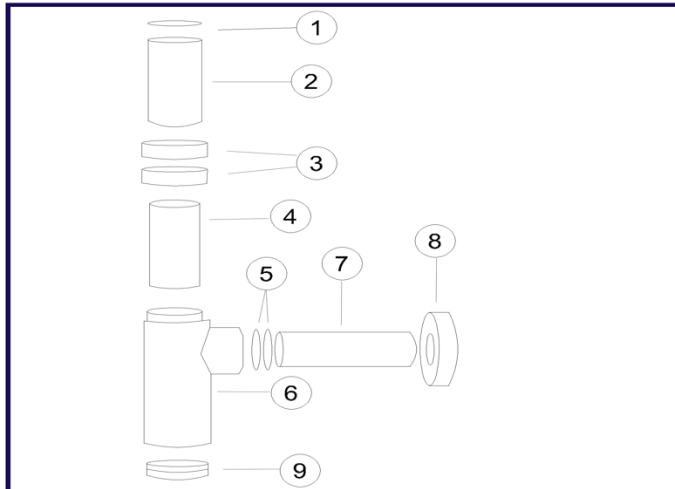

1. Flat washer (38x30x2).
2. Brass pipe with flange.
3. Brass round nuts 1"1/4 D.50.
4. Polypropylene pipe.
5. O-Ring washer.
6. Trap D. 50mm.
7. Brass pipe (D.32x400 inc adapter).
8. D.32 x 70 brass flange.
9. Inspection plug with O-rings.

Manufactured in Italy for Rutland Radiators.

**Please note:** This bottle trap is designed to be used in conjunction with basin stands, taps and wastes supplied by Rutland Radiators.

If you are considering installing alongside another brand, please contact Rutland Radiators first to ensure compatibility.

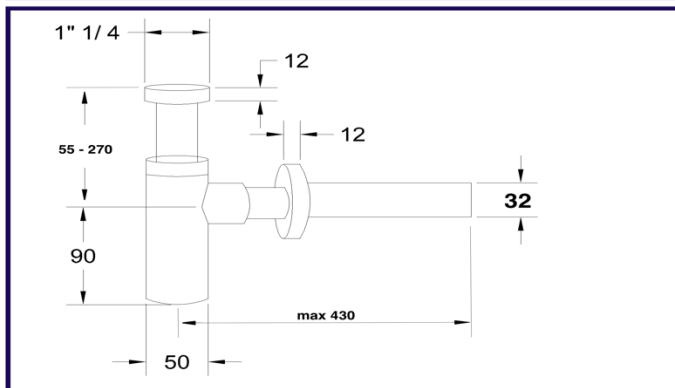

Rutland London Limited: E: [sales@rutland-radiators.co.uk](mailto:sales@rutland-radiators.co.uk) T: 01252 790 464  
[www.rutland-radiators.co.uk](http://www.rutland-radiators.co.uk)

Rutland Radiators reserves the right to alter finishes and dimensions without prior notification.

Drawings and dimensions are supplied to a tolerance of +/- 3mm