

On/Off Button

2 hour Boost
Button

Temperature
Increase /
decrease
Buttons



The low profile Queensgate Control Panel allows users to have a much higher level of control than traditionally found with electric heated towel rails.

Capable of controlling a range of element sizes from 150 Watts to 1 KW. Functions of the Queensgate Control Panel include easy temperature adjustment in 20% intervals and a 2-hour boost function.

The Queensgate Thermostatic Control Panel is IPX5 rated meaning that it is suitable for installation within the bathroom environment.

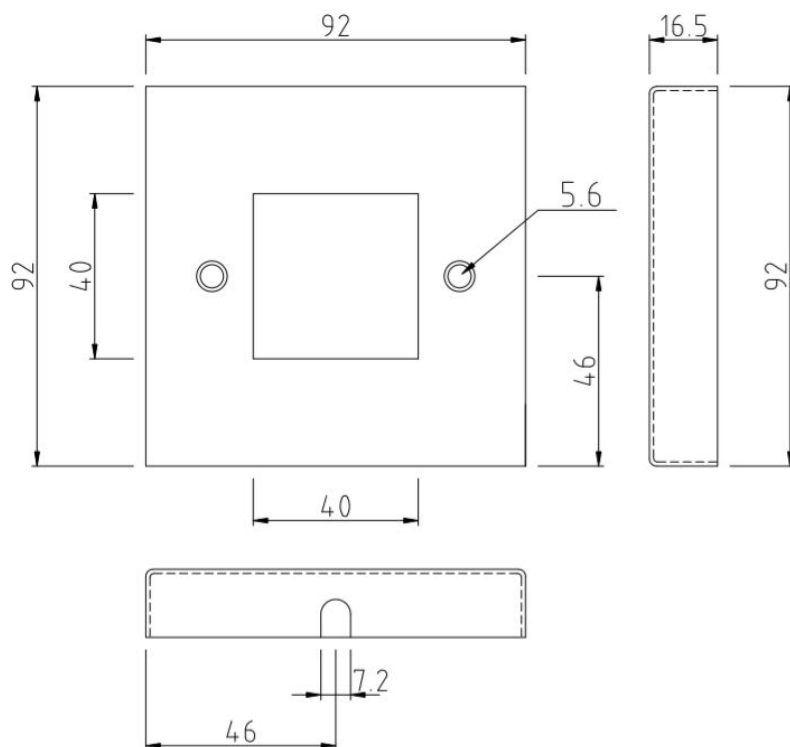

Designed to fit a Standard 85mm pattress box.

Test Pressure: 8 bar.
Max. Working Pressure: 5 bar.
Max. Working Temperature: 85°C.
Material: 32mm DZR Brass.
Connections: ½" BSP.
Joints: Hand Brazed Silver Solder.
Finish: Hand Polished.
Plated To: British Standards.
Leak Tested: 3 Times.
Heat Output: In accordance with EN442.

To be installed by a suitably qualified professional in accordance with local water byelaws.
Our Towel Warmers are suitable for:
Most Central Heating Systems.
Hot Water Systems. **(unsuitable for use with column radiator inserts)**
Dual Fuel Systems.
Electric only.
Please confirm with your installer/contractor that there is not a water softener fitted on the system prior to installation.
All dimensions are subject to +/- 3 mm tolerance.