

WARNING: For correct operation & installation, it is essential to observe these instructions

TWIN UNDERSINK WATER FILTRATION SYSTEM



CONTENTS

Twin Undersink Water Filtration System.....	1
Installation and Operation Manual	3
AquaCo Customer Service	3
Operation	3
Installation.....	4
Installation requirements	4
Typical Installation	4
Installation Procedure	5
Cartridge Installation/Maintenance.....	6
Faucet Installation Procedure	7
Guide to use Push-In Tube Connectors.....	8
Use Guidelines	8
Cartridge Replacement Guide.....	9
Performance Data Sheet.....	10
Notes.....	12
Warranty	12
Warranty/Australia	12

INSTALLATION AND OPERATION MANUAL

AQUACO CUSTOMER SERVICE

Thank you for purchasing an AquaCo undersink water filter system. Your system is a proven performer manufactured from only quality materials and components and will give years of 'spring fresh' water free of impurities if maintained properly.

Caution: Do not use with water that is microbiologically unsafe or with water of unknown quality without adequate disinfection before or after the system.

The system is designed for metropolitan supply water but can be used in other situations. For other types of water supply please contact your local AquaCo stockist or call our AquaCo Customer Service Helpline.

The AquaCo filter systems cartridges need replacing regularly to maintain optimum performance. This is a simple procedure when following instructions. For cartridge replacements contact your nearest AquaCo stockist.

Customer Service Helpline 08 6156 0220 (Australia).

OPERATION

The AquaCo undersink systems are designed to run economically for many years, dependent on the initial installation and periodical maintenance.

Flush systems for 10 minutes after any period of non-use more than 2 days. For a period of non-use of 2 weeks or more, it may be necessary to replace cartridges.

This product must be installed in accordance with local plumbing regulations by a licensed plumber.

Intstallation Note: A water filter system/tap, like any product, has a limited life and may eventually fail. Also sometimes failure happens early due to unforeseen circumstances. To avoid possible property damage, this product should be regularly examined for leakage and/or deterioration and replaced when necessary. A drain pan, plumbed to an appropriate drain or outfitted with a leak detector, should be used in those applications where any leakage could cause property damage, and/or the water supply should be turned off if no one is home/present.

INSTALLATION MUST BE COMPLETED BY A LICENCED PLUMBER. FAULTY OPERATION DUE TO UNQUALIFIED PERSONS WILL RESULT IN VOIDED WARRANTY COVERAGE.

INSTALLATION

This system comes complete with an installation kit enabling it to be connected to 15mm (½") copper pipe (cold supply only - hot water should be filtered prior to heating). Included is a control valve incorporating backflow prevention, anti hammer, flow control and pressure limiting capabilities in full compliance with the relevant laws.

INSTALLATION REQUIREMENTS

1. 13 mm (½") Cold water line.
2. Min/Max pressure: 200 - 520 kPa.
3. Min/Max temperature 0° - 30°C (protect from freezing).
4. Suitable location for faucet.

Alternative fittings may be required if being connected to anything other than 15mm (½") copper pipe. No electrical or drainage requirements needed.

TYPICAL INSTALLATION

Figure 1

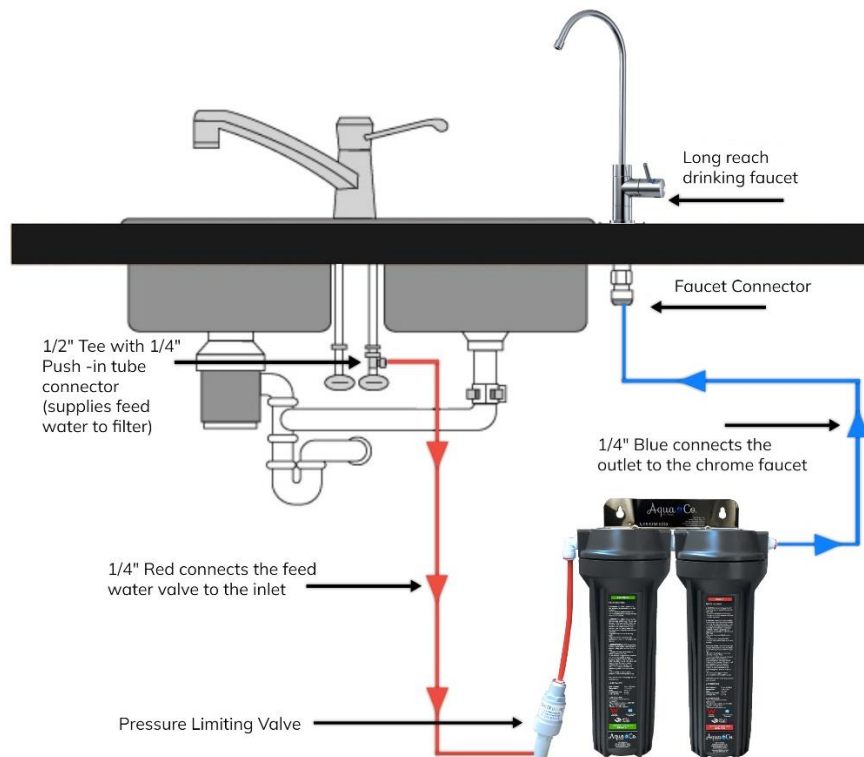

- Angle stop valve (Not included)
- 1/2" Tee with 1/4" Push-in Tube Connector
- 1/2" Braided Cold Water Hose (Not included)
- 1/4" Flexible Red Tubing to Water Filter
- Pressure Limiting Valve
- Elbow Connector 1/4" Tube to 1/4" Male
- Pre-assembled Twin Undersink Water Filter
- 1/4" Flexible Blue Tubing to Faucet
- JG 1/4" Tube to 7/16" Female to Faucet
- High Loop Faucet with LED Indicator

INSTALLATION PROCEDURE

1. Select suitable location that is close to the point of filtered water delivery (eg. sink). Remember to allow access room for changing filters and a suitable place where water spillage will not cause damage. Location should not be in direct sunlight.
2. Isolate water supply. Uninstall the connections on the cold water line and connect the Smart Tee™ (see Fig. 2). Reinstall the previous connection to the tee valve.
3. Connect the pressure limiting multivalve to the Smart Tee™ with a length of white tubing.
4. Choose the best position for the faucet, taking into consideration height of jugs etc. and also the drainage of any spills. Then drill a 12.5mm hole and install the faucet as in step 5.
5. To install faucet, insert the faucet into the hole in sink or bench. The faucet may be installed on any flat surface over 50mm (2") in diameter. (Remember: check the underside of the location for interference). Make a small indent using a centre punch to mark the desired drilling location. Drill a pilot hole with a metal drill. Enlarge the hole using a 1/2" metal drill bit.

Once the hole has been drilled install the faucet as per Figure 3. Be sure the faucet body, chrome plate, and the black rubber washer are placed above the sink. Install the black locating washer, the lock washer and nut underneath, then tighten firmly while aligning faucet in the desired direction.

6. Reset LED indicator by following instructions on page 7.
7. Install housing assembly by positioning it in the desired location, marking the position of fixing holes and fixing with mounting screws. Allow room for the connecting tubes and for removing the filter sumps (50 mm).
8. Fit tubing into connectors (for quick-connect fittings see fig 8). Allow slack in the tubing. Make sure flow is right according to inlet outlet on housing assembly. For faucet connection see figure 3.
9. Install cartridges as per cartridge installation/changeout.
10. Restore the water supply and check for leaks. The filters need to be only hand tight. If they leak then undo housing and check the O-ring is seated properly.
11. Run the system for at least 10 minutes (push the faucet lever to the upright position) to remove carbon fines. Water may appear milky, but this is normal and is only tiny air bubbles that will clear after a short period.

Figure 2

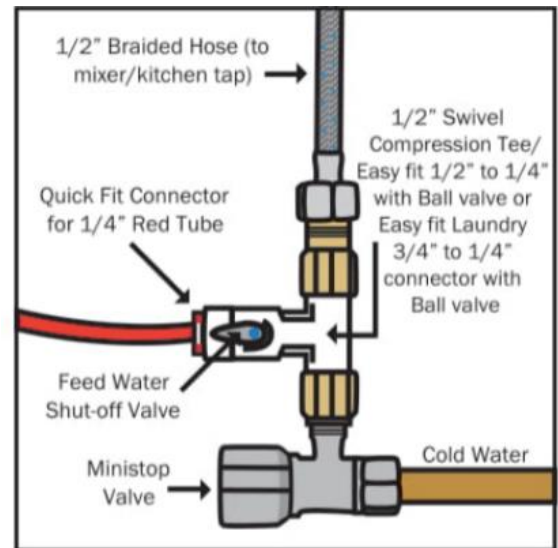
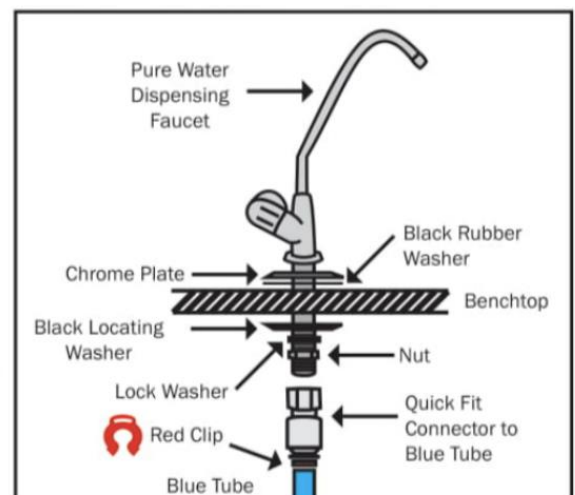

Figure 3



CARTRIDGE INSTALLATION/MAINTENANCE

To change the filter cartridges, adhere to the following procedure.

1. Close 1/2" Tee with 1/4" Push-In Tube Connector (Mains Connector or Shut Off Valve) to prevent water flow.
2. Relieve water pressure by operating faucet lever.
3. Unscrew filter housing sump using the spanner wrench and discard cartridges. When removing housings place a container underneath to catch any spillage. (See Fig 5)

Figure 5

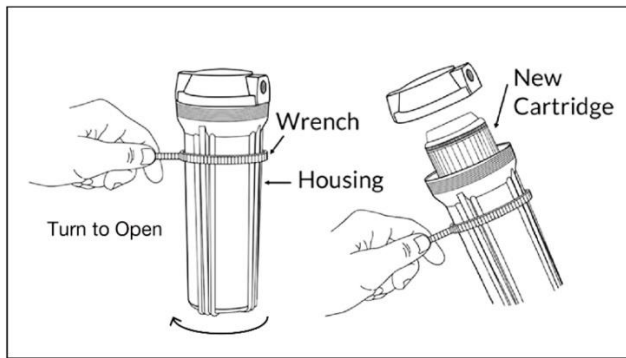
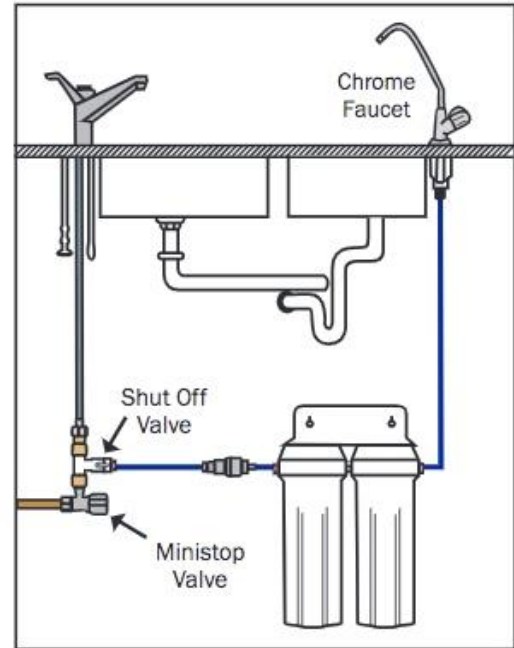

Figure 4



4. Cleanse the inside of the housing using warm water. Check O-ring and lubricate with food grade silicone lubricant or similar. Replace O-ring if kinked or damaged (Part No: ORG-STD). (See Fig 6)

Figure 7

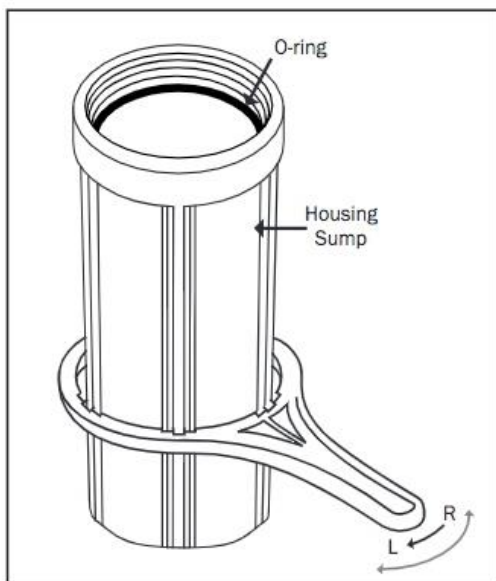
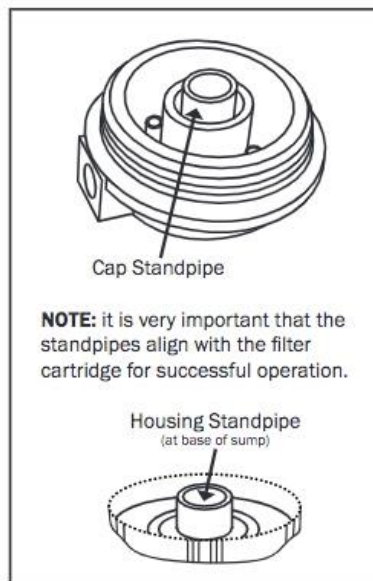
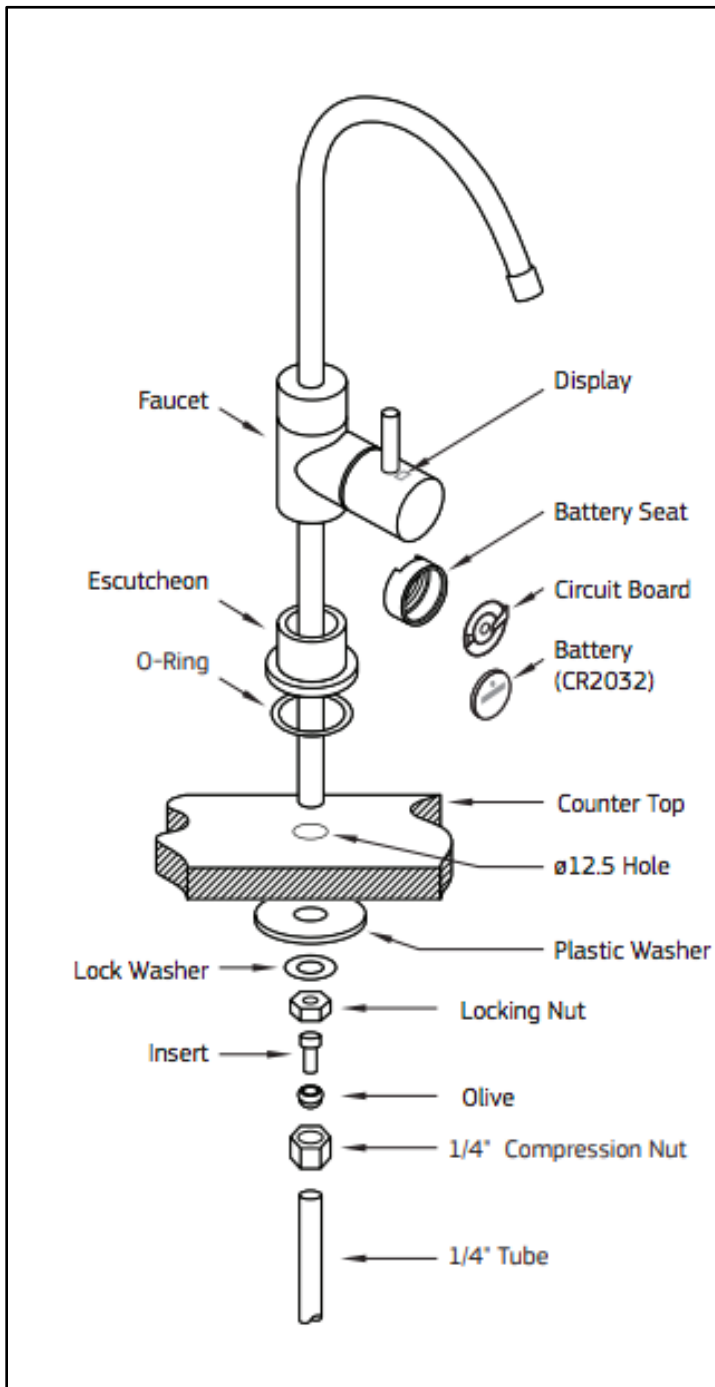

Figure 6



5. Install new cartridges and replace housing screwing them up **HAND TIGHT ONLY**. Sediment filter is on the inlet side and chemical on the outlet side.
6. Reset LED indicator by following instructions on page 7.
7. Restore water supply & check for leaks, rectifying any before leaving the unit. After installing cartridges flush unit for 5 - 10 minutes.

Figure 8 – Faucet Installation Diagram



Important note: Battery must be replaced when changing cartridges.

FAUCET INSTALLATION PROCEDURE

1. Remove the black battery seat from the faucet lever handle (see Figure 9).
2. Install battery into the battery seat, positive side up, discard plastic insert

Figure 9

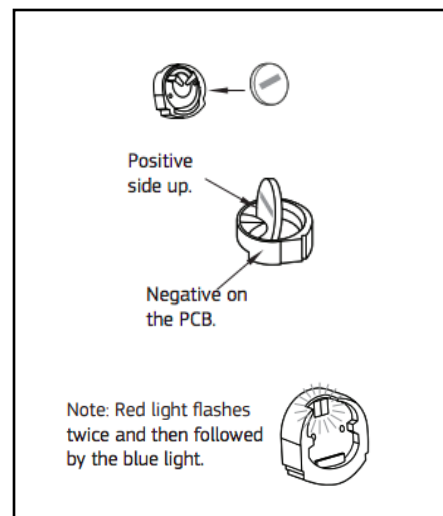

3. Reinstall battery seat assembly into the faucet lever, battery side facing outwards.

Figure 10

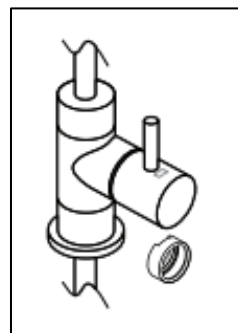
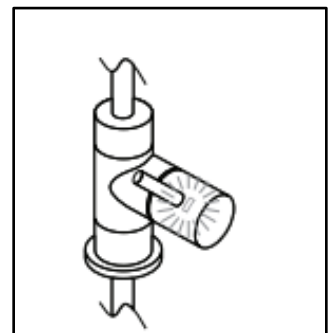

Figure 9



WARNING! THIS PRODUCT CONTAINS A BATTERY. ACCIDENTAL INGESTION MAY OCCUR AND CAN BE FATAL. PLEASE KEEP OUT OF REACH FROM INFANTS. IF YOU SUSPECT AN ACCIDENTAL INGESTION PLEASE CONTACT EMERGENCY SERVICES.

4. Blue light flashes during normal operation.
5. Red light flashes indicates your cartridges are due to be changed (usage has exceeded 12 months). Please change the battery when changing the cartridges.

GUIDE TO USE PUSH-IN TUBE CONNECTORS

Figure 12

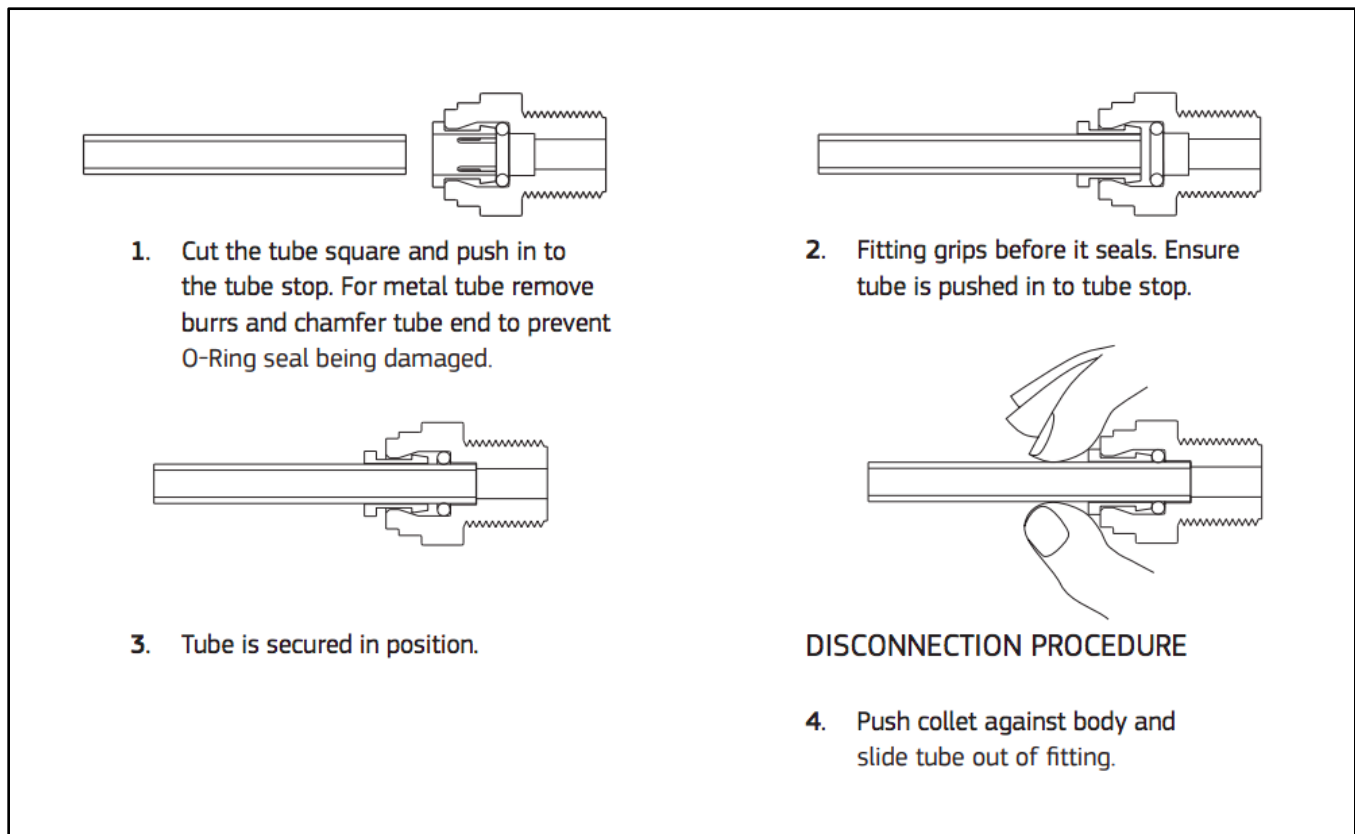

USE GUIDELINES

- Minimum operating pressure 200 kPa.
- Maximum operating pressure 520 kPa.
- Do not allow exposure to temperatures below 0°C.
- Maximum operating temperature 38°C.
- Nominal flow rate 4 Lpm.
- This system must be installed according to local plumbing codes on the cold water line.
- Replacement Cartridges: See Cartridge replacement section
- This system requires regular replacement of the filter cartridge to maintain proper operation. Varying chlorine, sediment, or organic substance levels may affect replacement frequency.
- Be sure to change the filter cartridge at least every 12 months; or whenever you detect a change in taste, odour, or decrease in flow.
- When replacing cartridge, ensure you reset the LED reminder light by removing/replacing the battery from the rubber seat. Please refer to page 8 for a detailed diagram.

Caution: Do not use with water that is microbiologically unsafe or of unknown quality without adequate disinfection before or after the system.

CARTRIDGE REPLACEMENT GUIDE

You can obtain replacements from your local AquaCo dealer. To maintain performance, warranty and standards use genuine AquaCo replacements.

Figure 10



Product Code: SYS-925

TO MAINTAIN THE HIGH QUALITY OF THE PURIFIED WATER THE CARTRIDGE(S) NEED CHANGING EVERY 6-18 MONTHS (THIS IS DEPENDENT ON WATER QUALITY AND USAGE). YOU CAN OBTAIN REPLACEMENT CARTRIDGES FROM YOUR LOCAL AQUACO STOCKIST. TO MAINTAIN PERFORMANCE AND WARRANTY USE GENUINE AQUACO REPLACEMENTS.

PERFORMANCE DATA SHEET

PRODUCT CODE: CB-925-1POP

CARBON FILTER

Micron Rating	>99% @ 1 µm
Filter Dimensions	9" x 2.5"
Chlorine Reduction >95%	30,000 L @ 0.75 gpm
Lead Reduction >90%	11,300 L @ 0.75 gpm
Cyst, Cryptosporidium, Giardia Reduction >99.95%	>99.99%
Initial _P	>5.0 psid @0.75 gpm
Carbon Weight	0.80 lbs.
Carbon Type	Activated Coconut Shell Carbon

NOTES: CHLORINE AND LEAD REDUCTION CAPACITIES ARE BASED ON LABORATORY TESTING CONDUCTED USING TEST PROTOCOL CONTAINED IN NSF STANDARDS 42 AND 53 RESPECTIVELY.

PRODUCT CODE: FL-925-OP

FLUORIDE FILTER

Filter Dimensions	9" x 2.5"
Fluoride Reduction >90%	2,200 L @ 0.5 gpm
Media Type	Activated Aluminum Oxide

** GIVEN THE FLUORIDE CONTENT OF WATER UP TO 1 MG/L

ABA-2000FL IS A NEW IMPROVED HIGH YIELD ACTIVATED ALUMINUM OXIDE SPECIALLY FORMUALTED FOR REMOVAL OF FLUORIDE FROM RINKING WATER.

TESTED USING FLOW RATE = 0.5 GPM; PRESSURE = 60 PSIG; PH = 7.5 _ 0.5; TEMP. = 20 _ 2.5_ C

PRODUCT CODE: ARA-925
ARAGON FILTER

Micron Rating	>100% @5 µm
Filter Dimensions	9" x 2.5"
Suspended impurities (rust, sand, algae, other particles) over 5 µm	100%
Heavy and radioactive metals (lead, cadmium, copper, strontium-90, caesium)	>99%
Active chlorine	>100%
Organic compounds	>92%
Hardness salts	>85%
Microorganism and coliform bacillus	>99%
Hepatitis A virus, rotaviruses and Noroviruses	>99%
Capacity	7,000 L @0.3 mg/l of iron 35,000 L @0.06 mg/l of iron

* **DEPENDS ON CONTAMINATION DEGREE OF INITIAL WATER**** **GIVEN THE IRON CONTENT OF WATER UP TO 1 MG/L WITH CONSIDERATION FOR REGENERATION***** **AT HARDNESS UP TO 3 MG-EQ/L WITH CONSIDERATION FOR REGENERATION**

This is confirmed by:

- Certified by Institut Pasteur de Lille (France)
- Certified by S.M Kirov Military Medical Academy (Russia)
- Certified by The Research Institute of Influenza (Russia)
- Certified by V.G Khlopin Radium Institute (Russia)
- Certified by The Research Institute of Epidemiology and Microbiology (Russia)
- Certified by IFTS (France)
- Certified by IAPMO (United States)
- Certified by University of Ferrara (Italy)

In accordance with the test report based on the filtration of the artificially contaminated ultra-clean water, the GEYSER ARAGON BIO filters are capable to remove the bacterial and viral contamination with the following parameters:

- Legionella pneumobilia, Serogroup 1 (CIP 103854): mean removal efficiency 99.99987 % (5.9 log)
- Salmonella Typhimurium (ATCC 14028): mean removal efficiency 99.998 % (4.8 log)
- Poliovirus, Sabin Strain of Type 1: mean removal efficiency 99.84 % (2.8 log)
- Rotavirus, Simiens Strain SA114F1: mean removal efficiency 99.99 % (4.0 log)
- Hepatitis A virus, Strain HM175/18f (ATCC VR-1402): mean removal efficiency 96 % (1.4 log)

NOTES

AquaCo water care products are designed, manufactured and supported by Water Filters Pty Ltd the name you can trust for viable and proven water solutions. The complete range of AquaCo products are developed, refined, made to meet and exceed stringent specifications for the worldwide market.

Important: Sales of products are subject to our Terms and Conditions which are available upon request. All specifications, information and photos are a guide only and are subject to change without notice. Please ring to confirm details. Warning: For correct operation of this appliance it is essential to observe manufacturer's instructions.

WARRANTY

Any claim under this warranty must be made within 5 years of the date of purchase of the product. This product is warranted to be free of defect of material and workmanship for 5 years from date of purchase. 5 year warranty is 1 year parts and labour, plus 4 years parts only.

To make a claim under the warranty, take the product and proof of purchase to place where you purchased the product, and they will lodge a Warranty Request with AquaCo.

AquaCo will pay your reasonable, direct expenses of claiming under this warranty. You may submit details and proof of your expense claim to place of purchase for consideration.

The warranty only applies if the product was used and/or installed in accordance with the user guide and/ or installation instructions. This warranty is given in lieu of all other express or implied warranties and manufacturer shall in no circumstance be held liable for damages consequential or otherwise or delays caused or faulty manufacturing except as excluded by law.

Applicable to all above, is that the Warranties need to be approved by AquaCo to ensure product was not incorrectly used, installed or claimed. False and incorrect claims will be pursued at AquaCo's discretion, including chargeable inspection and labour costs incurred.

All installation and service work should be completed by qualified tradespeople. Faulty operation due to unqualified persons will result in voided warranty coverage.

Use PTFE thread seal tape on all connections. Use of liquid pipe sealant/dope will void warranty.

WARRANTY/AUSTRALIA

This warranty is given by Water Filters Pty Ltd, ABN 68618671677, telephone no. 08 6156 0220 and email at sales@waterfilter.com.au.

This warranty is provided in addition to other rights and remedies you have under law: Our goods come with guarantees which cannot be excluded under the Australian Consumer Law. You are entitled to replacement or refund for a major failure and to compensation for other reasonably foreseeable loss or damage. You are also entitled to have the goods repaired or replaced if the goods fail to be of acceptable quality and the failure does not amount to a major failure.