



FRUIT FLY TRAP

Attracts Fruit Flies Fast
Dual Lure System

Fruit Fly Lure Liquid
+ Special Lure Capsule Inside

Easy-To-Use
Made In The USA

2 TRAPS
60 DAY
SUPPLY*

*Using half (0.5 fl oz) of the liquid per trap.



WOMEN
OWNED
NWBOC CERTIFIED

CONTENTS: 2 TRAPS, 2 CAPSULES (0.15 OZ),
1 FL OZ FRUIT FLY LURE LIQUID

Our innovative, Maggie's Farm Fruit Fly Trap is designed to discreetly lure and capture fruit flies. Maggie's Farm Fruit Fly Trap is unique! It uses a dual capsule and liquid attraction system. The capsule which is preplaced inside the trap is activated when the Fruit Fly Lure liquid is added to the trap.

Package Contents: 2 Fruit Fly Traps, 2 Capsules (one inside each trap) and 1 Tube of Liquid (to be divided between the two traps).

Filling and Activating the Traps:

1. **Push the tip of tube through the hole on top of the trap.** If the hole tab is not completely cut out, pushing the tube tip through the pre-cut hole will open it up.
2. **Squeeze about half of the tube of the liquid in the Fruit Fly Lure tube (about 0.5 fl oz) into the hole of the trap to activate it.** (See Fig. A)
3. **To enhance capture efficiency, add one drop of standard dish soap (any brand) to the trap** (See Fig. B)
4. **Just in case:** If you run out of the Fruit Fly Lure liquid (you used more than half in the first trap, had a spill or the tap dries out etc.), try adding a tablespoon of real apple cider vinegar or red wine vinegar to the trap.
5. **Each trap will work for up to 30 days.** Discard the trap after 30 days.

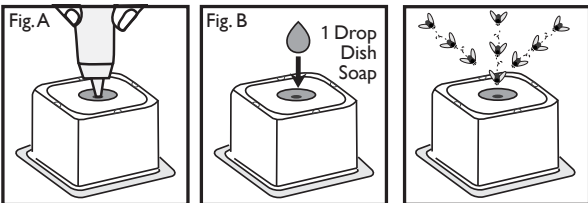

Placement of Traps:

- Place traps in areas near the fruit fly problem (i.e. common problem areas found are around kitchen fruit bowls, around sinks, dishwashers and garbage areas.) Place traps on or under counters, sinks, or near unrefrigerated fruits/vegetables.
- Place traps where they won't be disturbed.
- If using two traps at once, we recommend spacing them at least three feet apart.

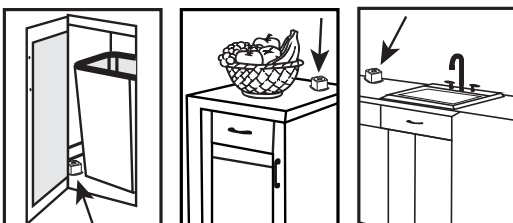

Storage: Store unused product in original container, in a cool, dry place.

Disposal: Discard traps and any unused liquid in trash.

Precautions: Do not allow children to play with traps. Liquid may cause eye irritation. Keep away from eyes. If liquid gets on hands, wash hands with soap and water. If liquid gets in eyes, rinse carefully with water and contact a doctor if any irritation persists.

Limitations of Liability: Maggie's Farm Ltd makes no warranties of merchantability or fitness for any purpose except expressed on this label. Buyer assumes all responsibility for safety and use not in accordance with label directions and precautions.

Info, Questions or Comments:

Visit www.maggiesfarmproducts.com or scan the QR code.



Manufactured by:

Maggie's Farm Ltd
1257 Bedford Ave
Kansas City, MO 64116
(816) 379-5387
EPA Est. No.: 73079-MO-1

©2024 Maggie's Farm™, Simply Effective™ and Green Zone™ are trademarks of Maggie's Farm Ltd. Green Zone is not a third party certification.