



YOUR NEW ZEALAND MANUFACTURED ORGANIC SOLUTION
TO A CLEAN GREEN ENVIRONMENT

SANITARY HYGIENE UNIT - INSTRUCTION GUIDE

SANITARY HYGIENE BASE UNIT ASSEMBLY GUIDE

TO BE ASSEMBLED AT BRANCH

- Use bench or floor with soft surface to put together
- Be careful not to damage unit



WHERE TO PUT LABELS ON HYGIENE UNITS

- Adhere "How to dispose" label to Unit, above Rim
- Adhere Carbon Foot Print Label, under Rim



SANITARY HYGIENE UNIT SERVICING GUIDE

STEP 1 Insert cartridge into top of base with opening facing forward.



STEP 2

- Remove by holding the cartridge, **not** liner.
- When servicing, dispose of cartridge into black recycled bag for landfill.
- Replace with **new** cartridge which has new modesty flap on **EVERY** service as required.



Bio-Zyme NZ LTD

88 Treffers Road, Wigram Park - Christchurch
0800 24 69 963 | office@bio-zyme.co.nz

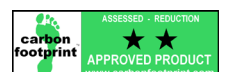

HYGIENE UNIT - INSTALLATION OPTIONS GUIDE

Tools/Items required: - 4x self tapping screws - Double sided foam tape (optional if required)
- 4x wall plugs - Plinth

Option 1 - **Directly Screw into Wall**

Compulsory Bottom Bracket

STEP 1 Screw or double sided foam tape to wall approx. 100mm or 4" from floor.

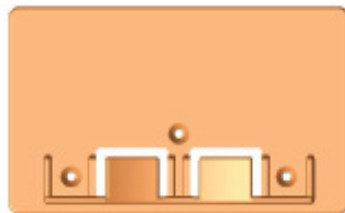

STEP 2 Fit base into bottom bracket and screw top of unit (marked x) to wall using wall plugs as required, or optional bracket.



Option 2 - **Double Sided Tape to Wall**

Optional top brackets. Only required when screw fixing in step two is not desirable

ie. tiled surface

Double side tape B1 to top of base.
Fit B2 into B1, double side foam tape back to B2 and fix against wall.

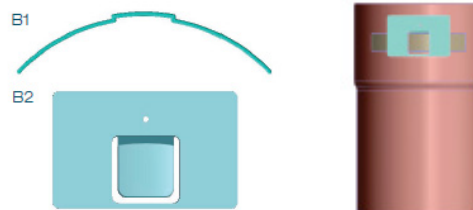

Option 3 - **Free Standing Plinth**

Fit Plinth attached to bottom of Hygiene Unit.

