

## GYEON QUARTZ PAINT COATINGS MANUAL

Congratulations on choosing one of GYEON high quality quartz coatings. With this user manual we would like to share with you basic tips on surface preparation and application to ensure your full satisfaction and safety of work.

### SURFACE PREPARATION:

Proper surface preparation is crucial for the bonding and durability of the installed coating. Always mind these simple rules:

- the surface should be decontaminated and free of any residue;
- old waxes, glazes or coatings should be stripped before proceeding;
- scratches, swirls marks, holograms should be removed by machine polishing;
- paintwork needs to be fully degreased. Wash the car with a highly degreasing liquid and use **Q<sup>2</sup>M PREP** before coating. This step is obligatory!

### TECH-FACTS AND APPLICATION TIPS:

Never apply a coating outside a garage or detailing studio.  
Never work in direct sunlight/outside.  
Ensure the area you work is well ventilated.

There are two major factors influencing the work with coatings - temperature and humidity. The higher the temperature and/or humidity, the quicker the coatings flashes and cures. The initial bonding time of a ceramic coating with the surface is only a few seconds. Don't wait, wipe off immediately. Work in small sections, splitting panels in maximum 50x50cm areas.

Use correct lighting. Apply the coating using reflected light. Point your lamp at the wall or ceiling - this will help you spot possible smudges. React quickly, remove them immediately.

Use an appropriate amount of quality microfibre towels for wipe off. 2 microfibrils for each layer are a minimum. Swap sides of the MF during work. A final wipe with the **Q<sup>2</sup>M SUEDE** towel is highly advised.

Ensure the car stays in stable conditions without the risk of rainfall or rapid humidity changes. Always respect individual product application instructions.

### PRECAUTIONS:

- Skin protection recommended.
- Work in a well-ventilated area.
- Store in a dark, dry and cool place.
- Keep out of reach of children.
- Avoid applying in direct sunlight.

## Q<sup>2</sup> ONE

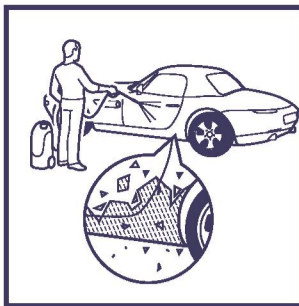

Pre-wash the car with **Q<sup>2</sup>M FOAM**. Wash the car with a strong degreasing agent.

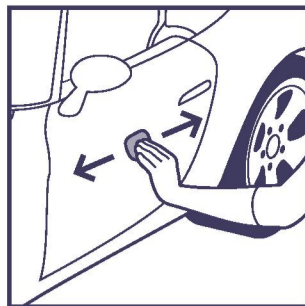

Decontamination with the use of **Q<sup>2</sup>M TAR, Q<sup>2</sup>M IRON & Q<sup>2</sup>M CLAY** is recommended.

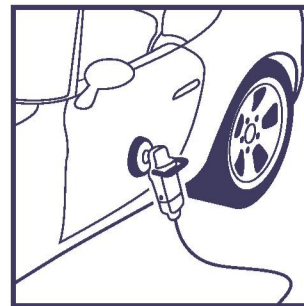

If the car is scratched, make sure paint correction is performed first by a professional detailing shop. Remember to remove all factory sealing from new cars.

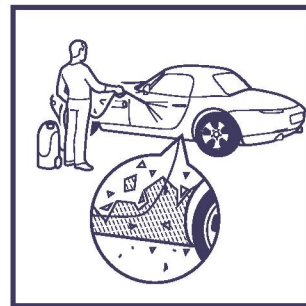

Always wash the car with a highly degreasing agent. Hot water and the use of a dishwashing liquid are recommended.

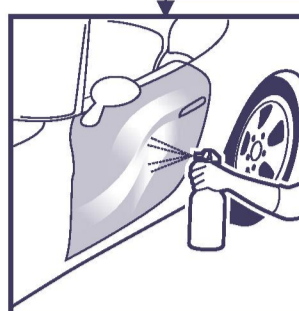

Ensure the surface is oil free and completely dry. Use **Q<sup>2</sup>M PREP** before applying the coating (isopropyl alcohol does not fully degrease the surface).

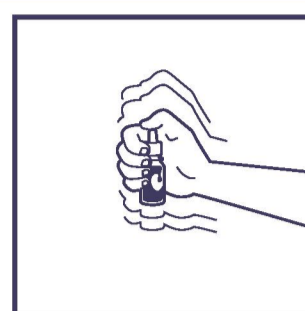

Shake the **Q<sup>2</sup> ONE** bottle before use.

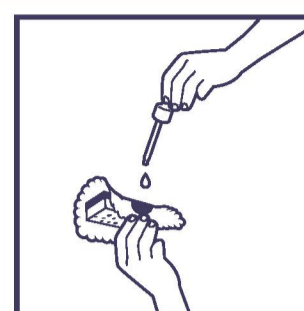

Apply a thick layer of **Q<sup>2</sup> ONE** in a criss cross motion. Pay attention to the leveling of the coating. If needed, do a second criss cross application to achieve a perfectly even layer.



Split larger panels (roof, bonnet, SUV doors) into sections, apply carefully.



Wipe off immediately (10 – 30 seconds) after applying on the whole panel/section.

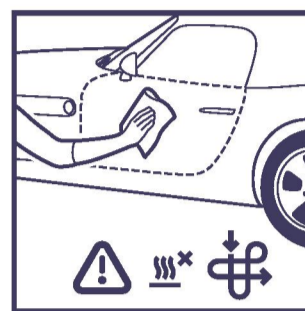

Please note that the wipe off time may vary depending on the country's climate (ask your supplier for advice). Work panel by panel/section by section, do not allow to fully dry.

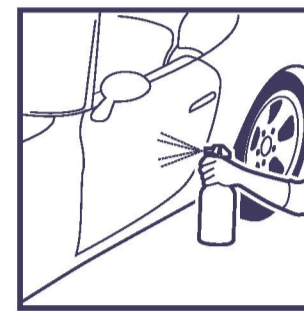

Let the coating dry for at least 1 hour. Wipe off with **Q<sup>2</sup>M CURE** before starting use of the car. Apply **Q<sup>2</sup>M CURE** with a soft MF. Spray **Q<sup>2</sup>M CURE** onto the MF and not directly onto the paint/coating. Do not allow any streaks to be left. Work in sections, panel by panel.

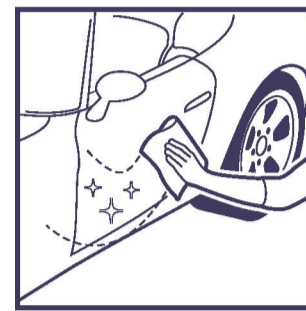

The coat is fully dry after 24 hours. Only after that time can the car be driven. Do not wash the car with any detergents within the first 14 days. If the car becomes contaminated, contact your distributor for advise.

## Q<sup>2</sup> PURE

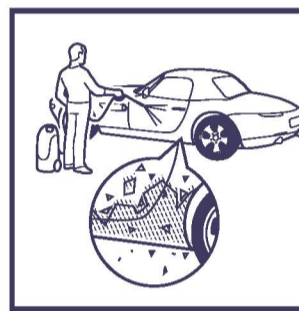

Pre-wash the car with **Q<sup>2</sup>M FOAM**. Wash the car with a strong degreasing agent.

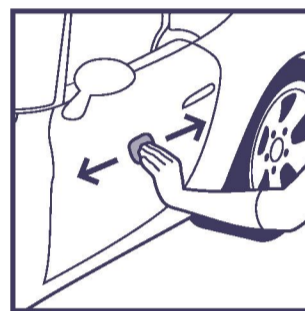

Decontamination with the use of **Q<sup>2</sup>M TAR, Q<sup>2</sup>M IRON & Q<sup>2</sup>M CLAY** is recommended.

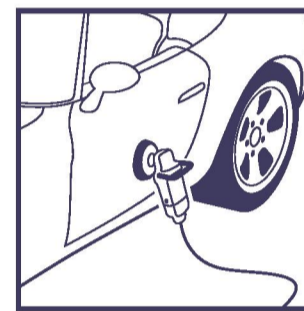

If the car is scratched, make sure paint correction is performed first by a professional detailing shop. Remember to remove all factory sealing from new cars.

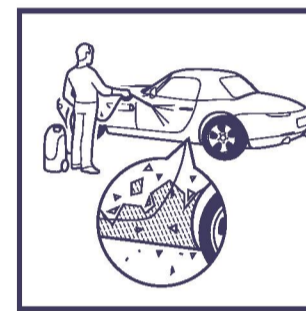

Always wash the car with a highly degreasing agent. Hot water and the use of a dishwashing liquid are recommended.

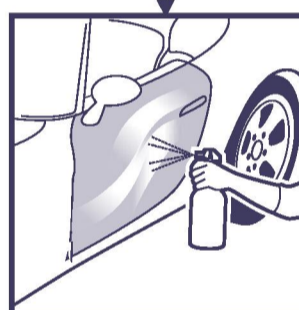

Ensure the surface is oil free and completely dry. Use **Q<sup>2</sup>M PREP** before applying the coating (isopropyl alcohol does not fully degrease the surface).

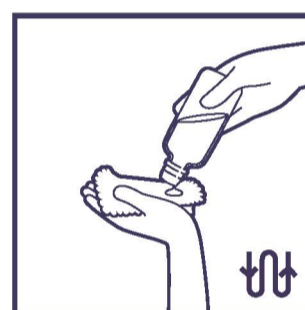

Apply a large dot of the coating on one side of the applicator. Apply **Q<sup>2</sup> PURE** in a straight line motion.

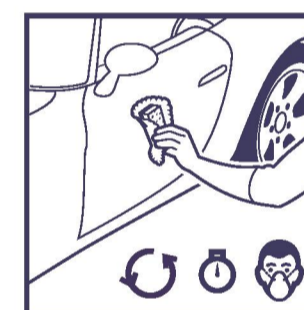

Wait until the coating starts to flash (approx. 30 sec) and level the product in circular motion. Work until an even haze appears on the surface. Do not add any more product to the applicator.

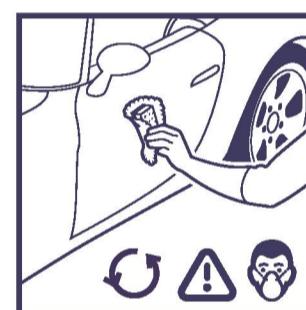

The circular movement is crucial for an easy and straight forward wipe off. It has also a very important leveling function.



Wipe off immediately after applying to the whole panel/section with the **Q<sup>2</sup>M SOFTWIPE** in circular motion, changing the side of the MF during work.

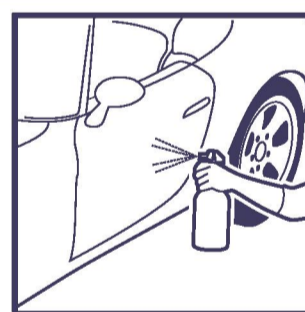

Let the coating dry for at least 1 hour. Wipe off with **Q<sup>2</sup>M CURE** before starting use of the car. Apply **Q<sup>2</sup>M CURE** with a soft MF. Spray **Q<sup>2</sup>M CURE** onto the MF and not directly onto the paint/coating. Do not allow any streaks to be left. Work in sections, panel by panel.

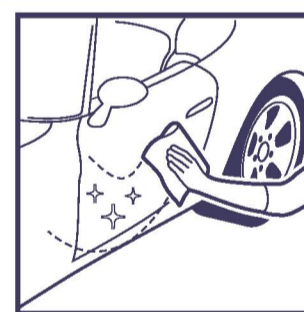

The coat is fully dry after 24 hours. Only after that time can the car be driven. Do not wash the car with any detergents within the first 14 days. If the car becomes contaminated, contact your distributor for advise.

## Q<sup>2</sup> MOHS



Pre-wash the car with **Q<sup>2</sup>M FOAM**. Wash the car with a strong degreasing agent.

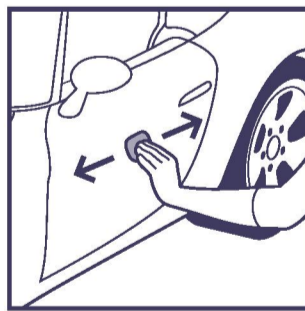

Decontamination with the use of **Q<sup>2</sup>M TAR, Q<sup>2</sup>M IRON & Q<sup>2</sup>M CLAY** is recommended.

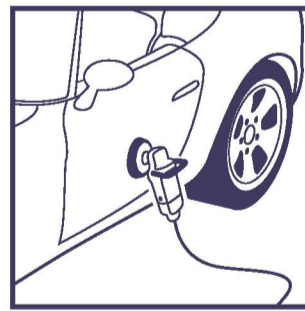

If the car is scratched, make sure paint correction is performed first by a professional detailing shop. Remember to remove all factory sealing from new cars.

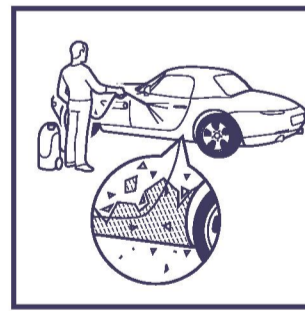

Always wash the car with a highly degreasing agent. Hot water and the use of a dishwashing liquid are recommended.

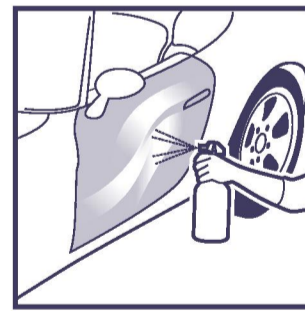

Ensure the surface is oil free and completely dry. Use **Q<sup>2</sup>M PREP** before applying the coating (isopropyl alcohol does not fully degrease the surface).

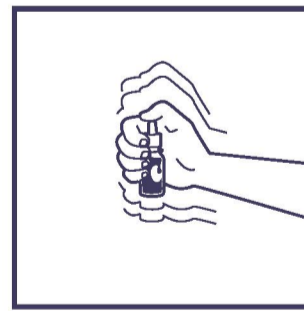

Shake the **Q<sup>2</sup> MOHS** bottle before use.

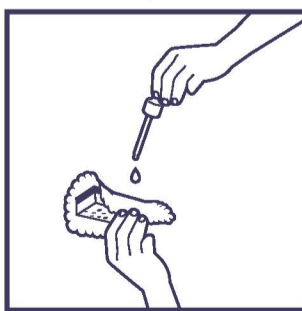

Apply a thick layer of **Q<sup>2</sup> MOHS** in a criss-cross motion. Pay attention to the leveling of the coating. If needed, do a second criss cross application to achieve a perfectly even layer.



Split larger panels (roof, bonnet, SUV doors) into sections, apply carefully.

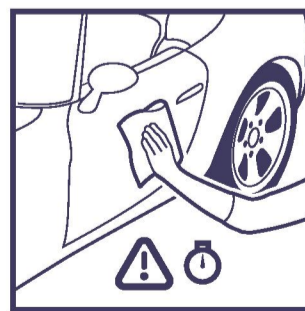

Wipe off immediately (10 – 30seconds) after applying on the whole panel/section. Wipe off carefully, do not leave any streaks or smudges. Please note that the drying time may vary depending on a country's climate (ask your supplier for advice). Apply at least one more coat after a minimum of 1 hour. Each additional coat increases thickness and hardness. Apply a maximum of 3 layers of **Q<sup>2</sup> MOHS**.

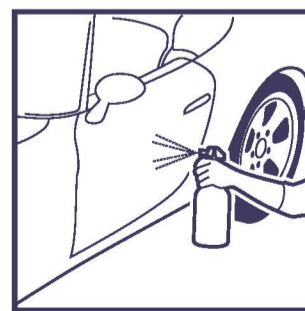

Let the coating dry for at least 12-24 hours. Wipe off with **Q<sup>2</sup>M CURE** before starting use of the car. Apply **Q<sup>2</sup>M CURE** with a soft MF. Spray **Q<sup>2</sup>M CURE** onto the MF and not directly onto the paint/coating. Do not allow any streaks to be left. Work in sections, panel by panel.

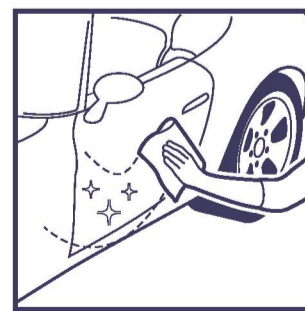

In hot, rainy climates, we recommend finishing the bonnet, roof and boot lid with an HD natural wax after at least 12-24 hours to protect the coating against potential water spots while curing completely for 2-3 weeks.

The coating is fully dry after 24 hours. Only after that time can the car be driven.

The drying process can be accelerated if the coating is heated with infrared lamps, 10 minutes per panel. Do not wash the car with any detergents within the first 14 days.

## Q<sup>2</sup> SYNCRO

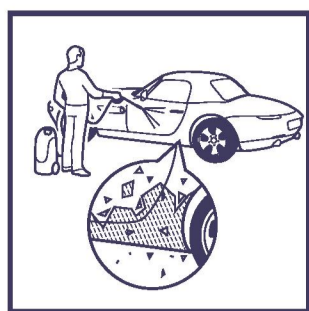

Pre-wash the car with **Q<sup>2</sup>M FOAM**. Wash the car with a strong degreasing agent.

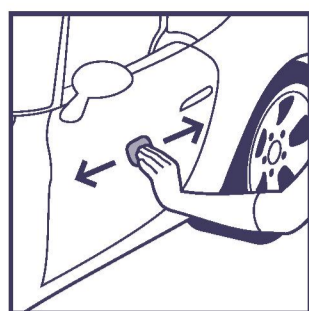

Decontamination with the use of **Q<sup>2</sup>M TAR, Q<sup>2</sup>M IRON & Q<sup>2</sup>M CLAY** is recommended.

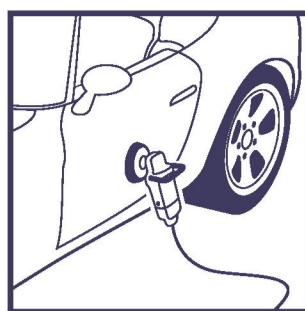

If the car is scratched, make sure paint correction is performed first by a professional detailing shop. Remember to remove all factory sealing from new cars.

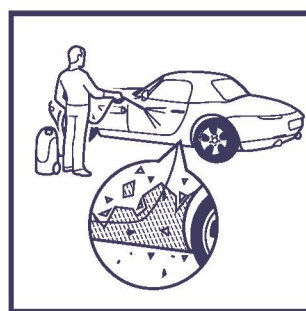

Always wash the car with a highly degreasing agent. Hot water and the use of a dishwashing liquid are recommended.

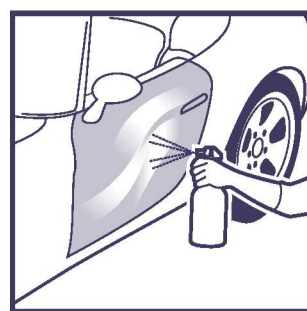

Ensure the surface is oil free and completely dry. Use **Q<sup>2</sup>M PREP** before applying the coating (isopropyl alcohol does not fully degrease the surface).

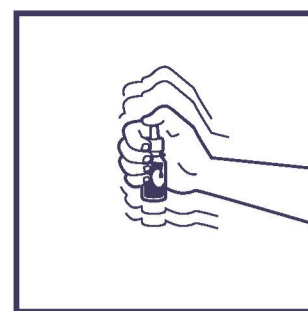

Shake the **Q<sup>2</sup> MOHS** bottle before use.

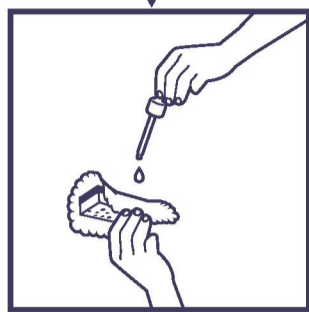

Apply a thick layer of **Q<sup>2</sup> MOHS** in a criss cross motion. Pay attention to the leveling of the coating. If needed, do a second criss cross application to achieve a perfectly even layer.



Split larger panels (roof, bonnet, SUV doors) into sections, apply carefully.



Wipe off immediately (10 – 30seconds) after applying on the whole panel/section. Wipe off carefully, do not leave any streaks or smudges. Please note that the drying time may vary depending on a country's climate (ask your supplier for advice). Apply at least one more coat after a minimum of 1 hour. Each additional coat increases thickness and hardness. Apply a maximum of 3 layers of **Q<sup>2</sup> MOHS**

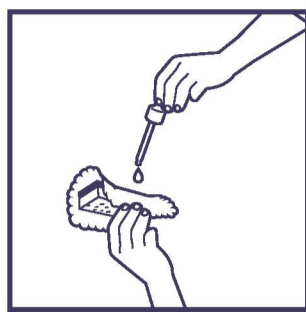

Apply a thick layer of **Q<sup>2</sup> SKIN** after a minimum of 4 hours. Apply in a criss-cross motion. Wipe off immediately and carefully, do not leave any streaks or smudges. Split larger panels (roof, bonnet, SUV doors) into sections, apply carefully.

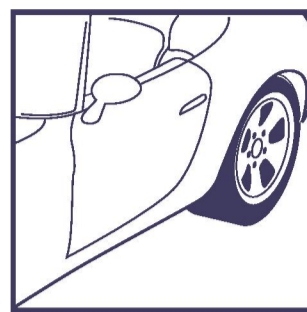

Let the coating dry for at least 12hours. There is no necessity to apply **Q<sup>2</sup>M CURE**, although it remains an excellent maintenance product.

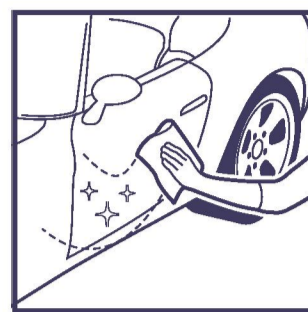

The coating is fully dry after 12 hours. Only after that time can the car be driven.

The drying process can be accelerated if the coating is heated with infrared lamps, 10 minutes per panel after the application of **Q<sup>2</sup> SKIN**. Do not wash the car with any detergents within the first 14 days.

## Q<sup>2</sup> MATTE

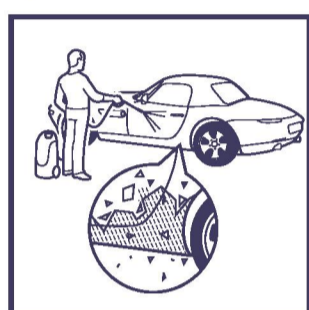

Pre-wash the car with **Q<sup>2</sup>M FOAM**. Wash the car with a strong degreasing agent.

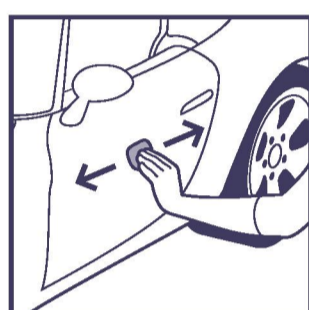

Decontamination with the use of **Q<sup>2</sup>M TAR, Q<sup>2</sup>M IRON & Q<sup>2</sup>M CLAY** is recommended.

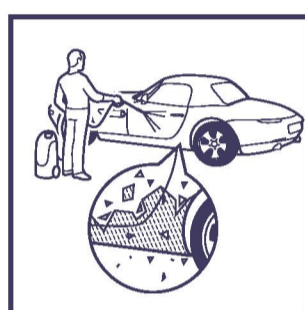

Always wash the car with a highly degreasing agent. Hot water and the use of a dishwashing liquid are recommended.

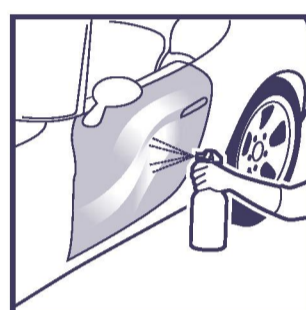

Ensure the surface is oil free and completely dry. Use **Q<sup>2</sup>M PREP** before applying the coating (isopropyl alcohol does not fully degrease the surface).



Shake the **Q<sup>2</sup> MATTE** bottle before use.

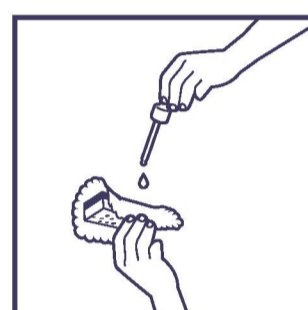

Apply a thick layer of **Q<sup>2</sup> MATTE** in a criss cross motion. Pay attention to the leveling of the coating. If needed, do a second criss cross application to achieve a perfectly even layer.



Split larger panels (roof, bonnet, SUV doors) into sections, apply carefully.



Wipe off immediately (10 – 30seconds) after applying on the whole panel/section.

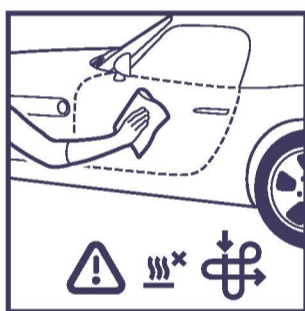

Please note that the wipe off time may vary depending on the country's climate (ask your supplier for advice). Work panel by panel/section by section, do not allow to fully dry.

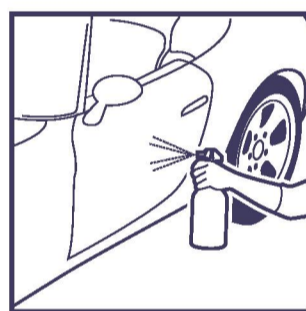

Let the coating dry for at least 12-24 hours. Wipe off with **Q<sup>2</sup>M CURE MATTE** before starting use of the car. Apply **Q<sup>2</sup>M CURE MATTE** with a soft MF. Spray **Q<sup>2</sup>M CURE MATTE** onto the MF and not directly onto the paint/coating. Do not allow any streaks to be left. Work in sections, panel by panel.

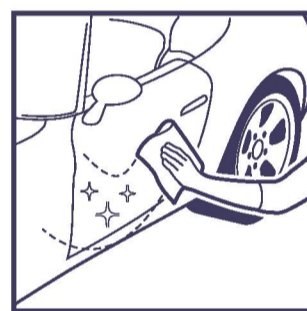

The coat is fully dry after 24 hours. Only after that time can the car be driven. Do not wash the car with any detergents within the first 14 days. If the car becomes contaminated, contact your distributor for advice.

## Q<sup>2</sup> PPF

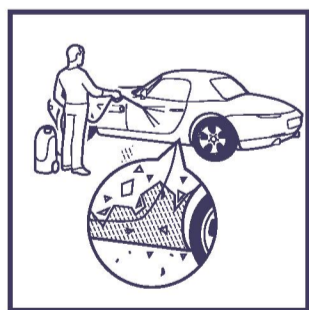

Pre-wash the car with **Q<sup>2</sup>M FOAM**. Wash the car with **Q<sup>2</sup>M PPF WASH** to ensure a fully chemical decontamination.

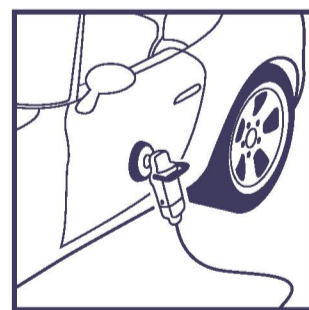

If the ppf is scratched, oxidized or contaminated, make sure to polish it with **Q<sup>2</sup>M PPF RENEW** before the application of **Q<sup>2</sup> PPF**.

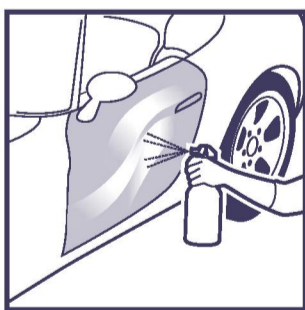

Ensure the surface is completely dry and well prepared. If **Q<sup>2</sup>M PPF RENEW** has not been used, wipe with **Q<sup>2</sup>M PREP**.

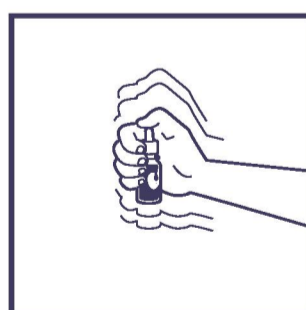

Shake the **Q<sup>2</sup> PPF** bottle before use.

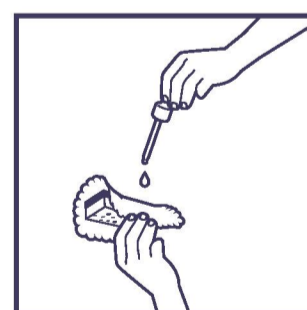

Apply a thick layer of **Q<sup>2</sup> PPF** in a criss cross motion. Pay attention to the leveling of the coating. If needed, do a second criss cross application to achieve a perfectly even layer.



Split larger panels (roof, bonnet, SUV doors) into sections, apply carefully.

## PRECAUTIONS:

- Skin protection recommended.
- Work in a well-ventilated area.
- Store in a dark, dry and cool place.
- Keep out of reach of children.
- Avoid applying in direct sunlight.

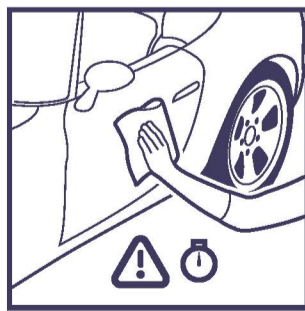

Wipe off immediately (10 – 30 seconds) after applying on the whole panel/section.

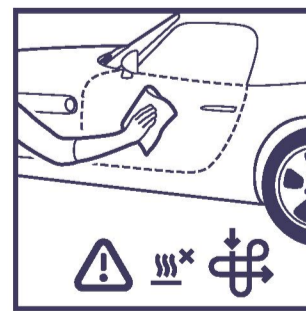

Please note that the wipe off time may vary depending on the country's climate (ask your supplier for advice). Work panel by panel/section by section, do not allow to fully dry.

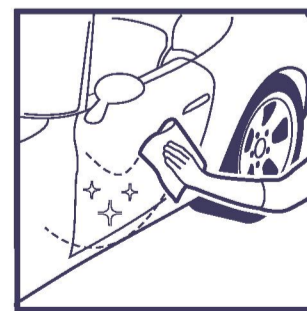

The coat is fully dry after 24 hours. Only after that time can the car be driven. Do not wash the car with any detergents within the first 14 days. If the car becomes contaminated, contact your distributor for advice.