



EUROSPEC

STEELWORX RESIDENTIAL CATALOGUE 2015



STEELWORX® Residential

Introduction

Eurospec was formed in 1997 as a subsidiary of Carlisle Brass specialising in the commercial sector of the architectural ironmongery market.

Steelworx was launched in 2005 to provide beautifully engineered stainless steel commercial door hardware for the specification market. The SWL range will provide a cost effective stainless steel solution that can be used both commercially or for residential projects.

Following the merger of Carlisle Brass Ltd and Eurospec in 2011 the brand has gone from strength to strength. Products include:

- High specification hinges
- Door control mechanisms
- Panic hardware
- Cylinder locks
- Mortice locks and latches

Carlisle Brass Ltd. is an ISO 9001 and ISO 14001 certified company, which means that Eurospec branded products are fully traceable from point of manufacture to customer and that the environmental impact is being constantly measured and improved.

Accredited products carrying the Eurospec brand are stringently tested to ensure they comply to the latest regulations, which makes Eurospec branded products the ideal choice for the professional installer, architect or specifier.



www.carlislebrass.com

STEELWORX® Residential

Contents



STEELWORX
CSLP1162

4



STEELWORX
CSLP1163

6



STEELWORX
CSLP1164

8



STEELWORX
CSLP1167

10

STEELWORX® Residential

Key to Finishes



BSS = Bright Stainless Steel



SSS = Satin Stainless Steel

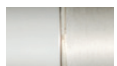

BSS/SSS = Dual Finish Stainless Steel

Care of Finishes

Stainless steel needs to be cleaned for aesthetic considerations and to preserve corrosion resistance. Stainless steel is protected by a thin layer of chromium oxide.

Oxygen from the atmosphere combines with chromium in stainless steel to form a passive chromium oxide film that protects from further corrosion. Any contamination of the surface by dirt or other material hinders this passivation process and traps corrosive agents, reducing corrosion protection. Thus some form of routine cleaning is necessary to preserve the appearance and integrity of the surface.

They actually thrive with frequent cleaning and, unlike some other materials, it is impossible to 'wear out' stainless steel by excessive cleaning. Stainless steel performs best when clean - cleanliness is essential for maximum resistance to corrosion.

Stainless steel products should be wiped over with a clean cloth and warm water with a mild detergent on a frequent basis. For more stubborn dirt or stains use mild, non-scratching abrading powders such as typical household cleaners. These can be used with warm water, bristle brushes, sponges or clean cloths. For more aggressive cleaning a small amount of vinegar can be added to the powder. Carbon steel brushes should be avoided as they may leave particles embedded in the surface, which can lead to rusting. Cleaning should always be immediately followed by rinsing in clean hot water and the surface then wiped completely with a dry towel.

The maximum recommendation for routine cleaning is once a month and more often in areas subject to heavy soiling or frequent use.

STEELWORX® Residential

Key to Symbols



FD 30/60

The UK Construction Products Regulations require that door hardware for use on fire doors be safe and durable.



BS EN 1906

BS EN 1906 is the British/European standard requirements and testing methods covering lever handles and knob furniture.



BS 8300 is the design of buildings and their approaches to meet the needs of disabled people.



10 Year Mechanical Guarantee.



GRADE 201

Grade 201 Stainless Steel.



DOMESTIC

Suitable for use in domestic environments.



COMMERCIAL

Suitable for use in commercial environments.

STEELWORX® Residential

Mitred



CSLP1162B
Lever on 172 x 42.5mm
Latch Backplate

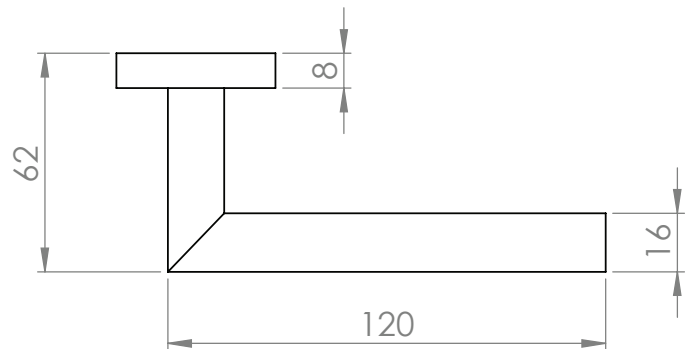
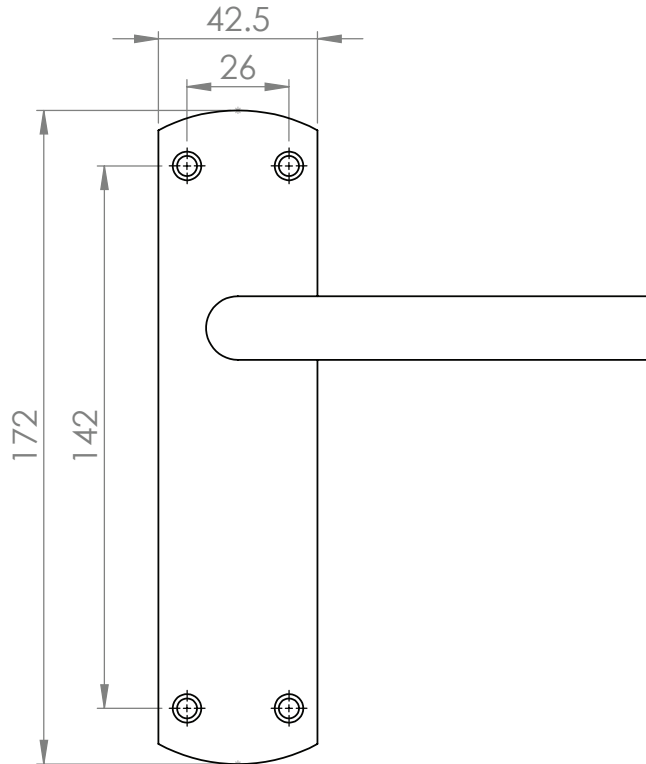

CSLP1162

PRODUCT USE

- Internal Residential
- Light Office Commercial







SPECIFICATION

- Lever handle length 120mm, Ø 16mm
- Lever projection 62mm
- Backplate 172mm x 42.5mm
- Sprung
- Tubular G201 Stainless Steel
- Groove Spindle 100 x 8 x 8mm
Grub Screw Fixing
- Matching SS Dome Pozi Screw
Fixings
- Screw size M3.8 x 19mm

FINISH

- Bright Stainless Steel
- Satin Stainless Steel

Category of use 2 EN1906
for use on fire-rated and smoke
protection doors to EN 1634

 COMMERCIAL	 DOMESTIC	 BSS SSS	
 GRADE 201	 MECHANICAL GUARANTEE	 BS EN 1906	 FD 30/60

STEELWORX® Residential

Mitred



CSLP1162E

Lever on 172 x 42.5mm Euro Backplate

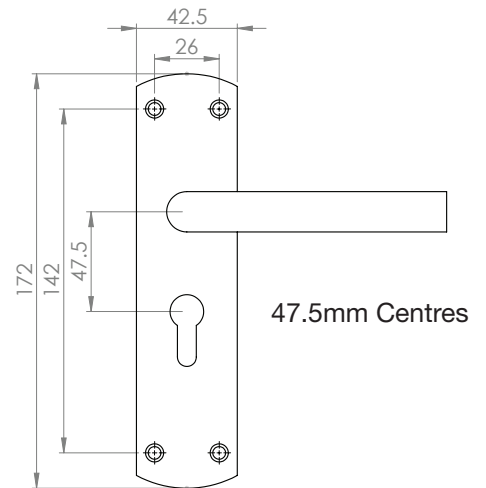

CSLP1162P

Lever on 172 x 42.5mm Lock Backplate

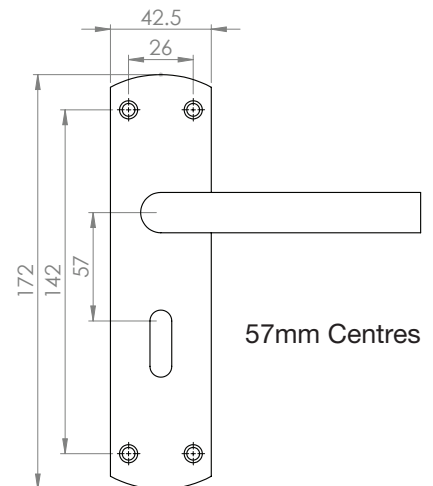

CSLP1162T

Lever on 172 x 42.5mm Bathroom Backplate

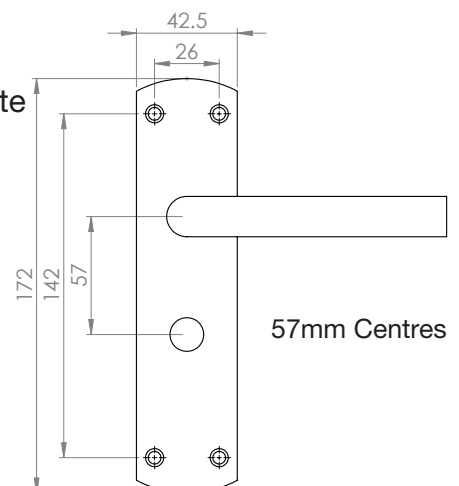

STEELWORX® Residential

Curved



CSLP1163BDUO
Lever on 172 x 42.5mm
Latch Backplate

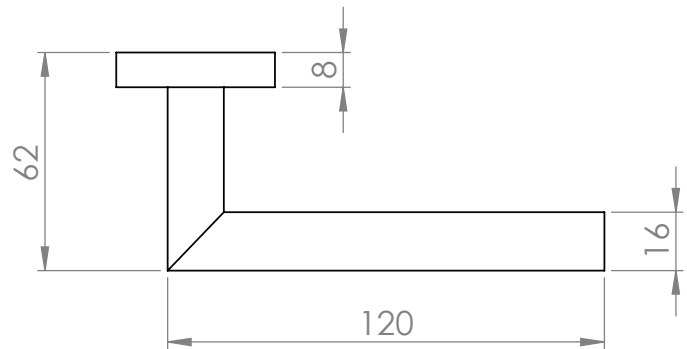
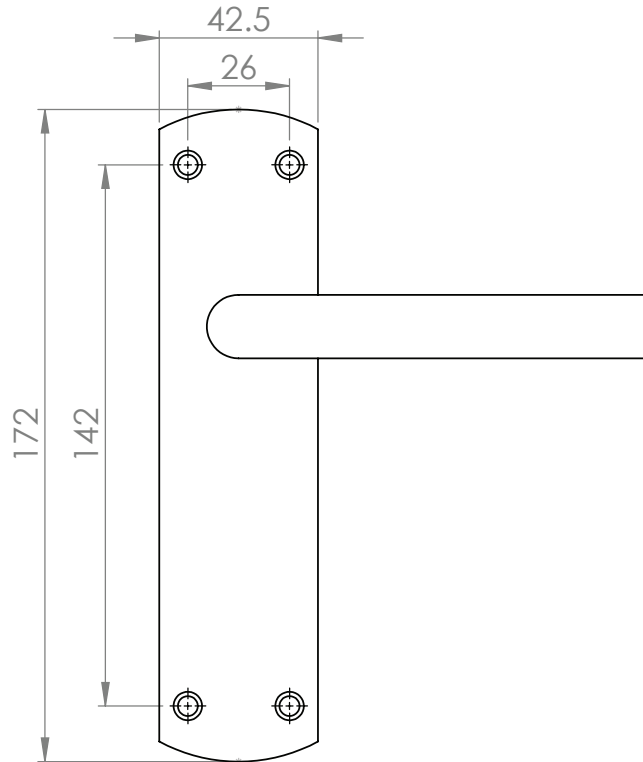

CSLP1163

PRODUCT USE

- Internal Residential
- Light Office Commercial

SPECIFICATION

- Lever handle length 116mm, Ø 16mm
- Lever projection 62mm
- Backplate 172mm x 42.5mm
- Sprung
- Tubular G201 Stainless Steel
- Groove Spindle 100 x 8 x 8mm Grub Screw Fixing
- Matching SS Dome Pozi Screw Fixings
- Screw size M3.8 x 19mm

FINISH

- Dual Finish Stainless Steel

Category of use 2 EN1906
for use on fire-rated and smoke
protection doors to EN 1634

 COMMERCIAL	 DOMESTIC	 BSS/SSS	
 GRADE 201	 MECHANICAL 10 GUARANTEE	 BS EN 1906	 FD 30/60

STEELWORX® Residential

Curved



CSLP1163EDUO

Lever on 172 x 42.5mm Euro Backplate

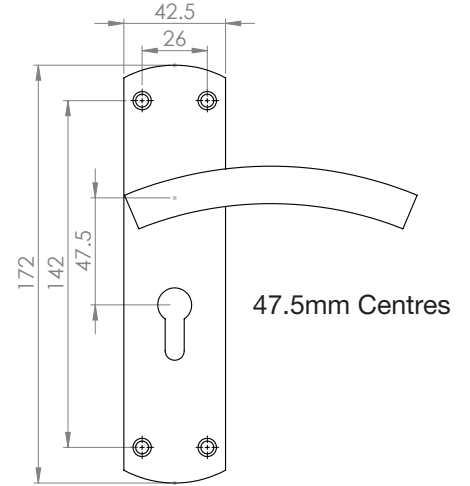

CSLP1163PDUO

Lever on 172 x 42.5mm Lock Backplate

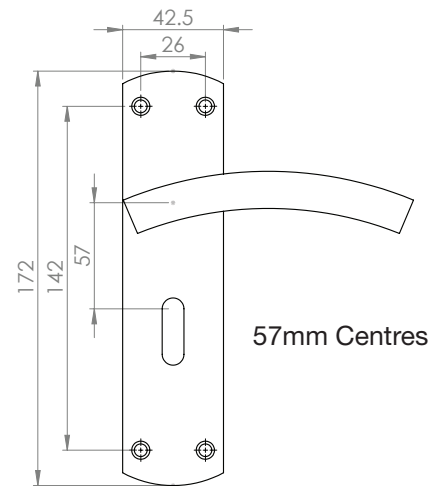

CSLP1163TDUO

Lever on 172 x 42.5mm Bathroom Backplate

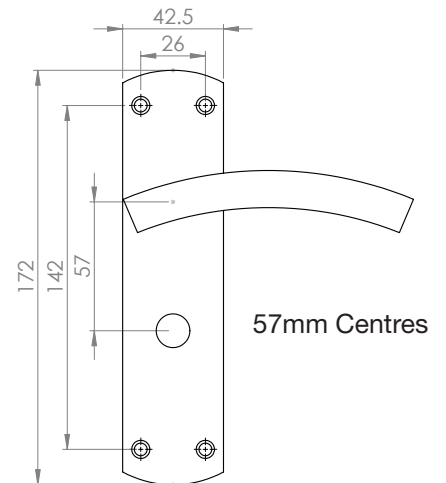

STEELWORX® Residential

T-Bar



CSLP1164B

Lever on 172 x 42.5mm Latch Backplate

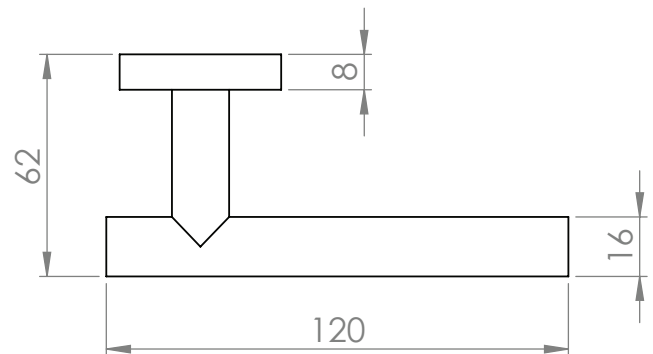
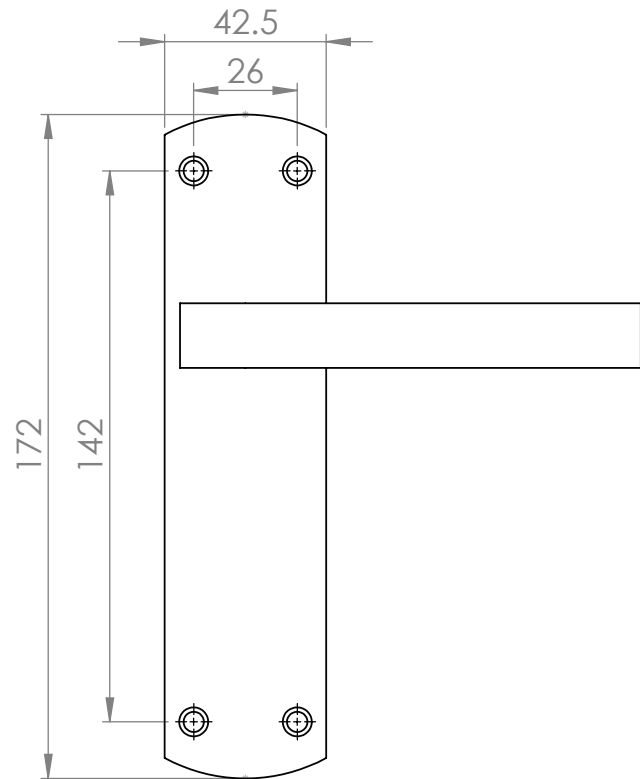

CSLP1164

PRODUCT USE

- Internal Residential
- Light Office Commercial







SPECIFICATION

- Lever handle length 120mm, Ø 16mm
- Lever projection 62mm
- Backplate 172mm x 42.5mm
- Sprung
- Tubular G201 Stainless Steel
- Groove Spindle 100 x 8 x 8mm Grub Screw Fixing
- Matching SS Dome Pozi Screw Fixings
- Screw size M3.8 x 19mm

FINISH

- Bright Stainless Steel
- Satin Stainless Steel

Category of use 2 EN1906 for use on fire-rated and smoke protection doors to EN 1634

 COMMERCIAL	 DOMESTIC	 BSS SSS	
 GRADE 201	 MECHANICAL 10 GUARANTEE	 BS EN 1906	 FD 30/60

STEELWORX® Residential

T-Bar



CSLP1164E

Lever on 172 x 42.5mm Euro Backplate

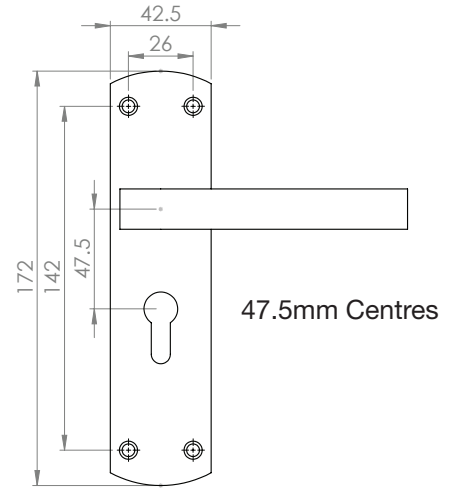

CSLP1164P

Lever on 172 x 42.5mm Lock Backplate

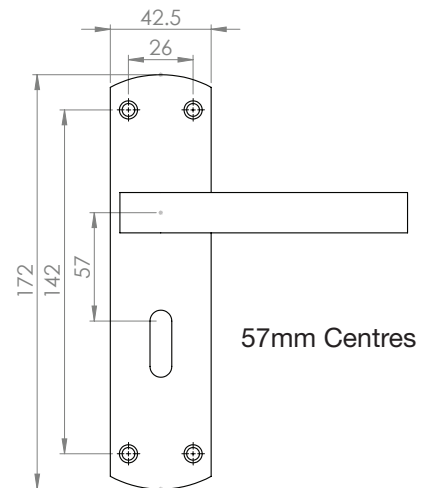

CSLP1164T

Lever on 172 x 42.5mm Bathroom Backplate

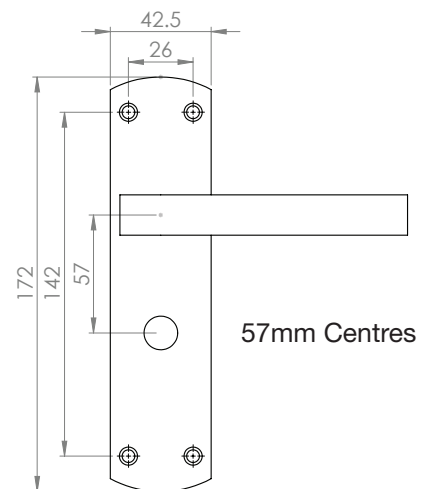

STEELWORX® Residential

Arched



CSLP1167B
Lever on 172 x 42.5mm
Latch Backplate

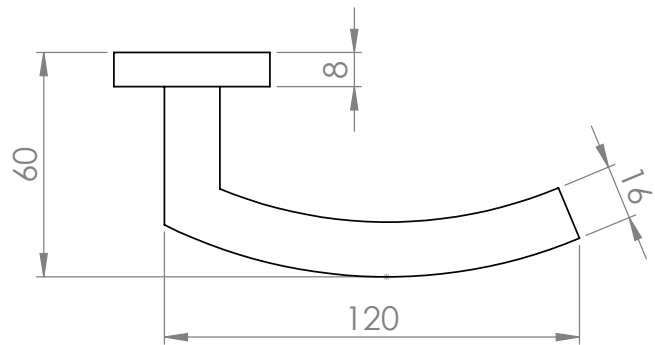
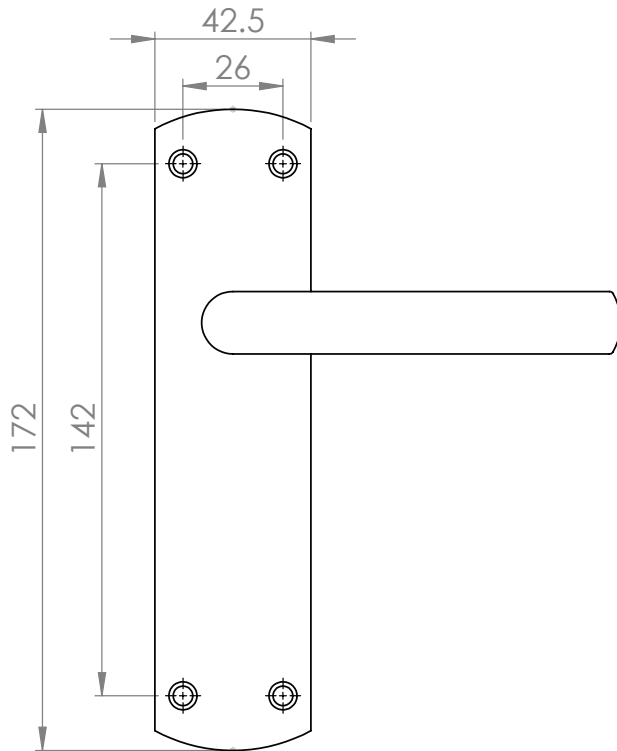

CSLP1167

PRODUCT USE

- Internal Residential
- Light Office Commercial







SPECIFICATION

- Lever handle length 120mm, Ø 16mm
- Lever projection 60mm
- Backplate 172mm x 42.5mm
- Sprung
- Tubular G201 Stainless Steel
- Groove Spindle 100 x 8 x 8mm
Grub Screw Fixing
- Matching SS Dome Pozi Screw
Fixings
- Screw size M3.8 x 19mm

FINISH

- Bright Stainless Steel
- Satin Stainless Steel

Category of use 2 EN1906
for use on fire-rated and smoke
protection doors to EN 1634

 COMMERCIAL	 DOMESTIC	 BSS SSS	
 GRADE 201	 MECHANICAL 10 GUARANTEE	 BS EN 1906	 FD 30/60

STEELWORX® Residential

Arched



CSLP1167E

Lever on 172 x 42.5mm Euro Backplate

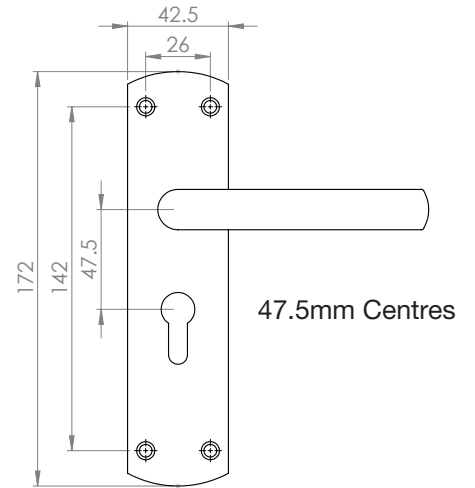

CSLP1167P

Lever on 172 x 42.5mm Lock Backplate

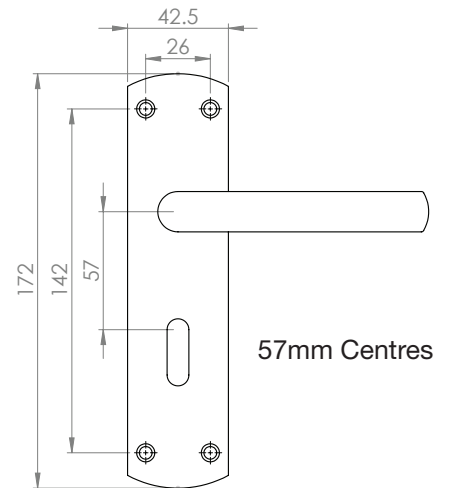

CSLP1167T

Lever on 172 x 42.5mm Bathroom Backplate

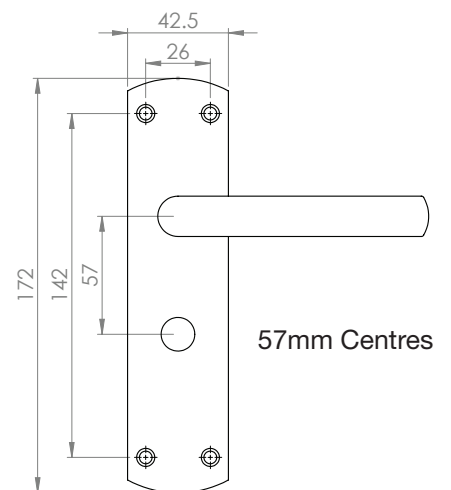

STEELWORX® Residential

Guide to BS EN 1906:2012

Digit 5 - Safety

Grade 0: Normal use

Grade 1: Safety application - to qualify for this grade, handles must have high strength handle-to-plate and plate-to-door fixing and/or handle to spindle fixing, such that they would withstand a person grabbing in order to prevent falling. It is recommended that only Safety Grade 1 furniture is used at the top of cellar steps or other staircases.

Digit 1 - Category of Use

Grade 1: Medium frequency of use with a high incentive to exercise care and a small chance of misuse, e.g. internal residential doors;
Grade 2: Medium frequency of use by people with some incentive to exercise care but where there is some chance of misuse e.g. internal office doors;
Grade 3: High frequency of use by public or others with little incentive to exercise care and with a high chance of misuse, e.g. public office doors
Grade 4: High frequency of use on doors which are subject to frequent violent use, e.g. football stadiums, oil rigs, barracks, public toilets, etc

Digit 6 - Corrosion Resistance

Grade 0: No defined corrosion resistance

Grade 1: Mild resistance - minimum requirement for internal use

Grade 2: Moderate resistance

Grade 3: High resistance - minimum requirement for external use

Grade 4: Very high resistance - recommended for use in exposed marine atmospheres or very polluted industrial environments.

Note: Products intended to develop a natural patina (such as bronze or brass) are not required to comply with any requirements.

1

6

-

1

0

3

4

A

Digit 2 - Durability

Grade 6: Medium use - 100,000 cycles

Grade 7: High use - 200,000 cycles

The tests undertaken to achieve these grades involve the application of additional forces to the door furniture in order to stimulate the conditions of use likely to be experienced in the field.

Digit 3 - Test Door Mass

No requirement

Digit 7 - Security

Grade 0: Not approved for use on burglary resistant doors

Grade 1: Mild burglary resistance

Grade 2: Moderate burglary resistance

Grade 3: High burglary resistance

Grade 4: Extra high burglary resistance

Note: The main requirements include resistance to drilling, close fitting plates or escutcheons to help protect the lock and support the cylinder. They must be resistant to removal from the outside of the door and make provision to minimise the cylinder projection to a maximum of 3mm. Full details of the requirements can be found in BS EN 1906.

Digit 4 - Fire Resistance

Grade 0: Not approved for use on fire/smoke door assemblies.

Grade 1: Suitable for use on fire/smoke door assemblies.

Note: A Grade 1 classification means only that the furniture has been designed for use on fire/smoke control doors; the actual fire performance achieved (e.g. fire integrity of 30 minutes on a partially glazed timber door etc.) will be contained in a separate fire test report.

Digit 8 - Type of operation

Type A: Spring assisted furniture

Type B: Spring loaded furniture

Type U: Unsprung furniture

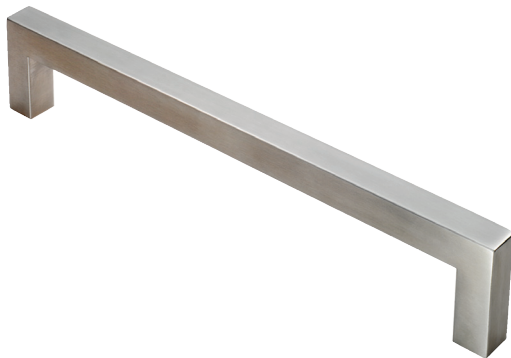

CSL Contract Stainless

A range of commercial tubular 304 grade stainless steel levers on rose, backplate and pull handles.

SWL

A range of 304 grade designer levers. Suitable for commercial, office and superior residential use.

SSL

A range of 304 grade designer levers and pull handles with a square motif.

SW

A classic range of 316 grade stainless steel, commercially orientated pull handles and accessories with finely engineered details.



Carlisle Brass Ltd. Parkhouse Road, Carlisle, Cumbria, CA3 0JU
Sales: 01228 511030 Email: sales@carlislebrass.com Web: www.carlislebrass.com