

# Seasonal Double Glazing Film FITTING INSTRUCTIONS

**Please read all instructions carefully before commencing fitting.**

1. Clean the inside of the window pane to be double glazed and allow to dry thoroughly. Wash and thoroughly dry the window frame - use of a small amount of white spirit applied with a clean cloth to the frame will help the double sided tape to stick firmly (*Fig 1*).
2. **IMPORTANT:** If applying to painted window frames, check that the paint is not loose or flaking off the frame. If in doubt, apply a small length of tape to the frame and press down firmly, then peel it off. If any paint comes off with the tape, the frame should be sanded down and re-painted before the glazing can be fitted.
3. Apply a strip of double sided tape to one side of the window frame on the inside part of the frame (*Fig 2*). Allow the tape to overlap the corner by an inch or two at both ends.
4. Apply a second strip of tape so that it butts up to the first piece (*Fig 2*).
5. Repeat this procedure until you have a "frame" of the double sided tape (still covered with the backing paper) all round the window. Rub down the tape using a clean dry cloth and neatly trim flush any excess at the corners.
6. To make any adjustment easy when fitting the film: lift the backing paper (from both pieces) at each corner and lay a small piece of backing paper diagonally across part of the corner. This makes it easier to peel the film off if you position it wrongly initially (*Fig 3*).
7. Undo the loose folds of film (AS SUPPLIED THE FILM IS CLOSELY FOLDED DOUBLE). Fully unfolded film is approximately 150 cm (5'0") wide.
8. If either height or width of the window or door being glazed is **less than 75cm**, cut a piece of folded film slightly larger than the area of double sided tape. (This size is easiest to measure by holding the film against the window and trimming). This will then give enough material to double glaze **two** windows or doors to the same size.
9. If both dimensions are more than the folded width of the film it is necessary to use the film opened up to its full width - 1.5m (4'11"). For maximum economy, the smaller dimension should be measured down the film along the fold. When trimming along the length of the film, make sure you do not inadvertently cut too close to the folded side - remember, you need to be able to open it out to fully cover the window.
10. **IMPORTANT: THE FILM SHOULD BE UP TO ROOM TEMPERATURE BEFORE FITTING.** If you have kept it in a cold place, leave it in the room for an hour before fitting. Do not warm the film artificially before fitting.
11. Without touching the tape with your fingers, peel the backing off the top piece of tape.
12. With the film cut to size, take two small pieces of tape and stick them overlapping a cut edge of the film (*Fig 4*). Use these as handles to open up the film.
13. The "inner" surface of the film should be held facing away from you and is now ready to be put in place.
14. Apply the film along the top edge (*Fig 5*), avoiding creases and wrinkles. Peel the backing from the tape along the bottom of the frame and, pulling the film outwards and down with both hands, press it into place. Repeat the process for the sides.  
If all appears fine, with no big wrinkles or creases, remove the corner pieces of backing paper and, with a soft cloth, rub down firmly to get good adhesion all round. If necessary, to remove big creases, lift the film off, starting at one corner, and re-apply.
15. Using an ordinary domestic hairdryer (*Fig 6*) start applying heat, first running around the edge of the film, rubbing over the tape with a soft cloth while you do this. If your hairdryer has two heat settings, start with the lower setting. The hairdryer should be held between 2 and 5 cms (1" and 2") from the film. **BE CAREFUL NOT TO TOUCH THE PLASTIC WITH THE HOT DRYER.** If the wrinkles do not begin to disappear, try bringing the dryer closer to the surface or turn it to its higher setting. **DO NOT USE A PAINT STRIPPER GUN.**
16. Now apply warm air to the rest of the film until all wrinkles have disappeared.
17. Leave the film to cool for about 10 seconds then flick it lightly with your finger: if it makes a drum sound, fitting is complete.
18. Using a very sharp knife (*Fig 7*), trim off excess film by running the blade around the outside edge of the tape.

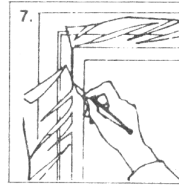
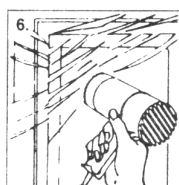
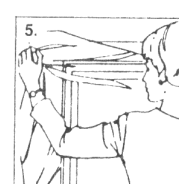
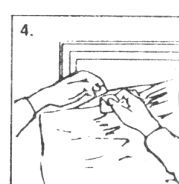
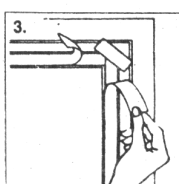
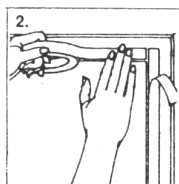
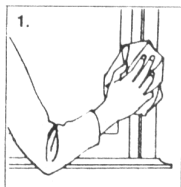

## **IMPORTANT**

1. Hands must be absolutely clean when applying the film. Avoid touching the inner surface of the film or the exposed adhesive tape.
2. The film should be fitted at the coolest time of the day - the air is then least humid which reduces to a minimum any possibility of condensation between the film and glass.
3. Handles, stays etc. can be removed and re-applied safely on top of Stormguard double glazing after the film has been tightened and trimmed.
4. To clean the film, use your normal cleaner but **NO ABRASIVES**. Do not press too hard. If you should stretch the film, use your hairdryer again and it will be as good as new.
5. Keep the film away from any sharp objects. Any small punctures will reduce the effectiveness of the glazing and should be quickly repaired.
6. Please keep instructions for details of how to remove the film and tape.
7. The film is sometimes very closely folded, to fully unfold place a piece of tape on both sides of the film and pull apart, the film should now separate easily.

## **REMOVING FILM AND TAPE FROM YOUR WINDOW FRAME**

1. Remove film from frame.
2. Starting in one corner, warm up the tape using a hairdryer while gently pulling the tape away from the frame.
3. Any residue remaining should be removed with white spirit.

## **WARNING**

Keep all loose film away from children. Quickly clear away all trimmings after application.

## **CONGRATULATIONS**

On choosing Stormguard Seasonal Double Glazing: comfort and heat saving economy at a fraction of the cost of double glazing.

Stormguard™ is a part of the Stormguard Group, Britain's leading manufacturer and distributor of draught excluders.

**The Stormguard Group, Regency Mill, Chester Road,  
Macclesfield. SK11 8HR.  
Tel: 01625 613311**