

VITAL SCOUT

Continuous Wellness Monitor

INSTRUCTIONS FOR USE

Contents

What's Included	1
Intended Use & Precautions	2
Instructions for Use	4
Charging, Storage & Maintenance	10
Troubleshooting	11
Certification & Disclaimer	12
Electromagnetic Compatibility (EMC) Tables	14
Technical Specifications	16
Definition of Symbols	17

What's Included

Vital Scout Patch
x1

Charging Case
x1

Adhesives
x10

USB Charging Cable
x1

Intended Use and Precautions

Intended Use

Vital Scout is intended for general health and fitness monitoring for ages 18 years and older. It is not a medical device, and should not be used for medical purposes.

Precautions

1. Any form of modification to this device is forbidden.
2. Do not use this device if it cannot stay in contact with the skin and do not use on wounded or irritated skin.
3. This device is non-sterile.
4. The Vital Scout patch is to be worn on chest.
5. Do not submerge the Vital Scout patch in water. Patch may be removed and re-applied after showering or bathing.
6. Do not use the patch with a cardiac pacemaker, defibrillators, or other implanted electronic devices.
7. Do not wear or use the patch during a magnetic resonance imaging (MRI), or electro-cautery procedures.

Intended Use and Precautions

8. Exposure of the wireless communications features of the device, or its accessories, may be interfered with by other devices that operate on the same frequencies.

9. Excessive body tissue, hair, or dry skin may affect the signal quality.

10. Do not excessively bend or twist the Vital Scout patch.

11. In case of skin discomfort, remove the Vital Scout patch immediately.

12. User may only charge the patch via USB cable with the provided charger. No user serviceable part is provided for this product.

13. The performance of the device may be degraded if one or more of the following occur: a) operation outside the manufacturer's stated temperature and humidity range; b) storage outside the manufacturer's stated temperature and humidity range; c) mechanical shock (for example, being dropped)

14. Please contact customer service at support@vivalnk.com if you have any questions.

15. For best results, the Vital Scout patch must be used with the provided adhesives.

Instructions for Use - Getting Started

Fully charge the patch before use



Indicates Fully Charged

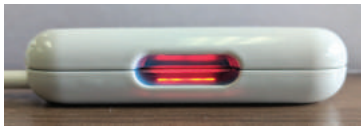

Indicates Charging

1. Download the App

Download the free Vital Scout app by searching "Vital Scout" in the Apple App Store or Google Play Store. You must download the app in order to use the product.

2. Sign Up

Create an account and enter your profile data so the app can accurately monitor your health.

3. Pair the Patch

Make sure Bluetooth is enabled in your phone's settings. Place the patch near the phone and start scanning. Select the serial number from the list that matches the serial number that is on the back of your Vital Scout patch.

Instructions for Use - Applying the Patch

1. Prepare Skin

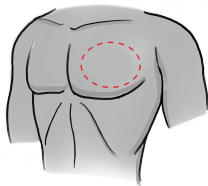

Ideally, clean the left, upper middle chest area with an alcohol swab. Shave area if needed. Let dry completely.

2. Peel adhesive starting with tab #1

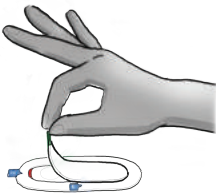

3. Place the patch on the adhesive

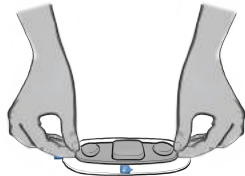

Be sure to center and press patch firmly onto the adhesive.

Instructions for Use - Applying the Patch

4. Peel adhesive using tab #2

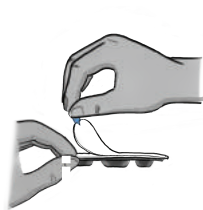

Tab #2 is located on the bottom side of the patch.

5. Place the patch with adhesive side down onto left, upper-middle chest area



Press the patch firmly on chest and around outer layer of the adhesive.

6. Carefully remove blue plastic liner using tab #3



After removing the blue plastic liner, you will notice a transparent film.

Instructions for Use - Removing and Cleaning the Patch

1. Remove the patch from chest by pulling from the outer edge of the adhesive

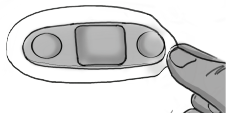

Start at the outer edge of the transparent film to peel off the patch.

2. Remove the adhesive from the patch itself by peeling from the edge

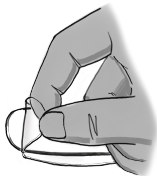

Do not reuse this adhesive.

3. Clean the patch with warm water

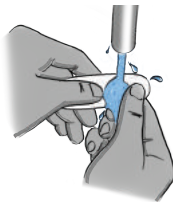

Rub off any residue with your fingers, wait for patch to dry completely. Do not submerge.

Instructions for Use - Removing and Cleaning the Patch

4. Place the patch in the charger to recharge



Align the two dots on the patch with the two pins on the charger to properly charge the patch.

5. Once charged, you can re-apply the patch; see instructions for "Applying the Patch"

Instructions for Use - Tips before Showering



Note: While the patch is water resistant, avoid excessive exposure to water as it can affect the adhesive and sensors.

1. Avoid prolonged or hot showers
2. Avoid soap or rubbing around the patch
3. Dry patch by dabbing with towel
4. If the patch dislodges after a shower, or you notice a problem with the sensor signals, see instructions for "Removing and Cleaning the Patch".

Charging, Storage & Maintenance

Patch Storage & Charging

It is recommended to store the Vital Scout patch in the charging case when not in use for better cleanliness. Charging will automatically start when the USB cable is connected to a USB power source.

Adhesives

Each Vital Scout comes with 10 medical grade, disposable adhesives. Adhesives can be used up to 72 hours, but some users may want to change adhesives more often depending on skin type and comfortability. Additional adhesives can be purchased separately as needed.

Charger LED Indicators

RED

- When the Vital Scout patch is placed inside the charger, red light indicates the patch is charging.
- The light should stay on when charging.

GREEN

- When the Vital Scout patch is placed inside the charger, green light indicates the patch is fully charged.

OFF

- When Vital Scout patch is not placed inside the charger, the charger is not plugged in via USB cable, or patch is misaligned with the charging pins.

Troubleshooting

Symptom	Possible Causes	Solutions
Unusual Data	<ol style="list-style-type: none">1. This device might be damaged.2. This device might not be worn correctly.3. The Vital Scout patch has not been paired.4. Improper or no skin preparation.5. Incorrect attachment of adhesive.	<ol style="list-style-type: none">1. Contact support@vivalnk.com2. Recheck device's location or contact with skin.3. Pair the Vital Scout patch before wearing.4. Prepare the skin before application.5. Follow the instructions to attach the adhesive.
Smart phone cannot read data from the patch	<ol style="list-style-type: none">1. Bluetooth feature is not enabled in the smart phone.2. Out of connection range.	<ol style="list-style-type: none">1. Enable the Bluetooth feature in the smart phone.2. Move the smart phone closer to the patch.

Certification & Disclaimer

Notes:

This device has been tested and found to comply with the limits for a Class B digital device, pursuant to part 15 of the FCC Rules. These limits are designed to provide reasonable protection against harmful interference in a residential installation. This equipment generates, uses, and can radiate radio frequency energy and, if not installed and used in accordance with the instructions, may cause harmful interference to radio communications. However, there is no guarantee that interference will not occur in a particular installation. If this device does cause harmful interference to radio or television reception, the user is encouraged to try to correct the interference by one or more of the following measures:

1. Increase the separation between the Vital Scout patch and phone.
2. Connect the equipment into an outlet on a circuit different from that to which the receiver is connected.
3. Consult an experienced radio / TV technician for help.
4. Reorient or relocate the receiving antenna.

This device complies with Part 15 of the FCC Rules. Operation is subject to the following two conditions: (1) this device may not cause harmful interference, and (2) this device must accept any interference received, including interference that may cause undesired operation.

Changes or modification not expressly approved by VivaLnk could void the user's authority to operate the equipment.

Certification & Disclaimer

For private households: Information on Disposal for Users of WEEE

Disposing of this product correctly will help save valuable resources and prevent any potential negative effects on human health and the environment, which could otherwise arise from inappropriate waste handling. Please contact your local authority for further details of your nearest designated collection point. Penalties may be applicable for incorrect disposal of this waste, in accordance with your national legislation.

This symbol  on the product(s) and / or accompanying documents means that used electrical and electronic equipment (WEEE) should not be mixed with general household waste. For proper treatment, recovery and recycling, please take this product(s) to designated collection points where it will be accepted free of charge.

Alternatively, in some countries, you may be able to return your products to your local retailer upon purchase of an equivalent new product.

Battery Removal

The Vital Scout patch contains a lithium battery. Refer to proper disposal instructions below:

1. To remove the battery, cut the Vital Scout patch. The battery is located in the center of the patch.
2. All batteries / accumulators should be disposed separately from the municipal waste stream via designated collection facilities appointed by the government or the local authorities. The correct disposal of your old batteries/accumulators will help to prevent potential negative consequences for the environment, animal, and human health.

Electromagnetic Compatibility (EMC) Tables

Table 1

Emission Test Levels		
Phenomenon	Professional Healthcare Facility Environment (E.g. physician offices, dental offices, clinics etc.)	Home Healthcare Environment (E.g. restaurants, cafes, shops, etc.)
	IEC 60601 Test Level	IEC 60601 Test Level
Conducted and radiated RF EMISSION	CISPR 11	CISPR 11 ^{a) b)}
<p>a) Vital Scout used in aircraft shall meet the RF EMISSIONS requirements of ISO 7137. The conducted RF EMISSIONS test is also applicable to Vital Scout stored in charger connected to aircraft power. ISO 7137 is identical to RTCA DO-160C:1989 and EUROCAE ED-14C:1989. The latest editions are RTCA DO-160G: 2010 and EUROCAE ED-14G: 2011. Therefore, use of Section 21 (and category M) of a more recent edition, e.g. [39] or [40], should be considered.</p> <p>b) In other intended modes or in EM ENVIRONMENTS of transportation, applicable standards shall apply. Examples of standards that might be applicable include CISPR 25 and ISO 7637-2.</p>		

Electromagnetic Compatibility (EMC) Tables

Table 2

Immunity Test Levels		
Phenomenon and Basic EMC standard or test method	Professional Healthcare Facility Environment (E.g. physician offices, dental offices, clinics etc.)	Home Healthcare Environment (E.g. restaurants, cafes, shops, etc.)
Electrostatic discharge IEC 61000-4-2	± 8 kV contact ± 2 kV , ± 4 kV, ±8 kV, 15 kV air	
Radiated RF EM fields IEC 61000-4-3	3 V/m 80 MHz - 2.7 GHz 8% AM at 1kHz	10 V/m 80 MHz - 2.7 GHz 8% AM at 1kHz
Rated power frequency magnetic fields IEC 61000-4-8	30 A/m ^{c)} 50Hz or 60Hz	
c) This test level assumes a minimum distance between the Vital Scout and power source with magnetic field of at least 15 cm. If the RISK ANALYSIS shows that the Vital Scout will be used closer than 15 cm to power source with magnetic field, the IMMUNITY TEST LEVEL shall be adjusted as appropriate for the minimum expected distance.		

Technical Specifications

Product Name: Vital Scout

Catalog/Model: VV310/VV-310

Patch Size: 90mm x 28mm

Patch Thickness: 7.9 mm

Patch Weight: 7.5 g

Patch Battery: 95 mAh, rechargeable

Duration of continuous patch use: 3 Days

Product Shelf Life: 1 Year

Product Service Life: 2 Years

Heart Rate Detection Range: 40 BPM - 300 BPM

Accelerometer Range: \pm -4g in x, y, z

Patch Water Resistance: IP25

Charger Water Resistance: IP21

Charger Power Source: Standard USB

Operating Conditions:

Temperature Range: 50° F - 104° F (10° C - 40° C)

Humidity Range: 15% - 85%

Pressure Range: 70 - 106 kPa

Storage Conditions:

Temperature Range: 50° F - 122° F (10° C - 50° C)

Humidity Range: 15% - 85%

Pressure Range: 70 - 106 kPa

Receiver:

Android Devices: 4.4 or later

Apple Devices: iPhone 5s or later and iOS 8.0 or later

This device complies with Part 15 of the FCC Rules.

Definition of Symbols



FCC icon



Manufacturer



Polyethylene terephthalate
- window only



WEEE icon



Date of Manufacture



Radio emission



Consult Instructions
For Use



Serial Number



Keep Dry



Type-BF applied part



Lot/batch Number



Temperature Limit



Catalog Number

THANK YOU

FOR CHOOSING VITAL SCOUT

Manufactured by VivaLnk, Inc.
51 East Campbell Ave #160
Campbell, CA 95008 USA
(408) 868-2898