



Part No: COMP10289

## OWNERS MANUAL

### IMPORTANT

- **Important. Read these instructions for use carefully. Familiarise yourself with the appliance before connecting it to its gas container. Keep these instructions for future reference**
- This appliance shall only be used with disposable 73% butane / 27% propane only cartridges certified to EN417, DOT2P, UN2037
- IT MAY BE HAZARDOUS TO ATTEMPT TO FIT OTHER TYPES OF GAS CONTAINERS
- USE OUTDOORS ONLY
- CAUTION: accessible parts may be very hot. Keep young children away.

### SAFETY INSTRUCTIONS:

- Keep storage container away from stove when it is in use
- When being stored the appliance must be disconnected from the gas cylinder and be stored separately
- **DO NOT** place stove inside storage container until it is cool to touch
- Is suitable for camping use ONLY
- Shall NOT be exposed to moisture or rain
- Do not modify this appliance
- Check that seals between the appliance and the gas container are in place and in good condition before connecting the gas container.
- Do not use this appliance if it has damaged or worn seals
- Do not use this appliance if it is leaking, damaged or does not operate properly
- Only use the hose assembly as supplied with this appliance for connection to the cylinder – DO NOT USE ADAPTORS
- This appliance must only be serviced by an authorized person
- DO NOT use multiple appliances to heat a single utensil
- Always operate the stove a minimum of 800mm away from flammable materials, walls and ceiling on a flat level surface
- Only use pot supplied with appliance for direct connection or if using trivet ensure that the a maximum pot size of 130mm in diameter is used
- Always use oven mitts or oven gloves when handling the stove after use
- DO NOT operate the stove below ground level or in areas where unburnt gas could build up
- DO NOT move the stove when it is in use
- Clean the stove after use when it has cooled
- After use, turn the gas cylinder off, wait for the flame to go out
- Store the gas cartridges outdoors in a well-ventilated area or in a storage area compliant with AS1596
- NEVER assemble or operate the stove on unstable or uneven ground
- Always operate in well-ventilated areas
- To be used as a cooking appliance only, not to be used as a heater or modified for any other reason

### CARBON MONOXIDE HAZARD

USE ONLY IN WELL VENTILATED AREAS.

**CARBON MONOXIDE HAZARD USING THIS APPLIANCE IN AN ENCLOSED SPACE MAY CAUSE DEATH. DO NOT USE IN CARAVANS, TENTS, MARINE CRAFT, CARS, MOBILE HOMES OR SIMILAR LOCATIONS.**

### IF YOU SMELL GAS:

- If there is a leak from your appliance (smell of gas) and you cannot stop the gas flow, remove the appliance to a well-ventilated location away from any ignition source. Check for leaks using soapy water. Do not try to detect leaks using a flame
- Coat all connections with soapy water, if bubbles appear, remove cartridge and re-attach before testing again
- If gas leak continues, contact your local supplier immediately
- Inspect the stove regularly for any signs or wear, leaks or incorrect operation
- If symptoms such as flaring burner, issues with lighting, leaks from seals or problems with gas control are identified, do not attempt to repair, return to your authorised stockist for service and maintenance
- This appliance must only be serviced by an authorized person
- When changing gas cartridges, ensure this is done outside in a well-ventilated place, free from people, animals and ignition sources such as naked flames, pilot lights and electrical equipment with heaters or elements
- This stove is not intended for use by young children or an infirm person unless they have been adequately supervised by a responsible person to ensure that they can use the stove safely. Young children should be supervised to ensure that they do not play with the stove.

### SAFETY INSTRUCTIONS

This appliance must only be used in an above ground open air situation with natural ventilation, without stagnant areas, where gas leakage is rapidly dispersed by wind and natural convection.

Any enclosure in which the appliance is used should comply with one of the following:

- (A) An enclosure with walls on all sides, but with no overhead cover.
- (B) Within a partial enclosure that includes an overhead cover and no more than two walls.
- (C) Within a partial enclosure that includes an overhead cover and more than two walls, the following must apply:
  - (1) At least 25% of the total wall area is completely open.
  - (2) 30% or more in total of the remaining wall side, back and front wall areas is open and unrestricted.
  - (3) In the case of balconies, 20% or more of the total wall area must remain open and unrestricted.

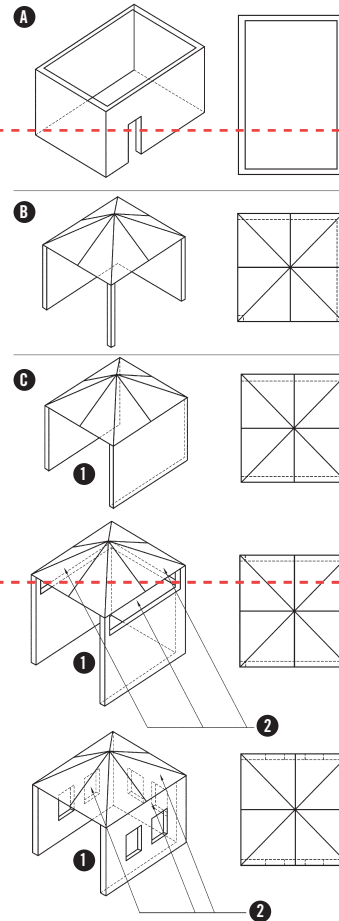

### CARE INSTRUCTIONS:

- Using warm soapy water with a mild detergent wipe down all surfaces, taking care not to allow water to enter the burner outlet or aeration holes located on the burner tube
- DO NOT submerge the stove in a sink or bowl
- DO NOT use abrasive cleaners or bleach
- Ensure the stove is clean and dry before storing

### MAINTENANCE, SERVICE & STORAGE:

- If when in use, the burner flame is unstable, changing colour from yellow or blue, or if it has a distinct smell, it is important that the stove be taken to your local authorised gas appliance repairer for inspection
- Periodically check the gas control is tight and has no leaks, follow the testing for leaks procedure
- For further information or assistance, please contact our Sales Department

For warranty and technical support please visit:  
[www.companionleisure.com.au](http://www.companionleisure.com.au)  
 or call 1300 555 197

### PACKING AWAY:

**IMPORTANT** - Allow all parts of the appliance to be completely cool before packing away

1. Remove cartridge support and fold in legs
2. Remove gas cartridge from cooker

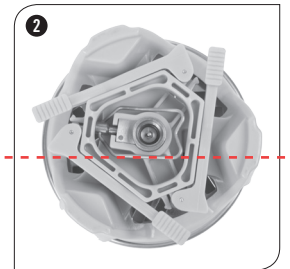

3. Invert pot and slide cooker inside



4. Insert pot trivet, with legs folded into pot, attach lid, lock in place and store



**Note:** Gas cartridge can also be stored inside pot depending on size. It is recommended to use 100g or 220g gas cartridge with cooker



## ASSEMBLY

### 1. Remove cooker and components from pot



### 2. Attach base stand to gas cartridge

(a) Open stand as shown

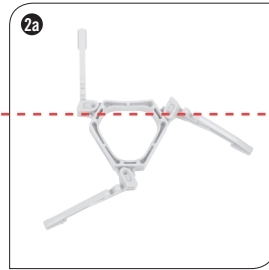

(b) Attach to base of cartridge, locating rim in the groves of stand



(c) Push legs in a clockwise direction until the lock in place

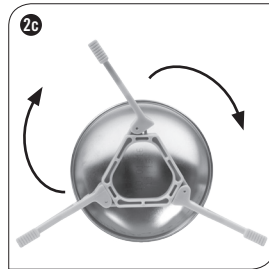

### 3. Attach Cooker to Cartridge

(a) Unfold gas control from its stored position and check that it is in the "Off" position

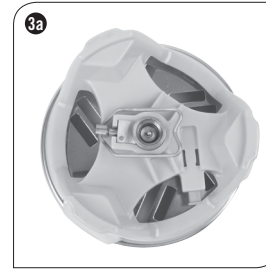

(b) Locate cooker on the cartridge and rotate in a "clockwise" direction until it seals  
(c) Check for any gas leaks before use using a leak detecting agent or soapy water – Never use a Flame

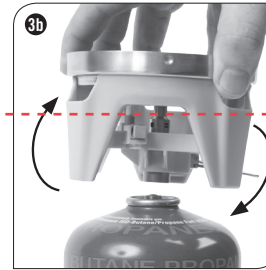

**Note:** It is suggested to use Companion gas leak detector spray on all connections prior to operation



### 4. Attach Pot

(a) Locate pot on cooker, lining up the securing tabs and turn in a "Clockwise" direction until the pot is secured



### 5. Attach Pot Stand

(a) Unfold trivet legs but do not lock in place  
(b) Locate the legs on the edge of the cooker and lock in position

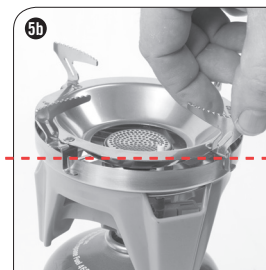
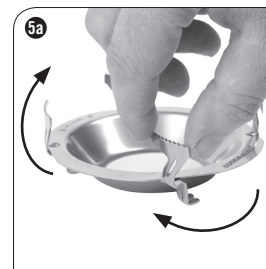

### 6. Operation

(a) Locate appliance on a stable and even surface

(b) Turn the gas control in an "Counter-Clockwise" direction for 1/2 turn



(c) Press the Piezo until the burner lights  
**Note:** If Burner does not ignite, turn the gas supply off and wait for excess gas to disburse before repeating the lighting process



(d) Adjust the flame by using the gas control

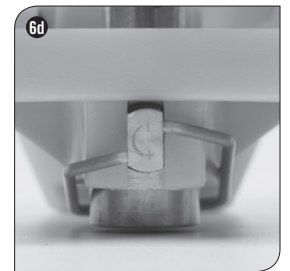

(e) Counter Clockwise to increase the flame

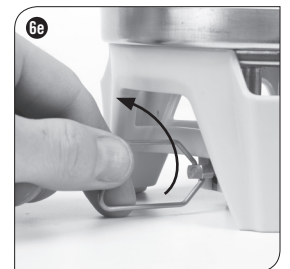

(f) Clockwise to decrease the flame and / or extinguish the burner

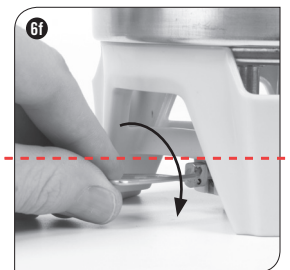

**Note:** Once is burner is extinguished allow the appliance to cool before moving



**MODEL:** COMP10289  
**INJECTOR:** 0.19 mm  
**CONSUMPTION:** 4.0 MJ/Hr - 82g/Hr  
**CERTIFICATE:** 86396