

Klik® Poly-Nuts

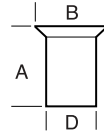

Cross
section
view



Available in Steel-Zinc Plated or Aluminum Class 2B Threads

Klik Poly-Nuts (Expander)

Klik Poly-Nuts can be used in a wide range of applications and are designed to provide a very efficient and cost-effective method of placing permanent threads in thin materials. Installed from one side, Klik Poly-Nuts are perfect for use in metal, fiberglass and rigid plastic previously too thin for tapped threads. Klik Poly-Nuts provide a nearly flush appearance and once in place, the internal threads are ready for a screw or bolt.

Lightweight tooling assures easy installation by the operator and reduces costs when compared with other methods. After installation, Klik Poly-Nuts provide permanent, captive threads that do not allow loosening under vibration and will not rotate when attached to the mating material.

Klik Poly-Nut (Expander) Specifications

Thread Size	Steel	Aluminum	A Body Length +-.015"	B Head Dia. Ref. +-.015	D Body Dia. +-.005	Grip Range		Hole Size*		Drill Size
	Bulk Part#	Bulk Part #				Min	Max	Min	Max	
6-32	57415	57510	.410	.287	.249	.020	.080	.250	.254	1/4"
8-32	57425	57520	.410	.287	.249	.020	.080	.250	.254	1/4"
10-24	57435	57530	.465	.320	.280	.020	.130	.281	.285	9/32"
10-32	57445	57540	.465	.320	.280	.020	.130	.281	.285	9/32"
1/4-20	57455	57550	.610	.415	.374	.030	.165	.375	.379	3/8"
5/16-18	57475	57575	.720	.540	.499	.030	.165	.500	.504	1/2"
3/8-16	57485	57585	.720	.540	.499	.030	.165	.500	.504	1/2"
4 mm	57407		.410	.287	.249	.020	.080	.250	.254	1/4"
5 mm	57409		.465	.320	.280	.020	.130	.281	.285	9/32"
6 mm	57411		.610	.415	.374	.030	.165	.375	.379	3/8"
8 mm	57413		.720	.540	.499	.030	.165	.500	.504	1/2"
10 mm	57414		.720	.540	.499	.030	.165	.500	.504	1/2"

* **Note:** Hole size is critical for proper installation