

2000 Series Floor Spring

FLOOR SPRING WITH BACKCHECK

BS EN 1154



The Exidor 2000 series double cam mechanism floor spring range fit discreetly into the floor, giving improved resistance to interference and vandalism, and are particularly suited to shops, offices, hospitals etc. Available in both single and double action with backcheck, they feature adjustable power size 1-4, can be used for doors up to 400KG and are available as a complete unit, or as a mechanism only where replacements are required.

Options include hold open and delayed action, and other accessories consist of extra height spindles, 200° cam and gel infill for improved water resistance. The cover plate is available in a choice of three plated finishes.



FLOOR SPRING

		2950	2952	2960
Closing Force	EN Size	1-4	1-4	1-4
Door Size (Max)	Width (mm)	1100	1100	1100
	Weight (KG)	400	400	400
Mechanism	Rack & Pinion	X	X	X
	Double Cam	✓	✓	✓
Angle of Opening		180°	180°	180°
Non Handed		✓	✓	✓
Power Adjustment	By Spring	✓	✓	✓
	By Template	X	X	X
Action Availability	Single	✓	✓	✓
	Double	✓	✓	✓
Adjustable Sweep Speed		✓	✓	✓
Latching Speed		✓	✓	✓
Backcheck		✓	✓	✓
Heavy Duty Backcheck		X	X	X
Delayed Action		X	X	✓
Hold Open		X	✓	X
CE Marked		✓	✓	✓
Certifire Approved		✓	X	X
Guarantee		10 yrs	10 yrs	10 yrs
OPTIONS				
Single Action Accessories		✓	✓	✓
Double Action Accessories		✓	✓	✓
Spindle Extensions		✓	✓	✓
200° Cam for single action doors requiring controlled closing from 180°		✓	✓	✓
Gel Infill For Improved Water Resistance		✓	✓	✓
Mechanism & Box Only		✓	✓	✓
Finishes	SS, PS, PB			

Dimensions (measurements in millimetres):

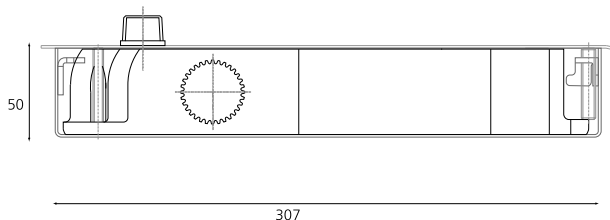

Cover plates

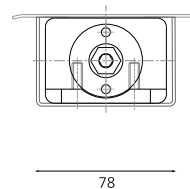
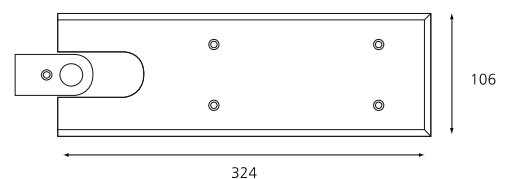

2000/4F Floor Pivot



The Exidor 2000/4F floor pivot uses the same class leading bearing technology as the floor spring and is used in applications where there is no requirement for closing a door, and using hinges is difficult because the door is heavy or a double action is required.

The 2000/4F can carry a door up to 400KG whilst having a very small footprint, and only has a recess below the floor surface of 15mm. The range is compatible with all Exidor floor spring strap systems and top centres, which must be ordered separately, if required.

Different height spindle extensions between 5mm and 50mm are available, but these must be ordered with the pivot as they cannot be changed on site.

The floor pivots are available in satin stainless steel, polished stainless steel or polished brass finish.



FLOOR PIVOT

		2000/4F
Closing Force	EN Size	N/A
Door Size (Max)	Width (mm)	1800
	Weight (KG)	400
Mechanism	Rack & Pinion	X
	Cam & Roller	X
Angle of Opening		N/A
Non Handed		✓
Power Adjustment	By Spring	X
	By Template	X
Action Availability	Single	✓
	Double	✓
Adjustable Sweep Speed		X
Adjustable Latching Speed		X
Adjustable Backcheck		X
Adjustable Delayed Action		X
Hold Open		X
CE Marked		X
Certifire Approved		✓
Guarantee		10 yrs
OPTIONS		
Single Action Accessories		X
Double Action Accessories		X
Spindle Extensions		✓
Finishes	SS, PS, PB	

Dimensions (measurements in millimetres):

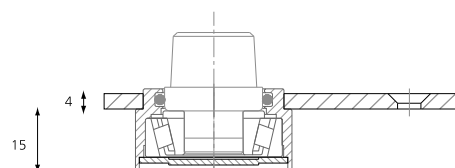
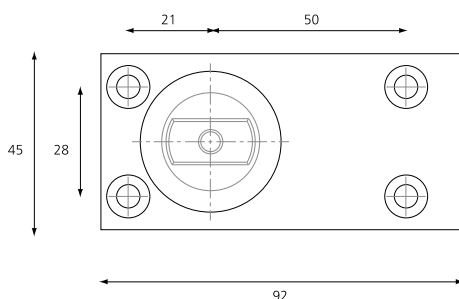

900 Series Floor Spring

HEAVY DUTY FLOOR SPRINGS WITH BACKCHECK

BS EN 1154



Generally considered the best in the market, the Exidor 900 series double cam mechanism floor spring range fits discreetly into the floor, giving improved resistance to interference and vandalism, and they are particularly suited to shops, offices, hospitals etc. Available in both single and double action with backcheck, they feature adjustable power size 1-6 and can be used for doors up to 600KG. Available as a complete unit, or as a mechanism only where replacements are required, the 900 series is equipped with a unique centre controlled closing mechanism which ensures smooth and quiet closing to the central closed position from either direction.

Options include 90°, 105° and 120° hold open, delayed action, and heavy duty backcheck for use on heavier doors. Other accessories consist of extra height spindles, 200° cam and gel infill for improved water resistance. The cover plate is available in a choice of three plated finishes.



		990	991	993	994	995
Closing Force	EN Size	1-6	1-6	1-6	1-6	1-6
Door Size (Max)	Width (mm)	1400	1400	1400	1400	1400
	Weight (KG)	600	600	600	600	600
Mechanism	Rack & Pinion	X	X	X	X	X
	Double Cam	✓	✓	✓	✓	✓
Angle of Opening		180°	180°	180°	180°	180°
Non Handed		✓	✓	✓	✓	✓
Power Adjustment	By Spring	✓	✓	✓	✓	✓
	By Template	X	X	X	X	X
Action Availability	Single	✓	✓	✓	✓	✓
	Double	✓	✓	✓	✓	✓
Adjustable Sweep Speed		✓	✓	✓	✓	✓
Latching Speed		✓	✓	✓	✓	✓
Backcheck		✓	✓	✓	✓	✓
Heavy Duty Backcheck		X	X	X	X	✓
Delayed Action		X	✓	X	X	X
Hold Open 90° & 120°		X	X	✓	X	X
Hold Open 105°		X	X	X	✓	X
CE Marked		✓	✓	✓	✓	✓
Certifire Approved		✓	X	X	X	X
Guarantee		10 yrs	10 yrs	10 yrs	10 yrs	10 yrs
OPTIONS						
Single Action Accessories		✓	✓	✓	✓	✓
Double Action Accessories		✓	✓	✓	✓	✓
Spindle Extensions		✓	✓	✓	✓	✓
200° Cam		✓	✓	✓	✓	✓
Gel Infill For Improved Water Resistance		✓	✓	✓	✓	✓
Mechanism & Box Only		✓	✓	✓	✓	✓
Finishes		SS, PS, PB				



FLOOR SPRING

Cover plates

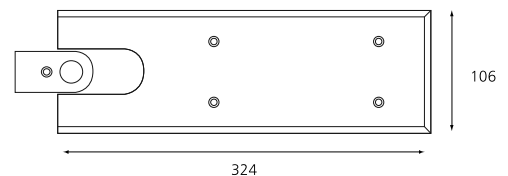

Dimensions (measurements in millimetres):

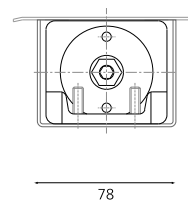
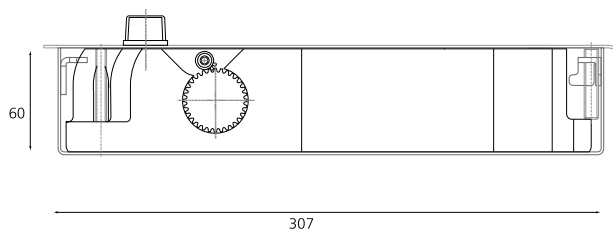

1000 Series Ultimate Transom Closer

ULTIMATE TRANSOM CLOSER COMPLETE WITH ARM SET & BOTTOM PIVOT

BS EN 1154



The Exidor Ultimate transom closer range offers a neat, aesthetically pleasing way to control a door opening. They are particularly popular where a discreet closer is required, and are widely used in hospitals, universities etc. Suitable for use on both internal and external doors, the unit can be used with aluminium, timber and hollow metal doors and frames, and comes with an adjustable floor pivot.

Available only in double action with adjustable power size 1-6, the transom closer can be supplied complete with fittings, or as mechanism only when being used as a replacement. Optional extras include extra height floor pivot, end load arm and intumescent packs.



TRANSOM CLOSERS

		1950	1960	1952
Closing Force	EN Size	1-6	1-6	1-6
Door Size (Max)	Width (mm)	1100	1100	1100
	Weight (KG)	600	600	600
Mechanism	Rack & Pinion	X	X	X
	Double Cam	✓	✓	✓
Angle of Opening		180°	180°	180°
Non Handed		✓	✓	✓
Power Adjustment	By Spring	✓	✓	✓
	By Template	X	X	X
Side Load Arm		✓	✓	✓
Action	Single	X	X	X
	Double	✓	✓	✓
Adjustable Sweep Speed		✓	✓	✓
Latching Speed		✓	✓	✓
Backcheck		✓	✓	✓
Delayed Action		X	✓	X
Hold Open		X	X	✓
CE Marked		✓	✓	✓
Certifire Approved		✓	X	X
Guarantee		10 yrs	10 yrs	10 yrs
OPTIONS				
Short Side Load Arm		✓	✓	✓
End Load Arm		✓	✓	✓
Spindle Extensions		✓	✓	✓
Intumescent Pack		✓	✓	✓
Mechanism Only		✓	✓	✓
Finishes	SS, PS, PB			

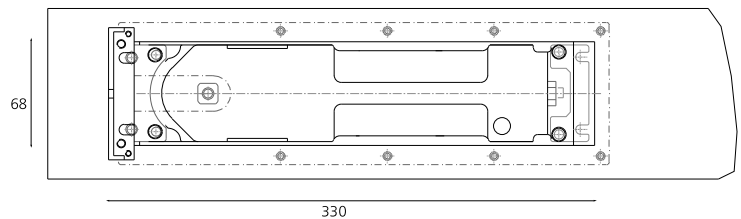

Dimensions (measurements in millimetres):

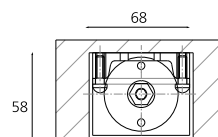
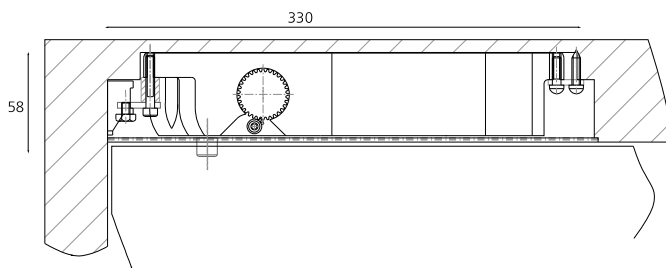

Door Closer Accessories

Overhead Door Closers

CODE	DESCRIPTION	SUITABILITY	FINISH
X034	Face fixing bracket for fig 1 and fig 61 applications. Supplied as standard with projecting arm models.	Standard & E-mag	Silver, RAL, SS, PS & PB
X016	Soffit plate for fig 1, fig 61 and fig 66 applications. Supplied as standard with projecting arm models	Standard & E-mag	Silver, RAL, SS, PS & PB
X038	Soffit plate with intumescent protection for fig 1, fig 61 and fig 66 applications. For use on timber fire doors in frames with moulded architraves.	Standard & E-mag	Silver, RAL, SS, PS & PB
X040	Drop plate for fig 1 application.	All	Silver, RAL, SS, PS & PB
X041	Drop plate for fig 6 application.	All	Silver, RAL, SS, PS & PB
X042	Saddle bracket for glass doors.	All	Silver, RAL, SS, PS & PB
X043	Bolt through bracket for glass doors.	All	Silver, RAL, SS, PS & PB
X001	Fixed projecting arm. Supplied as standard with the 4000, 5000 and Superior Plus ranges.	Standard only	Silver, RAL, SS, PS & PB
X002	Adjustable projecting arm. Supplied as standard with the 9000 series.	Standard only	Silver, RAL, SS, PS & PB
X003	Hold open projecting arm.	Standard & E-mag	Silver, RAL, SS, PS & PB
X004	E-mag projecting adjustable arm. Supplied as standard with the E-mag ranges.	E-mag only	Silver, RAL, SS, PS & PB
X005	Slide arm & Channel. Supplied as standard with the 4000 and 9000 slide arm ranges.	Slide arm only	Silver, RAL, SS, PS & PB
X020	B Slide cover.	4000 series only	Silver, RAL, PAA, SAA, SS, PS & PB
X021	E Slide cover.	4000 series only	Silver, RAL, PAA, SAA, SS, PS & PB
X022	L Slide cover.	4000 series only	Silver, RAL, PAA, SAA, SS, PS & PB
X023	End caps for B slide.	4000 series only (Excl E-mags)	Silver, RAL, PAA, SAA, SS, PS & PB
X024	End caps for E or L slide.	4000 series only (Excl E-mags)	Silver, RAL, PAA, SAA, SS, PS & PB
X025	End caps for B slide E-mags.	4000 series E-mags only	Silver, RAL, PAA, SAA, SS, PS & PB
X026	End caps for E or L slide E-mags.	4000 series E-mags only	Silver, RAL, PAA, SAA, SS, PS & PB
X027	Spindle cap.	4000 series	Silver, RAL, PAA, SAA, SS, PS & PB
X030	Square cover.	9000 series (Excl E-mags)	Silver, RAL, PAA, SAA, SS, PS & PB
X031	Radius cover.	9000 series (Excl E-mags)	Silver, RAL, PAA, SAA, SS, PS & PB
X032	Square cover - E-mags	9000 series E-mags only	Silver, RAL, PAA, SAA, SS, PS & PB
X033	Radius cover - E-mags	9000 series E-mags only	Silver, RAL, PAA, SAA, SS, PS & PB
X036	Standard power loop, 350mm long. Supplied as standard with 4000 and 9000 E-mag ranges.	4000 and 9000 series E-mags only	Black
X036	Extended power loop. Various lengths up to 650mm long in 50mm increments.	4000 and 9000 series E-mags only	Black

Floor Springs

CODE	DESCRIPTION	SUITABILITY	FINISH
X050	Cover plates. Supplied as standard with the 2000, 3000 and 900 series.	All floor springs	SS, PS & PB
X051	Single action fitting strap, 16mm.	All floor springs	SS, PS & PB
X052	Single action fitting strap, 25mm. Supplied as standard with the 2000, 3000 and 900 series single action.	All floor springs	SS, PS & PB
X053	Single action top centre, 16mm.	All floor springs	SS, PS & PB
X054	Single action top centre, 25mm. Supplied as standard with the 2000, 3000 and 900 series single action.	All floor springs	SS, PS & PB
X055	Double action fitting strap. Supplied as standard with the 2000, 3000 and 900 series double action.	All floor springs	Zinc plated
X056	Double action top centre. Supplied as standard with the 2000, 3000 and 900 series double action.	All floor springs	SS, PS & PB
X057	Gel infill for improved water resistance.	All floor springs	N/A
X058	Extra height spindles. 5mm to 50mm in 5mm increments.	All floor springs	Black

Single Action:

Top Centre

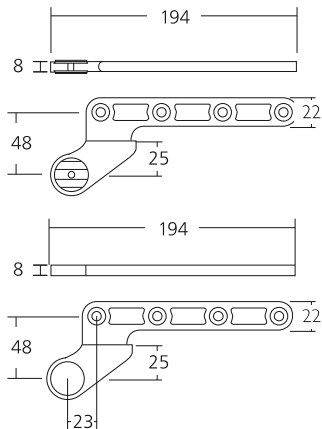

Strap

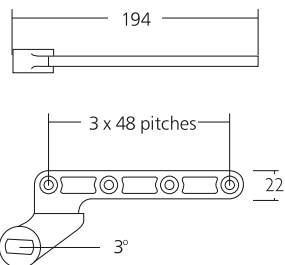

Strap cover



Double Action:

Top Centre

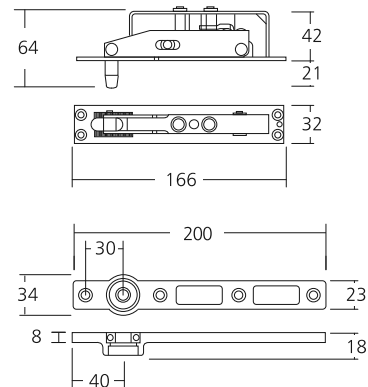

Strap

