

4" Rear Upturn Enclosed Work Tables

- * 18 gauge stainless steel.
- * Machine mold with manual welding.
- * Full range adjustable middle shelf.
- * Cabinets are available with hinged or sliding doors.
- * S/S 1-1/2" adjustable hex foot legs.
- * 4" rear upturn.

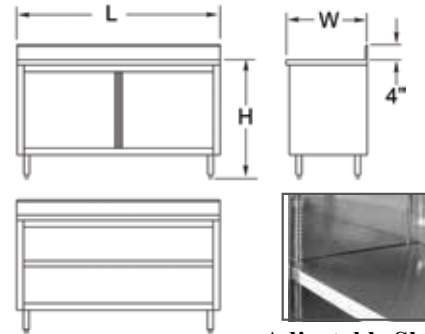

CTN-P2448



CTD-P2448H



CTD-P2448S

NO DOOR

Order No	W	L	H	Weight lbs/ea
CTN-P2436	24	36	35	101
CTN-P2448	24	48	35	127
CTN-P2460	24	60	35	153
CTN-P2472	24	72	35	202
CTN-P3036	30	36	35	109
CTN-P3048	30	48	35	134
CTN-P3060	30	60	35	158
CTN-P3072	30	72	35	218

HINGED DOORS

Order No	W	L	H	Weight lbs/ea
CTD-P2436H	24	36	35	117
CTD-P2448H	24	48	35	143
CTD-P2460H	24	60	35	171
CTD-P2472H	24	72	35	234
CTD-P3036H	30	36	35	125
CTD-P3048H	30	48	35	150
CTD-P3060H	30	60	35	176
CTD-P3072H	30	72	35	250

SLIDING DOORS

Order No	W	L	H	Weight lbs/ea
CTD-P2436S	24	36	35	117
CTD-P2448S	24	48	35	143
CTD-P2460S	24	60	35	171
CTD-P2472S	24	72	35	234
CTD-P3036S	30	36	35	125
CTD-P3048S	30	48	35	150
CTD-P3060S	30	60	35	176
CTD-P3072S	30	72	35	250

Cabinets (3~5)