

## Heavy Duty Aluminum Corner Brackets

- \* Pre-finished die cast aluminum.
- \* Easily fastened to pre-notched sheet metal under-shelf to provide strong, secure fitting.
- \* Rigid under-shelf support assemblies.
- \* Adjusting screws are provided for setting the under-shelf to any desired height.
- \* Fits 1-5/8" (41mm) or 1-1/2" (38mm) O.D. tubing.

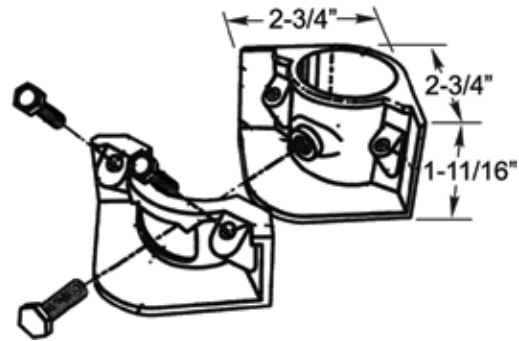

Order No	Description	Weight lbs/case	Pack/Case
B-CB	Aluminum Corner Bracket for 1-5/8" or 1-1/2" O.D Tubing	13	24

## Rubber Corner Bumper



Order No	Description	Weight lbs/case	Pack/Case
P-CB44	4" Grey Rubber Corner Bumper	15	50

## Heavy Duty Aluminum Brace Socket

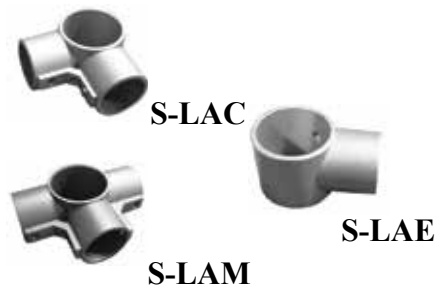

- \* Designed to mate 1-5/8" O.D. vertical legs and 1-1/4" O.D. horizontal cross rails.

Order No	Description	Weight lbs/case	Pack/Case
S-LAC	Aluminum Corner Cross Brace Socket	8.5	27
S-LAE	Aluminum End Cross Brace Socket	10.6	50
S-LAM	Aluminum Middle Cross Brace Socket	13.2	32

## Stainless Steel Round Grip

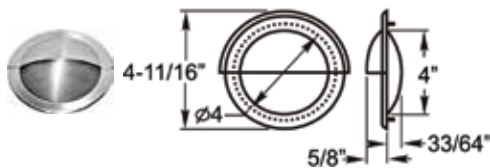

- \* Stainless steel finish.
- \* Thru studs, lock nuts provided.
- \* Beveled edge hard frame.

Order No	Description	Weight lbs/case	Pack/Case
P-RP5	S/S Round Grip 5" Dia	12	50

## Surface Mount Hinge

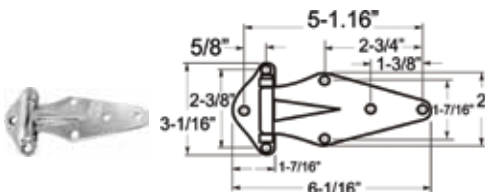

- \* Heavy gauge stainless steel with polished finish.
- \* Drilled and countersunk for 5mm screws.

Order No	Description	Weight lbs/case	Pack/Case
HI-BO6S	S/S Heavy Gauge Surface Mount Hinge for B.B.Q Oven	11	20