



SNUG PLUG USER GUIDE

SexToysFor.Men

OVERVIEW

b-Vibe™ Snug Plugs are incredibly sensual weighted butt plugs that can be worn comfortably and discreetly for extended wear stimulation. Snug Plugs can be worn during partner sex or enjoyed during solo play.

Snug Plugs are made of body-safe, seamless silicone and feature a thin, flexible neck and smooth grip handle.

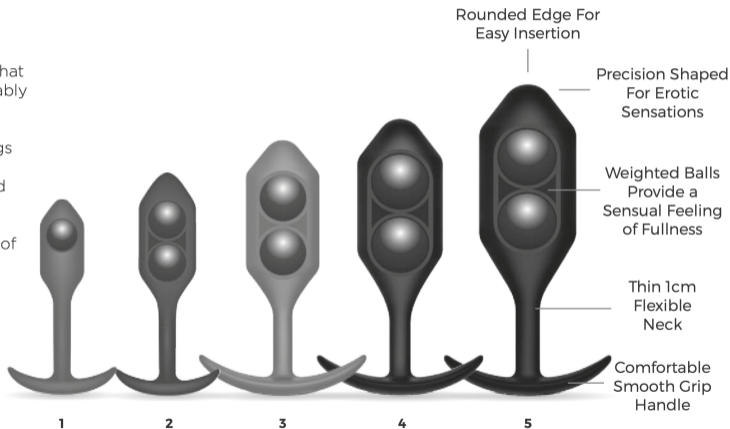

GETTING STARTED

1. Wash your plug with soap and water or a toy cleaner that is suitable for use with silicone items.



2. Lubricate your plug with a water-based, silicone compatible lubricant.



INSERTING YOUR SNUG PLUG

It may seem that the easiest way to insert your anal plug is to lubricate it and simply slide it in. That requires the anus to accommodate the widest portion of the toy, which might not always feel comfortable. If you're having difficulty getting your toy in, warm up with a finger or two first. Help your body open up before you try using a toy.

When you're ready for the toy, try inserting it until the widest point is at the external muscle. Then, slowly angle the toy downward about 45 degrees, so that one side of the bulb slides inside the anus. Keep the toy at that depth and then gently angle the toy upward about 45 degrees.

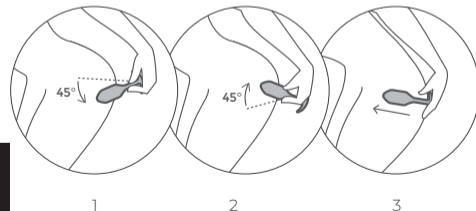

Email us at
fun@SexToysFor.Men
for any unanswered questions

INSERTING YOUR SNUG PLUG

Go back and forth like that a few times, gently going a bit further in with each change in direction. It's similar to the way you can get a tight pair of jeans on by shimmying your hips side to side, but a lot slower. Once the bulb is past the internal anal muscle, the toy should slip into place.

If you have any pain or discomfort during insertion, don't force it. That will only cause your body to tighten up more.

GETTING THE MOST FROM YOUR SNUG PLUG

Wearing an anal plug during sex or masturbation can take a little getting used to. It might feel amazing in one position and seem less comfortable in another one because different muscles are working. Everyone is a little different. Experiment to find the angle or position that feels best to you. Remember – if it doesn't feel quite right, change it up. Try a different angle of your hips or move in a different way.

You can also wear a plug during a romantic dinner date or a walk in the park. Some people like it because it feels extra naughty. If you're wearing it out in public, be sure to bring a plastic bag along in case you need to duck into a bathroom and take it out. You'll want somewhere to put it other than directly into your pocket or purse.



REMOVING YOUR SNUG PLUG

Some people report that they tighten down, especially after they orgasm, which can make it tricky to take an anal toy out. Fortunately, there are some tips to help.

Be gentle on the withdrawal, just like on the insertion. Hold the base in one hand and gently tug on it until you feel your body resisting. Keep that pressure and take a slow, deep breath.

As you exhale, bear down in the same motion as when you go to the bathroom. If the toy slides out, great! If not, try it again, but as you bear down, gently angle it down 45 degrees, just like you did when you inserted it. As one side of the bulb comes out, angle it up 45 degrees.

When the bulb comes out, it's easy to withdraw the rest of the toy quickly, but try to resist that temptation. Take it nice and slow so you can be gentle on your body. Even folks who are anal play regulars often report that going slow when they take their toys out works a lot better.

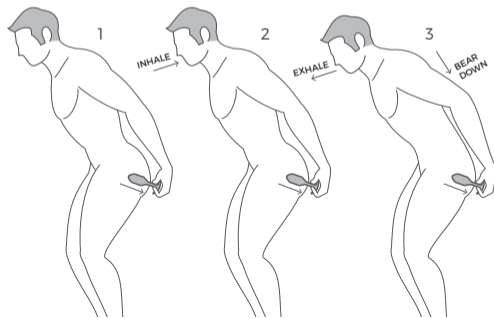

EXPERT ADVICE

b-Vibe Care

Cleaning, Storage & Safety

1. Always clean your plug thoroughly before and after each use.

2. We recommend premium water-based lubricant. Silicone-based lubricants are not recommended and can cause damage to the product.

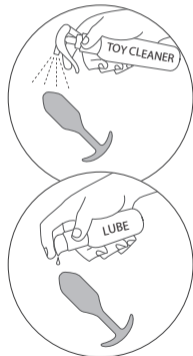

3. To properly clean your plug, wash with luke-warm water and a respected antibacterial soap. Rinse clean and pat dry using a lint-free cloth or towel. Do not use cleaners containing alcohol, petrol or acetone.

4. Avoid leaving your plug in direct sunlight and never expose it to extreme heat.

Should you require further assistance please contact:
fun@SexToysFor.Men



SPECIFICATIONS

Model	Snug Plug 1	Snug Plug 2	Snug Plug 3	Snug Plug 4	Snug Plug 5
Material	Body Safe Silicone / ABS				
Height	96 mm	115 mm	131 mm	142 mm	159 mm
Diameter	22 mm	31 mm	38 mm	44 mm	50 mm
Weight	55 g	114 g	180 g	257 g	350 g

Email us at
fun@SexToysFor.Men
for any unanswered questions

Designed and Developed by
b-Vibe™

Made in China
© 2019 **b-Vibe™**