

ELECTRIC FIREPLACE HEATER



ASSEMBLY INSTRUCTIONS

MADE IN CHINA

THE OWNER'S MANUAL CONTAINS IMPORTANT SAFETY INFORMATION AS WELL AS ASSEMBLY, USE AND MAINTENANCE INSTRUCTIONS. KEEP THE PACKAGING AND BAGS AWAY FROM CHILDREN AND DISPOSE OF ALL PACKAGING PROPERLY BEFORE USE. KEEP THIS MANUAL FOR FUTURE REFERENCE.



**PLEASE DO NOT
RETURN THIS
PRODUCT
TO THE STORE**

WE WILL BE HAPPY TO CORRECT ANY PROBLEMS THAT YOU MAY HAVE, OR ANSWER ANY OF YOUR QUESTIONS REGARDING THE PURCHASE OF THIS PRODUCT. PLEASE CONTACT US AT OUR TOLL FREE CUSTOMER SERVICE NUMBER 1-800-599-8898 FOR ANY ASSISTANCE AND REPLACEMENT PARTS.

THANK YOU.

Dist. by TDC USA, Inc. Fairfield, NJ 07004

©2021 All Rights Reserved.

Item: 32082

Made in China

www.tdcusainc.com

1. Carefully read all instructions before using this heater and retain these instructions for future reference.
2. Remove this heater from its packaging and check to make sure that the heater, cord, and plug are in good condition before use.
3. This heater is hot when in use. To avoid burns, do not let bare skin touch hot surfaces. If provided, use handles when moving this heater once unplugged.
4. If legs/feet are included with your heater, always assemble these parts before using.
5. Ensure that the heater is placed on a stable, level surface with 3ft of clearance from its surroundings.
6. Keep combustible materials such as furniture, pillows, bedding, paper, clothes, and curtains at least 3ft from the front and back of heater.
7. Extreme caution is necessary when heater is used where children, individuals with special needs, or pets are near.
8. Always turn all switches to the off position and unplug the heater when not in use. Always hold the plug firmly and then remove it from the wall outlet.
9. This heater is intended for supplemental heat and/or decorative purposes. Continuous use for several hours can impact the performance and life of the heater. This heater is not intended to be used in commercial, industrial, or agricultural settings.
10. Do not operate the heater with a damaged cord or plug, or if the heater has malfunctioned, dropped, or damaged in any manner.
11. This heater does not contain any serviceable parts. Do not attempt to open or repair this appliance.
12. Do not use outdoors. Exposure to the elements such as rain, snow, sun, wind, or extreme temperatures may cause the heater to become a safety hazard.
13. This heater is not intended for use in bathrooms, laundry areas, or similar indoor spaces. Never place heater where it may fall into a bathtub or other containers of water.
14. Never use GFCI (GFI) wall outlets to power this heater.
15. Do not run cord under carpeting. Do not cover the cord with throw rugs, runners, or similar floor coverings.
16. Do not run cord under furniture or other appliances.
17. Keeping the cord from crossing high traffic areas to prevent tripping hazards.
18. Do not insert or allow foreign objects to enter any ventilation or other openings which could cause electric shock, fire, or damage to the heater.
19. To prevent possible fire, do not block air intakes and exhaust in any way. Do not use on soft surfaces such as a bed, where opening may be blocked.
20. Heaters have hot, arcing, or sparking parts inside. Do not use where gasoline, paint, or other flammable liquids are used or stored.

21. Use this heater only as described within this manual. Any other use not recommended by the manufacturer or distributor may cause, electric shock, fire, or bodily injury.
22. Always plug the heater directly into a wall outlet. Never use with an extension cord, relocatable power tap, power strip/surge protector, plug adapter, multi-tap outlet adapters, cord reel, or with a plug-in air fresher device with built-in receptacle.
23. Do not modify the plug or heater in any way which may cause electric shock, fire, or bodily injury.
24. This heater must not be located directly underneath a wall outlet when in use.
25. Check the household voltage to ensure that it matches the heater's rated specifications.
26. Do not use while unattended. Turn the heater off before leaving your home or going to sleep.
27. Only use this heater for domestic purposes in the manner indicated within these instructions.
28. Check the cord and plug for damage from time-to-time. Never use this heater if the cord, plug, or heater shows any sign of damage.
29. Make sure the cord does not touch any hot surfaces.
30. Faulty wall outlets could cause the heater or outlet to overheat. Never plug the heater into a wall outlet that is old, shows signs of damage, or that has loose wiring or connections.
31. Do not cover the heater to avoid overheating and/or fire.
32. Do not use the heater near a bath, shower, or swimming pool.
33. Do not use if you have wet hands.
34. Before cleaning the heater, make sure it is turned off and unplugged and that it has adequate time to cool.
35. Do not submerge the heater in water to clean. Do not allow water to enter the housing of the heater during use or while in storage.
36. Always store the heater in a dry area, free of moisture when not in use.
37. Do not clean the heater with chemicals or abrasives solvents or with scouring pads or brushes.
38. Never clean the heater while plugged in.
39. Never use accessories that are not recommended or supplied by the distributor or manufacturer.
40. Never use the heater to dry clothes or other fabrics.
41. Never use external devices such as timers, programmer, external on and off switches, switch that turns it on and off automatically, or connected to an outlet that is turned on and off by a utility switch.
42. This heater is not a toy. Children should be supervised while this appliance is in use.
43. Cleaning and user maintenance should not be made by unsupervised children.
44. Only use this with a 120 volt grounded circuit.

1. Remove heater from box.
2. Make sure heater is not plugged in.
3. Flip heater upside down.
4. Each leg needs to be screwed on with 3 screws. (4 legs)

TOOLS NEEDED



Phillips head Screwdriver
(not included)

HARDWARE NEEDED



12 Phillips head screws
(included)

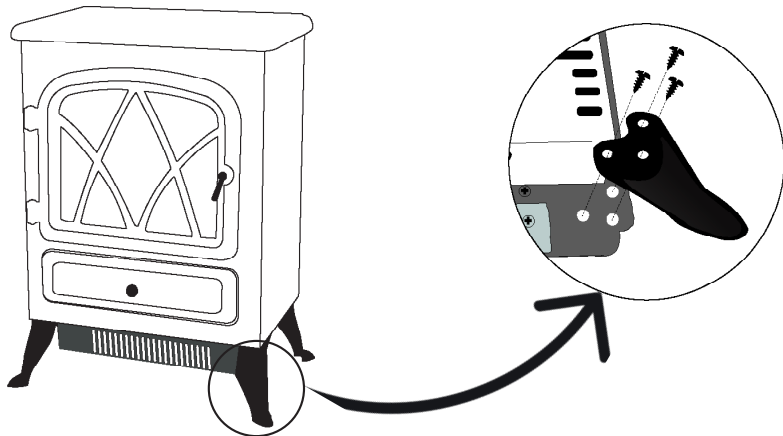

NOTICE

WHEN THE HEAT FUNCTION IS USED FOR THE FIRST TIME, A SLIGHT ODOR MAY BE PRESENT. THIS IS NORMAL AND SHOULD NOT OCCUR AGAIN UNLESS THE HEATER IS NOT USED FOR AN EXTENDED PERIOD OF TIME.

| BUTTON | ACTION / FUNCTION | INDICATION / RESULT |
|-----------|--|---|
| ON / OFF | <ol style="list-style-type: none"> 1. Press to turn on flame effect and enable heater. Heater switches will not work unless this switch is turned on. 2. Press again to shut off the power to all function. | <ol style="list-style-type: none"> 1. Flame effect turn on. The heater is now enabled. 2. Power lights, heaters, and flame effect turn off. |
| LOW HEAT | <ol style="list-style-type: none"> 1. With power turned on, press "I" to turn on low heat (750W). 2. Press again to turn off low heat. | <ol style="list-style-type: none"> 1. Heater and fan turn on low (750W). 2. Low heat and fan turn off. Flame stays on. |
| HIGH HEAT | <ol style="list-style-type: none"> 1. With power turned on, and low heat turned on, press "II" to turn on high heat. (1500W). Low heat must be on to use high heat. 2. Press "II" again to turn off high heat. | <ol style="list-style-type: none"> 1. Heater and fan turn on high (1500W). 2. High heat turns off. Low heat, fan, and flame stay on. |

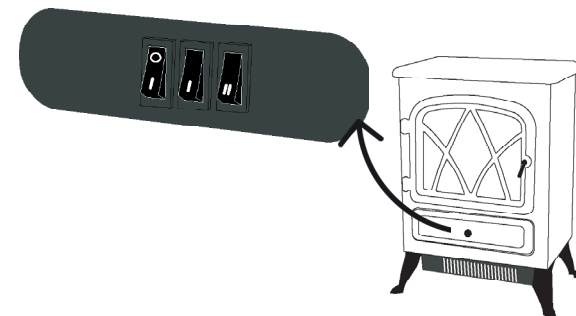

REPLACING YOUR BULB

1. Unplug from mains supply.
2. Loosen the three screws at the front of the log bed. And then take off the fixed plate.
3. Pull the log bed from the both ends to lift up the log bed decoration.
4. Two bulbs are located underneath (see the figure below).
5. Replace the bulbs with a 25W G9 halogen bulb.
6. Remove the defective bulb by pulling it out of the holder
7. Replace with a 25W G9 halogen bulb. Take care not to touch the bulb with bare hands and ensure that the bulb is pushed home.

To reassemble, follow the above instructions in reverse order.

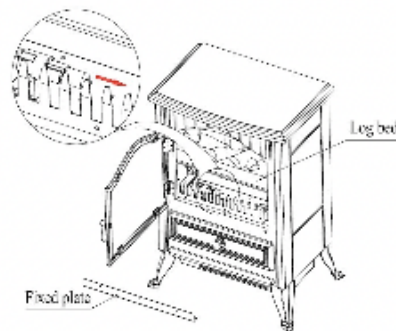
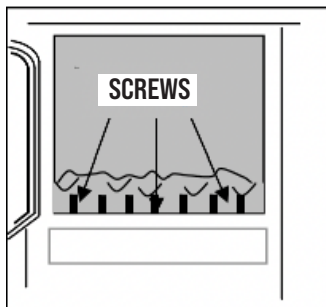

TECHNICAL SPECIFICATIONS

Voltage: 120V ~ 60Hz

AC Wattage: 1,500W

Lighting: 2 x 25W halogen bulb

Product Dimensions: 16.34" x 11.02" x 21.57"

Product Net WT.: 15.84 LBS

ELECTRIC FIREPLACE HEATER

Dist. by TDC USA, Inc. Fairfield, NJ 07004
 ©2021 All Rights Reserved. Made in China.
 Item: 32082

Questions and Comments
1-800-599-8898 (9 am - 5 pm EST)
www.tdcusainc.com