

install guide

shower caddy plastic mounting tab replacement



Plastic mounting tab PD4008
for BT1062, BT1109, and BT1064 shower caddies



video guide

Removal

1. Push one side of the tab out from basket. **Tip:** You may need to use a bit of force to push out the first side.

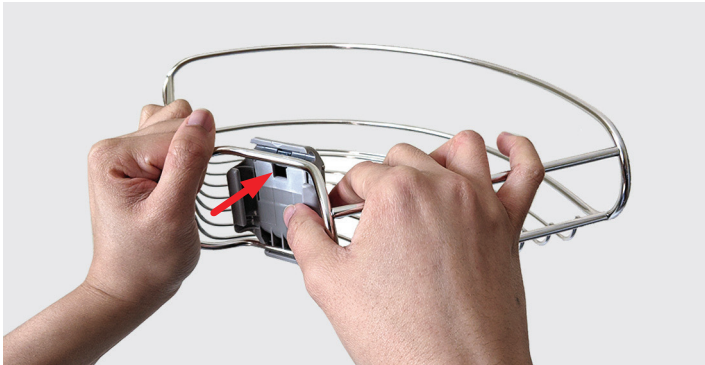

2. Pull tab off from other side to completely remove it from basket.

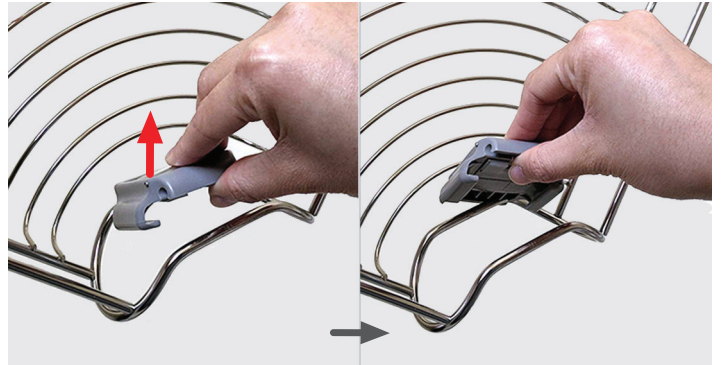

Installation

1. Align groove on one side of tab with basket.

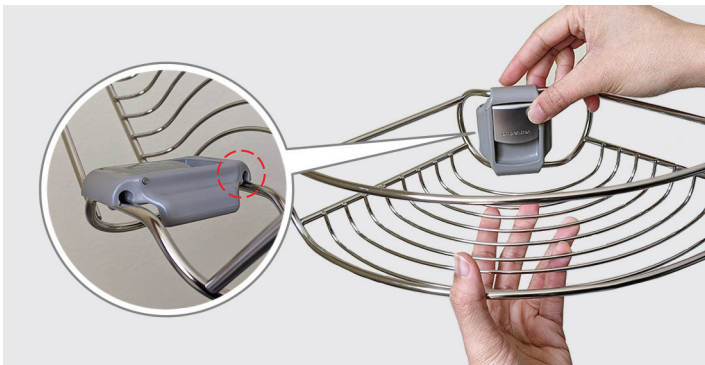

2. Snap aligned portion onto basket.



3. Repeat steps 1 & 2 for the other side of the tab.

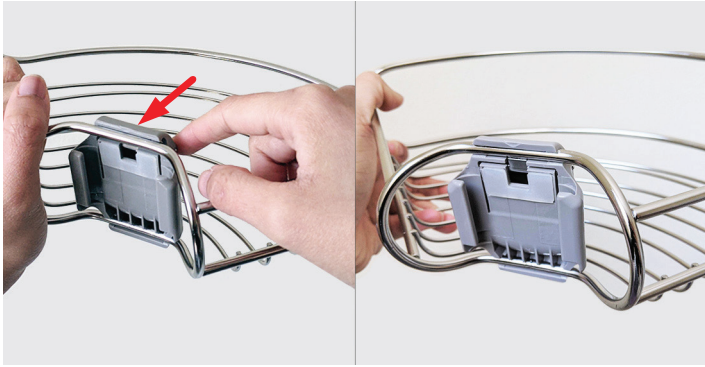

Final Result

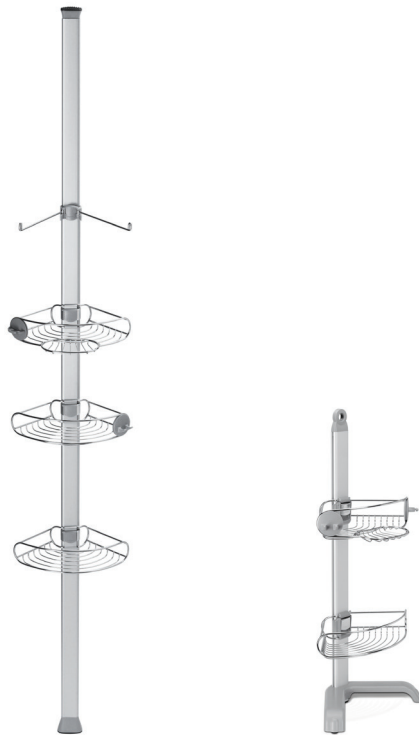

product questions or returns
customer.support@simplehuman.com