

install guide

classic rectangular step can plastic lid replacement



Lid assembly PD0290

for CW1950 38L rectangular step can with plastic lid
and CW1961 30L rectangular step can with plastic lid

Tools you need:

- rubber mallet
- flathead screwdriver

* Tip: A 5/16 in. flathead screwdriver fits perfectly into both slots for each hinge pin.



video guide

Removing Lid

1. Open lid and push it as far back as possible. Push lid lock forward to hold lid in place.



2. Remove vertical rods from both sides of lid.



3. Insert flathead screwdriver into pin slot on lid.

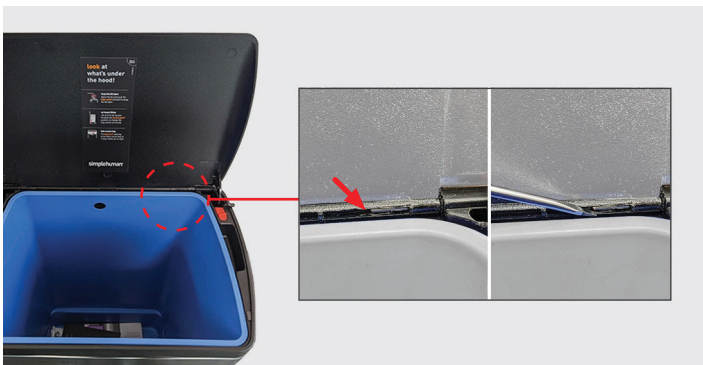

4. Use mallet to gently tap on screwdriver to push out the hinge pin.



5. Continue using mallet to tap on screwdriver until hinge pin starts to emerge from its hole. Remove pin once it is halfway out.



6. Repeat steps 3-5 on the other side of the lid.



7. Remove lid.



Replacing Lid

1. Place lid on to can in the open position. **Tip:** you can engage the lid lock to ensure lid stays upright.



2. Make sure lid is properly aligned with both pin holes on each side of can. Insert one hinge pin into each hole.



3. Manually push each pin in as far as possible.



4. Use mallet and flathead screwdriver to completely push pins into their holes.



5. Attach vertical rods to both sides of the lid.



Final Result



product questions or returns
customer.support@simplehuman.com