

H 39-43A

# WINDOW HANDLE LOCK

## FOR METAL CASEMENT WINDOWS

### Fitting instructions

- The lock is supplied in three main parts, the lock body, the bolt and the locking screw.
- Fully close the window handle and position the template provided, ensuring that the swing of the handle misses the bolt body. Centre punch hole centres and carefully drill holes using a 4.5mm (3/16") drill, to a depth of 4mm (5/32") (Fig 1). Please note: It is most important that only the specified size of the drill is used. DIY Tip: Mark your drill bit with adhesive tape at the required drill depth using (Fig 2) as a guide.
- Fix body using self-tapping screws provided (Fig 3).
- Insert bolt into body with tapped hole in lower position. Insert locking screw to secure bolt, and lock in uppermost position using key.
- To operate, turn key and rotate locking screw until bolt runs freely, then secure in locked or unlocked position. Note: It is not necessary to remove the locking screw once the lock is fitted. Check action and ensure that handle cannot be opened with bolt in locked position (Fig 4).

### Tools required

- Posidrive screwdriver
- Drill
- 4.5mm (3/16") drill bit
- Small hammer
- Centre punch

CM67K  
Issue 1



Ingersoll Security  
Wood Street, Willenhall,  
West Midlands WV13 1LA, England  
Tel: +44(0) 1902 364 627  
Fax: +44 (0) 1902 364 626

Minimum 65% Recycled Board Fibres



(Fig 1)

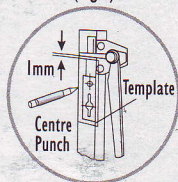

(Fig 2)

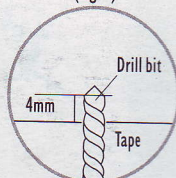

(Fig 3)

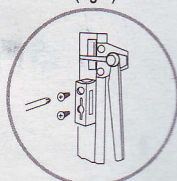

(Fig 4)

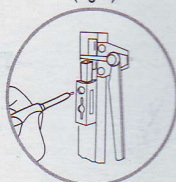

Ingersoll Security is an ASSA ABLOY Group Brand

ASSA ABLOY