

# STATICO

*Global Supplier of Static Control & Cleanroom Products*  
541 Taylor Way, Unit #1 Way. San Carlos, CA 94070. USA. [www.statico.com](http://www.statico.com)  
Tel.: (650)592-4733. 1-800-261-4149. Fax. 650-508-0761. [sales@statico.com](mailto:sales@statico.com)

## **Product Information** **Model S2333** **Wrist/Foot Strap Tester**



### **Description**

**Model S2333 is a Dual-Function precise tester designed to test standard single conductor wrist grounding strap assemblies and heel or toe grounders.**

## Features

- **Mode Selector Switch** on the front panel allows test mode selection
  - Wrist Strap **Push to the Right**
  - Foot Strap **Push to the Left**
- **4 Indicators**
  - Low Fail **Red LED (steady) & Audible Alarm**
  - Pass **Green LED (steady)**
  - High Fail **Red LED (steady) & Audible Alarm**
  - Low Battery **Yellow LED Blinking ( set at 6.5V)**
- **Battery Compartment** **Sliding lid on the back**
- **Test Button** **Applies power to the unit when depressed.**
- **External Power Receptacle** **On the left side panel allows use of the (Optional) AC/DC Adapter (Input: 120VAC 60Hz, Output: 9VDC 100mA).**
- **Foot Plate Connection** **Through receptacle on the left side panel.**
- **Dimensions** **5-1/2"X3"X1-1/2" (145X80X35mm).**

## Specifications

### **A. Wrist Strap Test Mode**

- \* **Test Range** **750Kilohm – 10Megohm**
- \* **Accuracy** **+/- 5%**
- \* **Power Source** **One 9VDC Alkaline Battery, or An (OPTIONAL) adapter.**

### **B. Foot Strap Test Mode**

- \* **Test Range** **750Kilohm – 100Megohm**

**\* Accuracy**  
**\* Power Source**

**+/- 5%**  
**One 9VDC Alkaline Battery, or**  
**An (OPTIONAL) adapter.**

### **Part Numbers**

**S2333-TO**  
**S2333-PC**

**Wrist/Foot Strap Tester Only**  
**Wrist/Foot Strap Tester with**  
**Foot Plate & the Connecting**  
**Cord.**

**S2333-AD**

**Optional Adapter**

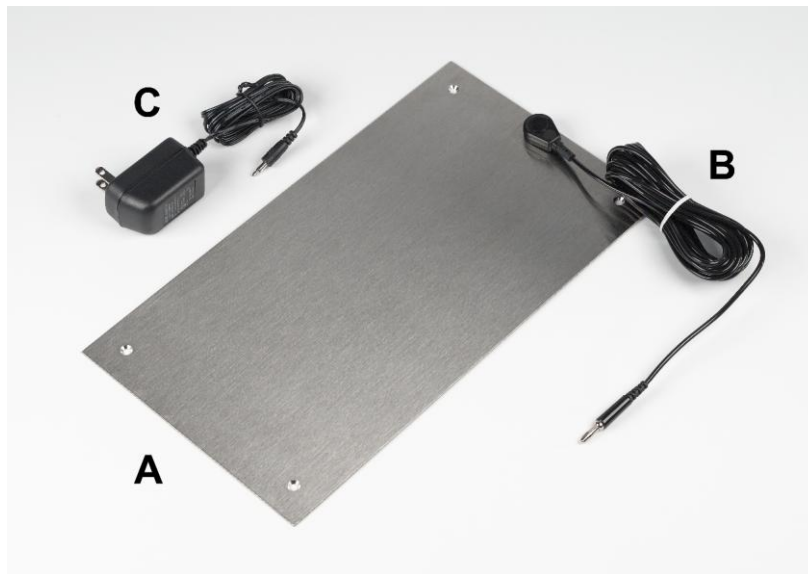

**A. Foot Plate**  
**B. Connecting Cord**  
**C. Optional Adapter**