

robart HOW-TO Series Scale Strut Covers

Molded Scale Landing Gear Struts

These highly detailed molded struts are the last word in "dressing up" that bare landing gear wire. These are life-like accessories which remove the drudgery of disguising bare wire the old fashioned way with balsa wood and gummed tape. The end result is equal to or surpasses the efforts of a master craftsman.

Two types of strut are available... STRAIGHT and OFFSET.

The **straight** strut can be used on scale or semi scale models as the Corsair, P-40, B-25, Spitfire, Hurricane, and Chipmunk, to name but a few.

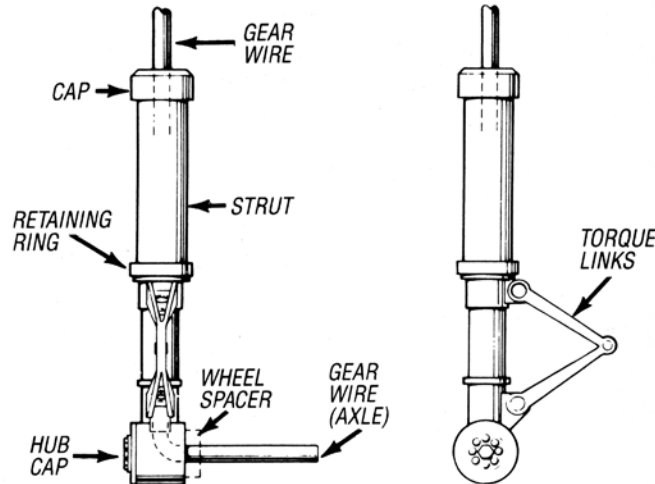

The **offset** type of strut is ideal for models of the P-51, AT-6/SNJ, even the P-47 or Sea Fury with very slight modifications i.e. slight thinning of the lower, offset portion, although for sport purposes this is not strictly necessary.

Illustration shows how a landing gear door can be attached by drilling thru the lugs on the retaining ring, then installing a wire door link to pull the door closed as the landing gear retracts.

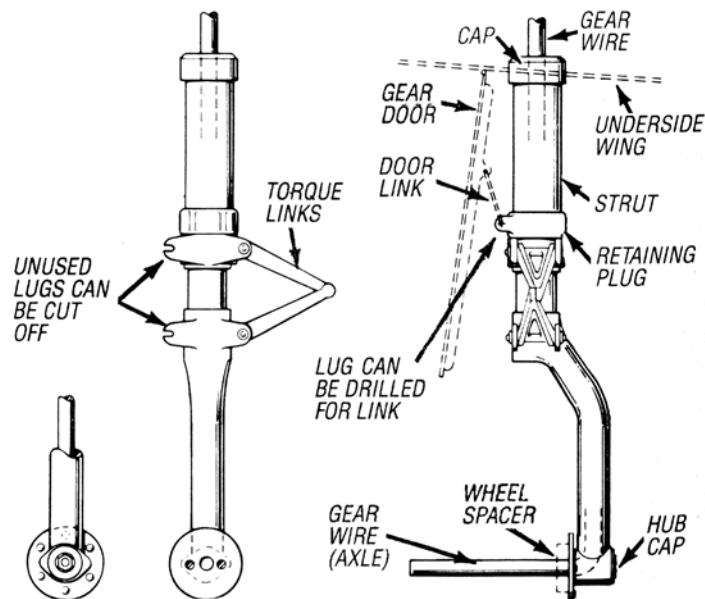

Study the prototype you are modeling. You might find that the airplane you are modeling does not have torque links on its landing gear (in which case you may remove yours by cutting and filing) or, the links might point forward or back, so you will attach your struts accordingly.

1. Carefully remove the parts from the runners or "trees" to which they are attached. **Do not** attempt to break them off as this will certainly damage the components, especially the more delicate parts of the torque links. Use a sharp hobby knife or a new, stiff backed razor blade to cut each part free.
2. If using the **offset** strut, the landing gear wire should be bent to fit the pattern supplied. (If the model is built from a kit, the pre-bent gear wire might need to be modified to fit the pattern.)
3. If the gear wires are already permanently attached to the model the cap and retaining ring should be slipped up over the leg and up to the top end.
4. Assemble both halves of the strut over the wire. (On the **straight** strut, the hub must be threaded over the wire axle.) **Be Sure** the torque links are facing in the correct direction i.e. forward or back, as required.
5. Depending on the size of the wheel to be used with the **offset** strut, it might be necessary to shorten the lower part by cutting off a section. It is also good practice to file or trim (with a #11 X-ACTO blade) a small "arch" to fit over the axle.

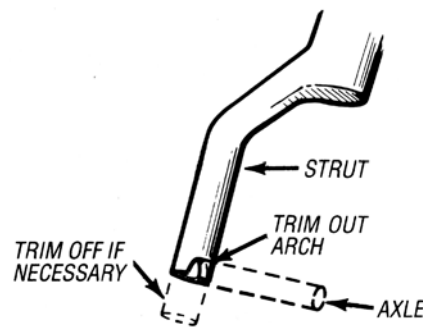

6. Some landing gears are made with a coil at the top to provide some backward shock absorbing. Where there is a coil the top part of the strut can be cut down to finish below it **or** a notch can be cut to fit **around** it. There is a bonus gained by the latter – the strut partly hides the somewhat unsightly coil.

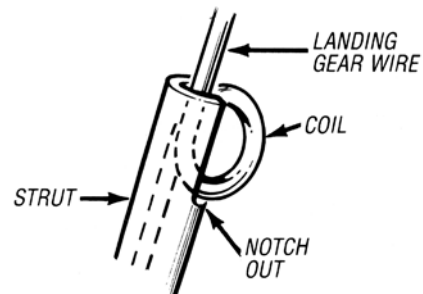

7. Bring both halves of the strut together, insert and gently tighten the machine screws. Some might want to also glue the two parts of the strut together and make them a permanent fixture on the wire. Suitable glues are PACER PLASTIC-ZAP® CA++, Testor's Plastic Model Cement, or RTV pipe cement as used by plumbers to join PVC pipes (available from the hardware store).
8. Push the retaining ring down the strut until it stops against the molded flange. If operating landing gear doors are intended, be sure the lugs are facing in the required direction on the **offset** struts.
9. Apply glue to the inside of the flange on the cap then slide it down and press it firmly over the top of the strut.
10. Depending on your strut type, screw or glue the hubcap in place.
11. Slide the wheel spacer over the axle then fit your Robart Scale Wheels to give added quality to the appearance of your model.

Straight Strut Exploded View

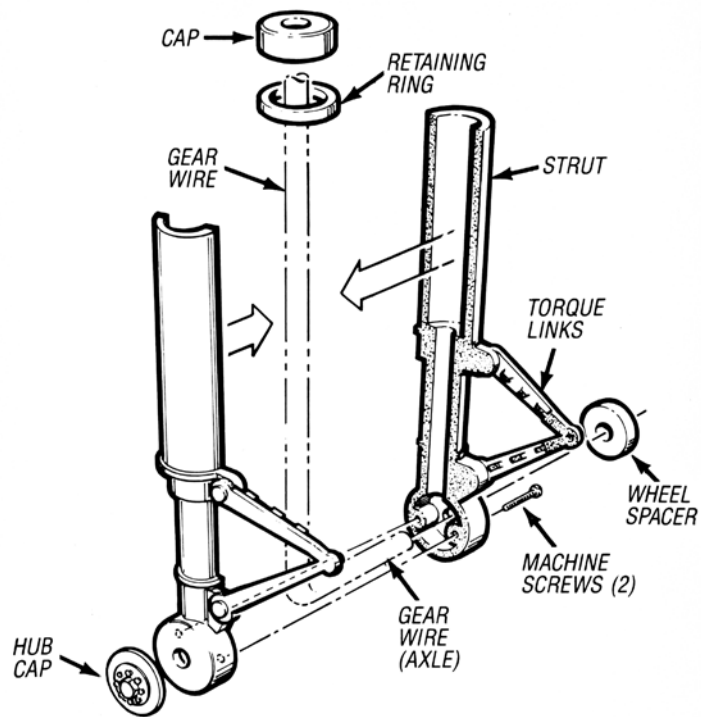

Offset Strut Exploded View

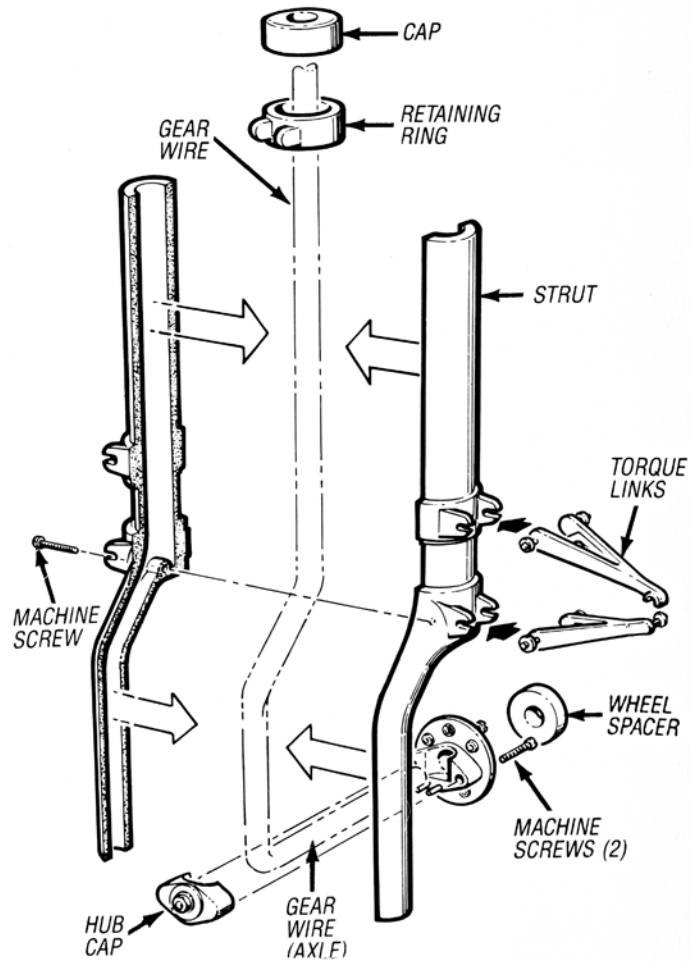

Painting The Struts

Before painting, the assembled strut should be thoroughly degreased to remove the oil contamination from your skin. Use an old toothbrush and a mild detergent solution followed by a thorough rinse under running water. Gentle flow from a garden hose works well but take care if the landing gear is still attached to the model!

Be sure to use paints which are not attacked by model fuel. We recommend hobby epoxy paints or urethane paints, both of which are readily available at your usual hobby store.

Customizing

Examine full size airplanes and you will notice that the landing gear telescopes in its spring action. The sliding portion left exposed is brightly polished and this is easily simulated by silver paint, or better yet, a strip of chrome Monokote trim, or a strip of bright mylar foil (found in some packing or greeting cards) glued around the strut using regular contact cement such as Goodyear Pliobond.

