

SPARE PARTS LIST

QTY.	ITEM NO.	DESCRIPTION	PART NUMBER
1	1	SIDE PLATE (LH)	148036M
1	2	SIDE PLATE (RH)	148037M
1	3	TRUNION ASSEMBLY	148112A
1	4	OLEO RAM ASSEMBLY	150104A
1	5	ROTATION STRUT - RH	150123A
1	6	ROTATION STRUT - LH	150124A
1	7	LIFT LINK ASSEMBLY	148105A
1	8	LOWER LIFT LINK	148028M
1	9	ASSEMBLED ACTUATOR	148E-108A
2	10	ACTUATOR SPACER	148E009M
1	11	CLEVIS PIN	150018M
7	12	E-CLIP	1039F
8	13	#4 X 1/4 PPHMS	1026F
2	14	#4-40 SHOULDER BOLT	1201F
1	15	CAM FOLLOWER	148102A
3	16	CLEVIS PIN	150002M
1	17	CAM FRAME - RH	150047M
1	18	CAM FRAME - LH	150049M
1	19	CAM BALL	150032M
1	20	CLEVIS PIN	150010M
2	21	CLEVIS PIN	150033M
2	22	#10-32 BHCS	1021F
1	23	COMPRESSION SPRING	150019P
1	24	TORQUE LINK ASSEMBLY	150107A
1	25	ADJ. TORQUE LINK MOUNT - RH	150110A
1	26	ADJ. TORQUE LINK MOUNT - LH	150111A
1	27	SPACER BRACKET - RH	150051M
1	28	SPACER BRACKET - LH	150050M
2	29	#4-40 X 1/4" BHMS	1047F
2	30	#4-40 HEX NUT	1035F
1	31	LIFT YOKE PIVOT PIN	150004M
2	32	#4-40 x 3/16" BHSMS	1022F
1	33	#4 X 3/8 PPHSMS	1012F
2	34	FLANGE ADAPTER	ESMC001M
4	35	#8-32 LOCK NUT	1124F
4	36	#8-32 X 3/8" SHCS	1110F

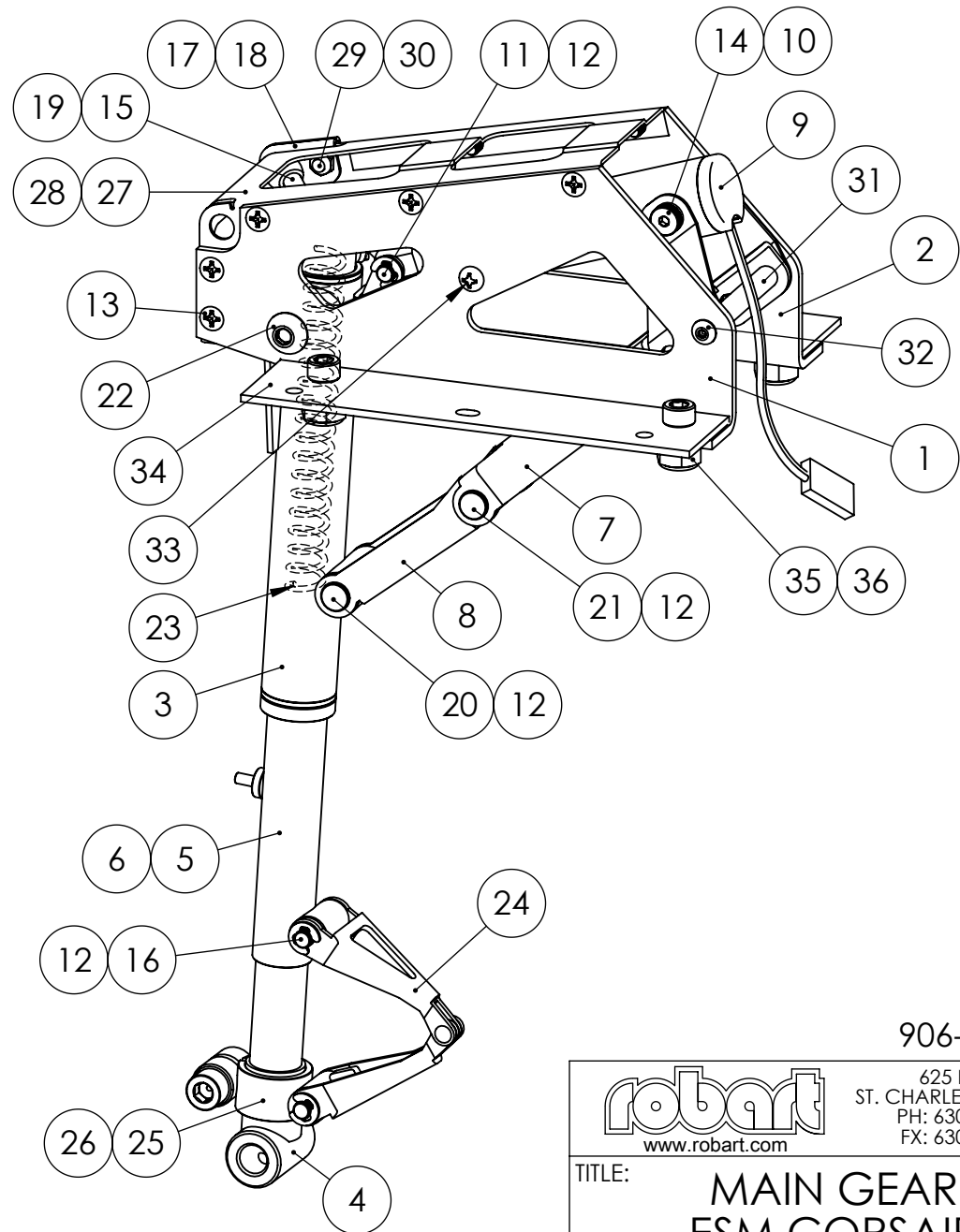

906-381M



625 N. 12TH ST.
ST. CHARLES, IL 60174
PH: 630-584-7616
FX: 630-584-3712

TITLE: **MAIN GEAR
ESM CORSAIR
RH SHOWN**

PROPRIETARY AND CONFIDENTIAL
THE INFORMATION CONTAINED IN THIS DRAWING IS THE SOLE PROPERTY OF ROBART MANUFACTURING. ANY REPRODUCTION IN PART OR AS A WHOLE WITHOUT THE WRITTEN PERMISSION OF ROBART MANUFACTURING IS PROHIBITED.

	NAME	DATE
DRAWN	J.REHAK	04OCT12
CHECKED		

ESMCESPM

REV -