

Universal drilling template

Web-Link

assemblydevices.blum.com



Symbol image

- For marking or pre-drilling the fixing positions of front fixings including gallery, drawer back and base (only METABOX quick assembly version C15) as well as for AVENTOS front fixings
- Stop setting via the calibration
- Material: nylon/steel

Assembly possibilities

AVENTOS
 TANDEMBOX intivo
 TANDEMBOX antaro
 TANDEMBOX plus
 METABOX
 MOVENTO
 TANDEM

Order information

	Part no.
Universal drilling template	ZML.0040

Composed of:

Universal drilling template	1 x
Drilling depth spacer Ø 10 mm	1 x
Drilling depth spacer Ø 5 mm	1 x
Marking template Ø 10 mm	1 x
Marking template Ø 5 mm	1 x

Page instructions

Overview – templates, jigs and assembly devices

609

Assembly possibilities

AVENTOS

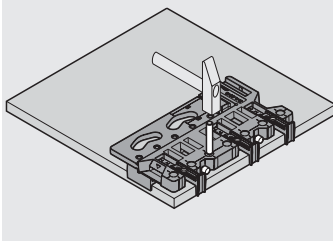

Front assembly

- Set stops using the calibration
- Pre-drill or mark fixing positions for inline or cruciform mounting plates for AVENTOS HF as well as front fixings for AVENTOS HS, HL, HK, HK-S

TANDEMBOX intivo/TANDEMBOX antaro/TANDEMBOX plus/METABOX/MOVENTO/TANDEM

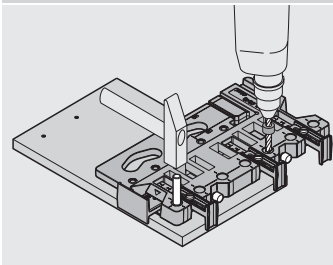

Front assembly

- Set stops using the calibration
- Drill or mark fixing positions for front fixings including gallery

METABOX

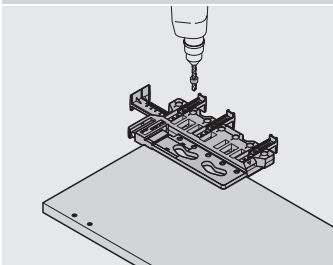

Drawer assembly – back

- Set stops using the calibration
- Mark fixing positions

Drawer assembly – METABOX C15 base

- Position template on drawer base
- Pre-drill pegs (Ø 5 mm)