

Universal individual template

Web-Link

assemblydevices.blum.com



Symbol image

- Template for pre-drilling the fixing positions for cabinet profiles, lift mechanisms, mounting and adapter plates
- The template can be used with assembled and unassembled cabinets
- Depth position setting using calibration
- Suitable for overlay and inset applications
- For system and chipboard screws
- Assembly on a marking line
- Material: nylon/steel/aluminium

Assembly possibilities

AVENTOS
 CLIP top BLUMOTION/CLIP top
 MODUL
 TANDEMBOX intivo
 TANDEMBOX antaro
 TANDEMBOX plus
 METABOX
 MOVENTO
 TANDEM
 STANDARD

Order information

	Part no.
Universal individual template	65.1051.01

Composed of:

Universal individual template	1 x
Drilling depth spacer Ø 5 mm	1 x
Reducing bush Ø 5 to Ø 2.5 mm	1 x
Allen key	1 x

Accessories

	Add-on for SPACE CORNER	Part no.
		65.1107

Page instructions

Overview – templates, jigs and assembly devices

609

Assembly possibilities

AVENTOS

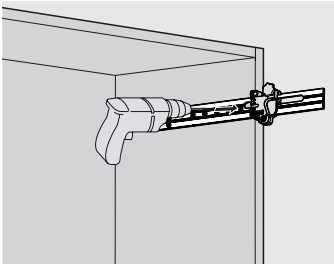

Cabinet assembly

- Set template depth position using the calibration
- Position template in cabinet on marking line
- Pre-drill fixing positions for lift mechanism pegs

CLIP top BLUMOTION/CLIP top/MODUL

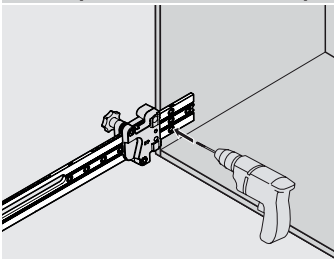

Hinge system assembly

- Set template depth position using the calibration
- Position template on marking line
- Pre-drill fixing positions for mounting and adapter plates (BLUMOTION/TIP-ON for doors)

TANDEMBOX intivo/TANDEMBOX antaro/TANDEMBOX plus/METABOX/MOVENTO/TANDEM/STANDARD

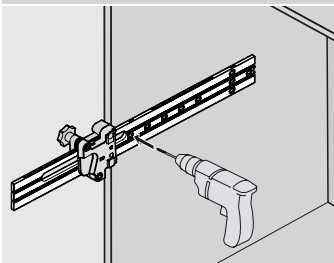

Cabinet assembly

- Set template depth position using the calibration
- Position template on marking line
- Pre-drill fixing positions for cabinet profiles
- Pre-drill fixing positions for BLUMOTION for METABOX
- The additional part (65.1107) enables SPACE CORNER assembly