

# VCT.p

## Lobe knobs

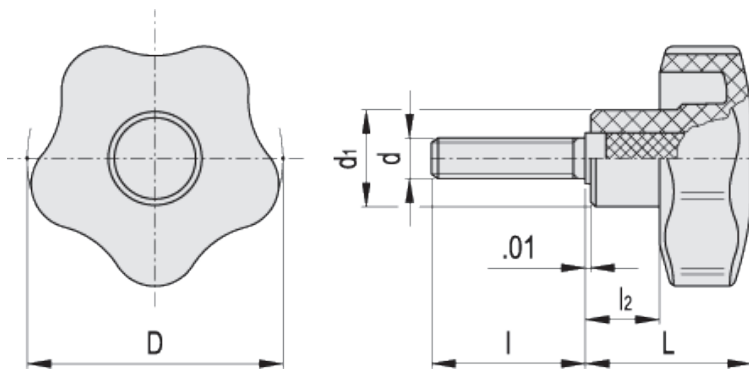

ELESA Original design



american unit  
metric unit

RAL9005

Elesa Standard		Main dimensions				Threaded stud		C #	Weight
Code	Description	D	L	d <sub>1</sub>	l <sub>2</sub>	d <sub>2A</sub>	l	[ft·lb] [Nm]	lbs g
969813	VCT.25 p-10-32x1/2	0.98 25	0.75 19	0.51 13	0.31 8	10-32 -	0.500 -	4 6	0.018 8
969815	VCT.25 p-10-32x3/4	0.98 25	0.75 19	0.47 12	0.31 8	10-32 -	0.750 -	4 6	0.02 9
969817	VCT.25 p-10-32x1	0.98 25	0.75 19	0.47 12	0.31 8	10-32 -	1.000 -	4 6	0.022 10
969823	VCT.25 p-1/4-20x1/2	0.98 25	0.75 19	0.47 12	0.31 8	1/4-20 -	0.500 -	4 6	0.029 13
969825	VCT.25 p-1/4-20x3/4	0.98 25	0.75 19	0.47 12	0.31 8	1/4-20 -	0.750 -	4 6	0.033 15
969827	VCT.25 p-1/4-20x1	0.98 25	0.75 19	0.47 12	0.31 8	1/4-20 -	1.000 -	4 6	0.037 17
969851	VCT.32 p-1/4-20x1/2	1.26 32	0.91 23	0.59 15	0.39 10	1/4-20 -	0.500 -	6 8	0.026 12
969852	VCT.32 p-1/4-20x3/4	1.26 32	0.91 23	0.59 15	0.39 10	1/4-20 -	0.750 -	6 8	0.031 14
969854	VCT.32 p-1/4-20x1	1.26 32	0.91 23	0.59 15	0.39 10	1/4-20 -	1.000 -	6 8	0.035 16

Elesa Standard		Main dimensions				Threaded stud		C #	Weight
Code	Description	D	L	d <sub>1</sub>	l <sub>2</sub>	d <sub>2A</sub>	l	[ft·lb] [Nm]	lbs g
969856	VCT.32 p-1/4-20x1½	1.26 32	0.91 23	0.59 15	0.39 10	1/4-20 -	1.500 -	6 8	0.037 17
969861	VCT.32 p-5/16-18x3/4	1.26 32	0.91 23	0.59 15	0.39 10	5/16-18 -	0.750 -	6 8	0.04 18
969863	VCT.32 p-5/16-18x1	1.26 32	0.91 23	0.59 15	0.39 10	5/16-18 -	1.000 -	6 8	0.046 21
969901	VCT.40 p-1/4-20x1/2	1.57 40	1.06 27	0.67 17	0.47 12	1/4-20 -	0.500 -	10 13	0.033 15
969902	VCT.40 p-1/4-20x3/4	1.57 40	1.06 27	0.67 17	0.47 12	1/4-20 -	0.750 -	10 13	0.04 18
969903	VCT.40 p-1/4-20x1	1.57 40	1.06 27	0.67 17	0.47 12	1/4-20 -	1.000 -	10 13	0.042 19
969911	VCT.40 p-5/16-18x3/4	1.57 40	1.06 27	0.67 17	0.47 12	5/16-18 -	0.750 -	12 16	0.055 25
969913	VCT.40 p-5/16-18x1	1.57 40	1.06 27	0.67 17	0.47 12	5/16-18 -	1.000 -	12 16	0.059 27
969915	VCT.40 p-5/16-18x1¼	1.57 40	1.06 27	0.67 17	0.47 12	5/16-18 -	1.250 -	12 16	0.066 30
969917	VCT.40 p-5/16-18x1½	1.57 40	1.06 27	0.67 17	0.47 12	5/16-18 -	1.500 -	12 16	0.073 33
969961	VCT.50 p-5/16-18x1	1.97 50	1.26 32	0.75 19	0.55 14	5/16-18 -	1.000 -	12 16	0.066 30
969965	VCT.50 p-5/16-18x1½	1.97 50	1.26 32	0.75 19	0.55 14	5/16-18 -	1.500 -	12 16	0.077 35
969969	VCT.50 p-3/8-16x3/4	1.97 50	1.26 32	0.75 19	0.55 14	3/8-16 -	0.750 -	17 23	0.088 40
969971	VCT.50 p-3/8-16x1	1.97 50	1.26 32	0.75 19	0.55 14	3/8-16 -	1.000 -	17 23	0.099 45
969973	VCT.50 p-3/8-16x1¼	1.97 50	1.26 32	0.75 19	0.55 14	3/8-16 -	1.250 -	17 23	0.11 50
969975	VCT.50 p-3/8-16x1½	1.97 50	1.26 32	0.75 19	0.55 14	3/8-16 -	1.500 -	17 23	0.121 55
970021	VCT.63 p-3/8-16x3/4	2.48 63	1.46 37	0.87 22	0.63 16	3/8-16 -	0.750 -	27 37	0.11 50
970022	VCT.63 p-3/8-16x1	2.48 63	1.46 37	0.87 22	0.63 16	3/8-16 -	1.000 -	27 37	0.121 55
970023	VCT.63 p-3/8-16x1¼	2.48 63	1.46 37	0.87 22	0.63 16	3/8-16 -	1.250 -	27 37	0.132 60
970024	VCT.63 p-3/8-16x1½	2.48 63	1.46 37	0.87 22	0.63 16	3/8-16 -	1.500 -	27 37	0.143 65
970027	VCT.63 p-3/8-16x2	2.48 63	1.46 37	0.87 22	0.63 16	3/8-16 -	2.000 -	27 37	0.154 70
970032	VCT.63 p-1/2-13x1½	2.48 63	1.46 37	0.87 22	0.63 16	1/2-13 -	1.500 -	34 46	0.165 75
970034	VCT.63 p-1/2-13x2	2.48 63	1.46 37	0.87 22	0.63 16	1/2-13 -	2.000 -	34 46	0.176 80
970081	VCT.74 p-3/8-16x1	2.91 74	1.71 43.5	1.02 26	0.87 22	3/8-16 -	1.000 -	34 46	0.187 85
970083	VCT.74 p-1/2-13x1¼	2.91 74	1.71 43.5	1.02 26	0.87 22	1/2-13 -	1.250 -	50 68	0.198 90
970085	VCT.74 p-1/2-13x2	2.91 74	1.71 43.5	1.02 26	0.87 22	1/2-13 -	2.000 -	50 68	0.209 95

# "Max limit Tightening torque" means the max torque value at which the metal insert, in normal conditions of use, is perfectly and strongly anchored to the plastic material.

Elesa Standards		Main dimensions				Threaded stud		C #	Weight
Code	Description	D	L	d <sub>1</sub>	l <sub>2</sub>	d <sub>6g</sub>	l	[ft·lbf] [Nm]	lbs g
69822	VCT.25 p-M5x16	0.98 25	0.75 19	0.51 13	0.31 8	- M5	0.63 16	4 6	0.018 8
69832	VCT.25 p-M6x16	0.98 25	0.75 19	0.51 13	0.31 8	- M6	0.63 16	4 6	0.02 9
69851	VCT.32 p-M6x16	1.26 32	0.91 23	0.59 15	0.39 10	- M6	0.63 16	6 8	0.029 13
69852	VCT.32 p-M6x20	1.26 32	0.91 23	0.59 15	0.39 10	- M6	0.79 20	6 8	0.031 14
69861	VCT.32 p-M8x20	1.26 32	0.91 23	0.59 15	0.39 10	- M8	0.79 20	6 8	0.04 18
69911	VCT.40 p-M8x16	1.57 40	1.06 27	0.67 17	0.47 12	- M8	0.63 16	12 16	0.051 23
69913	VCT.40 p-M8x25	1.57 40	1.06 27	0.67 17	0.47 12	- M8	0.98 25	12 16	0.057 26
69917	VCT.40 p-M8x45	1.57 40	1.06 27	0.67 17	0.47 12	- M8	1.77 45	12 16	0.07 32
69971	VCT.50 p-M10x20	1.97 50	1.26 32	0.75 19	0.55 14	- M10	0.79 20	17 23	0.079 36
69973	VCT.50 p-M10x30	1.97 50	1.26 32	0.75 19	0.55 14	- M10	1.18 30	17 23	0.09 41
69977	VCT.50 p-M10x50	1.97 50	1.26 32	0.75 19	0.55 14	- M10	1.97 50	17 23	0.112 51
70032	VCT.63 p-M12x30	2.48 63	1.46 37	0.87 22	0.63 16	- M12	1.18 30	34 46	0.148 67
70085	VCT.74 p-M12x50	2.91 74	1.71 43.5	1.02 26	0.87 22	- M12	1.97 50	50 68	0.216 98

# "Max limit Tightening torque" means the max torque value at which the metal insert, in normal conditions of use, is perfectly and strongly anchored to the plastic material.

#### Material

High resilience polypropylene based (PP) technopolymer.  
VCT.25 made out of glass-fibre reinforced polyamide based (PA) technopolymer.  
Resistant to solvents, oils, greases and other chemical agents.

#### Colour

Black, matte finish.  
On request and for sufficient quantities, it can be supplied in other colours or with customised graphic symbols, marks or writings.

#### Centre cap

Technopolymer in black colour or in other colours from C2 to C6 ([VCT.p](#) with centre cap in colour).

#### Standard executions

Treaded stud with chamfered flat end according to ISO 4753 available in:  
- white zinc-plated steel threaded stud, for inch size (see [Technical Data](#)).  
- zinc-plated steel threaded stud, for metric size.



STANDAARD MACHINE ELEMENTS WORLDWIDE

ELESA models all rights reserved in accordance with the law. Always mention the source when reproducing our drawings.