

PO Box 774
Lebanon, NH 03766
sales@yetisolar.com
www.yetisolar.com



Hello!

Congratulations on your new lighting motion sensor from **Yeti Solar**, LLC. Want a light that comes on automatically when you approach it? Tired of fumbling for a switch? Want to choose your own time delay (how long the light stays on)? This motion sensor has you covered. With the instructions below, you can have your motion sensor installed and working in just a few minutes.

Thank you for your purchase!

- The Yeti Solar, LLC team

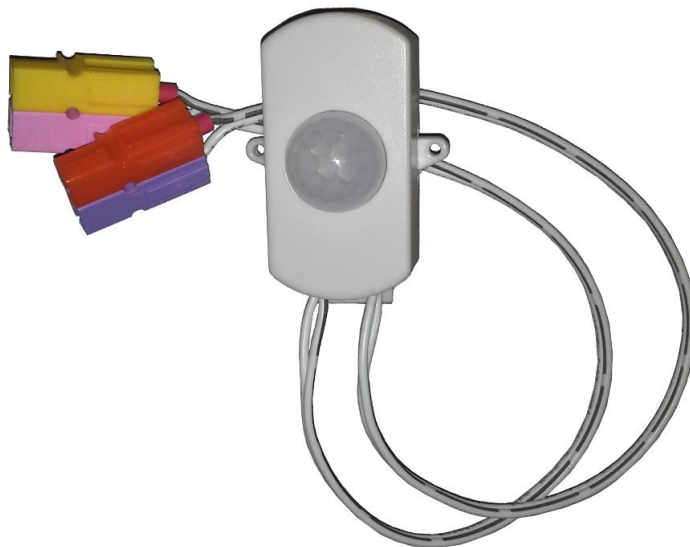

Things you Should Know

- This motion sensor is **not waterproof or outdoor-rated**.
- This motion sensor has a **maximum range of 5 to 7 meters** (about 15 to 20 feet). This motion sensor should be used with **12VDC Yeti Solar lights only** (LightPortal™, LightPassage™ or Exclamation Light™).
- This motion sensor takes over the function of the switch on your light fixture. So, you need to **turn on the switch on your light fixture** and leave it that way after you install the motion sensor, or the motion sensor won't be able to turn the light fixture on!

How to Install a Motion Sensor for your LightPortal™/LightPassage™

Step 1. If the LightPortal™¹ is already installed, **disconnect and remove the battery** from the LightPortal™ light fixture.

Step 2. **Disconnect the pink-and-yellow** pair of click-connects **from the purple-and-orange** pair of click-connects in the LightPortal™ between the charge controller and the LEDs (inside the light fixture).

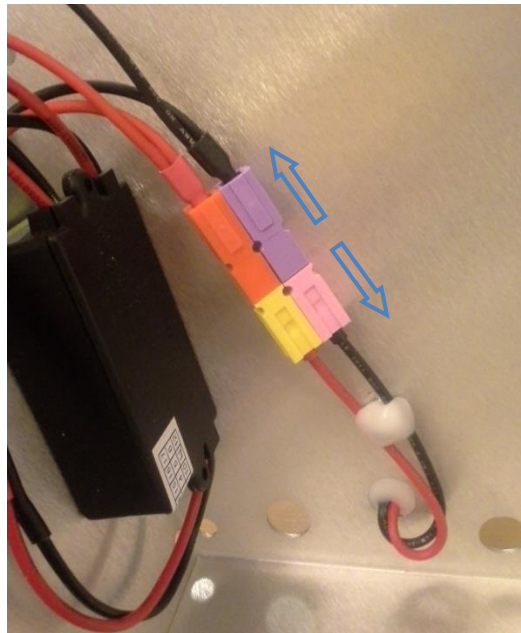

¹ All of these steps are the same for the LightPassage™ as for the LightPortal™.

Step 3. Connect the purple-and-orange pair of click-connects from the motion sensor to the purple-and-orange pair of quick connects in the LightPortal™ (wires coming from the charge controller). Make sure to connect purple to purple and orange to orange.

Step 4. Connect the pink-and-yellow pair of click-connects from the motion sensor to the pink-and-yellow pair of quick connects in the LightPortal™ (wires coming from the LEDs). Make sure to connect pink to pink and yellow to yellow.

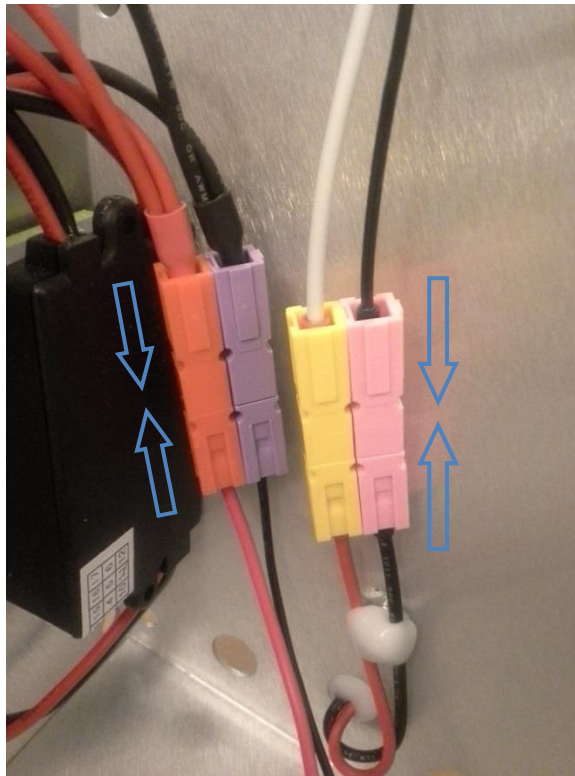

Step 5. Mount the motion sensor to the wall near the LightPortal™, by peeling the paper off the adhesive strips on the back and pressing firmly to the wall. Leave enough slack in the wires so that there is space to put the battery back in the LightPortal™!

Step 6. Re-insert the battery into the LightPortal™ and reconnect it. Congratulations, you're done!

How to Install a Motion Sensor for your Exclamation Light™

Step 1. Disconnect the blue-and-white pair of click-connects between the LightPortal™ and the Exclamation Light.

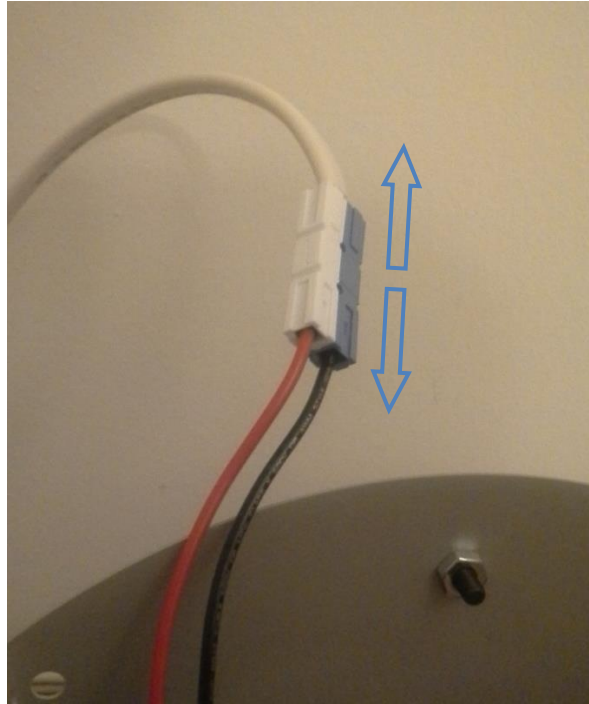

Step 2. Connect the purple-and-orange pair of click-connects from the motion sensor to the blue-and-white pair of quick connects in the LightPortal™. Make sure to connect purple to blue and orange to white.

Step 3. Connect the pink-and-yellow pair of click-connects from the motion sensor to the blue-and-white pair of quick connects coming from the Exclamation Light. Make sure to connect pink to blue and orange to white.

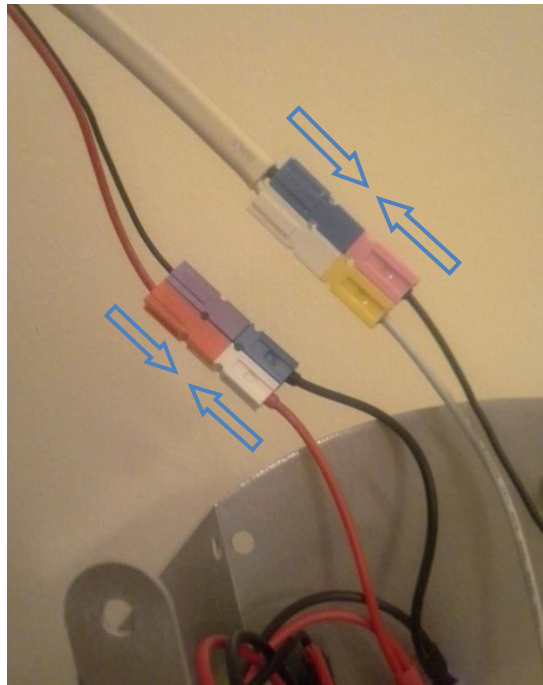

Step 4. Mount the motion sensor to the wall near the LightPortal™, by peeling the paper off the adhesive strips on the back and pressing firmly to the wall. Make sure there are no obstacles (such as the LightPortal itself) between the motion sensor and the area you want it to detect in. Wait 15 to 30 seconds for the motion sensor to ‘warm up’. Congratulations, you’re done!

Using the Motion Sensor

The motion sensor will start working once it's plugged in. It will turn the light fixture on when it detects motion, and back off after a time delay. That being said, motion sensors frequently require 15 to 30 seconds to 'warm up' before they start working reliably.

Troubleshooting:

- Keep in mind that the switch on the light fixture needs to be left in the 'on' position in order to turn the light on and off with the motion sensor.
- Sometimes, a motion sensor will become improperly calibrated in its 'warm up' phase. It may not respond to motion at all, or very erratically. This is easy to fix: unplug it (purple and orange quick connects) and plug it back in again so it can 'warm up' again.
- The motion sensor works on line-of-sight. If you can't see the little white dome on the sensor, it can't see motion where you are.

To adjust the sensitivity and time delay:

Step 1. Pop the back panel off the motion sensor (with a fingernail or flat-bladed screwdriver). You will see two small blue squares with Philips-head sockets in them inside the case. Orient the motion sensor so the wires are coming out the bottom.

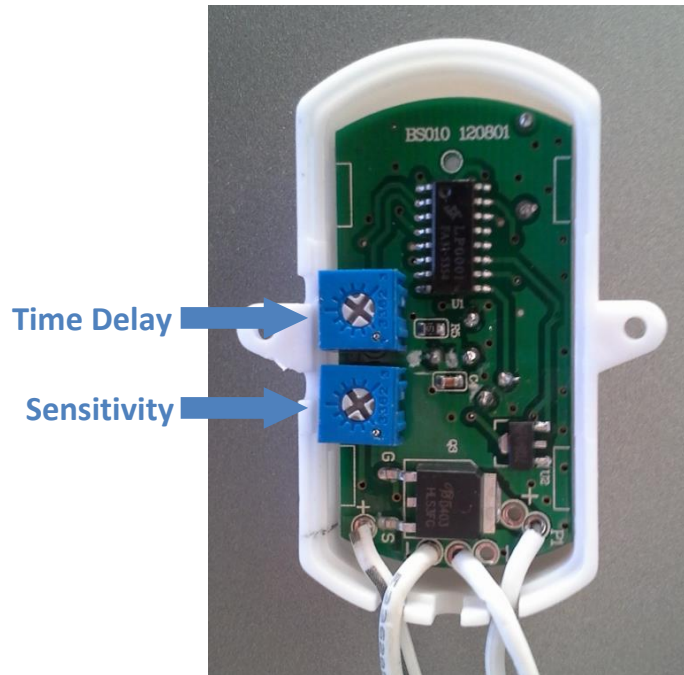

Step 2. The top blue square controls time delay. Using a small screwdriver (gently) turn it clockwise to shorten the time delay or counterclockwise to lengthen the time delay. All the way clockwise is about 8 seconds; all the way counterclockwise is about 10 minutes.

Step 3. The bottom blue square controls sensitivity. Using a small screwdriver (gently) turn it clockwise to reduce sensitivity (takes more motion to turn on) or counterclockwise to increase sensitivity (takes less motion to turn on).

If you encounter any difficulties, please consult our website at www.yetisolar.com, e-mail us at sales@yetisolar.com, or call us at 571-423-9473.