

BELOW ARE DETAILED STEP BY STEP INSTALLATION PHOTOS OF THE INSTALLATION OF THE NAVIGATION IN THE CADILLAC ESCALADE.

1. A FEW PANELS MUST BE REMOVED TO PROVIDE ACCESS. BEGIN BY "POPPING" UP THE CENTER CONSOLE AREA AND THE DASH PANEL TO THE RIGHT OF THE SCREEN. THESE PANELS ARE NOT HELD IN WITH ANY SCREWS, JUST FRICTION CLIPS WHICH ARE DISLODGED WITH A FLAT BLADE SCREWDRIVER OR PANEL REMOVAL TOOL.



2. NEXT, THE PANEL SURROUNDING THE SCREEN AND RADIO IS POPPED FREE FROM ITS FRICTION CLIPS AND THE 2 CONNECTORS ON THE BACK OF THE TRIM IS UNPLUGGED TO ALLOW IT TO BE FULLY REMOVED. THIS WILL EXPOSE THE 7MM SCREWS HOLDING THE SCREEN/RADIO ASSEMBLY IN PLACE.



3. FINISH BY REMOVING THE SCREWS AROUND THE OUTSIDE OF THE SCREEN/RADIO AND TILTING THE ASSEMBLY REARWARD TO VIEW THE CONNECTORS. UNPLUG THE CONNECTORS.



4. INSTALL THE SUPPLIED GPS ANTENNA JUST BENEATH YOUR WINDSHILED DASH COVER (UNDER THE WINDSHIELD). PRY UP PANEL TO GAIN ACCESS. ROUTE THE GPS ANTENNA CORD TO THE REAR OF THE NAVIGATION RADIO AND PLUG INTO THE BLUE FAKRA CONNECTOR.

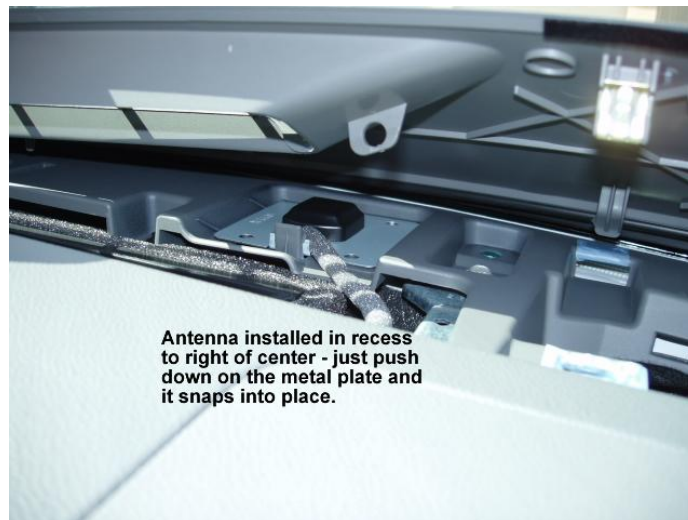

YOUR INSTALLATION IS NOW COMPLETE!