

Fibre Flare

M.V.P

FIBREOPTIC HELMET LIGHT INSTRUCTION MANUAL



BATTERY INSERTION & SUCTION CUP INSERTION PROCEDURE

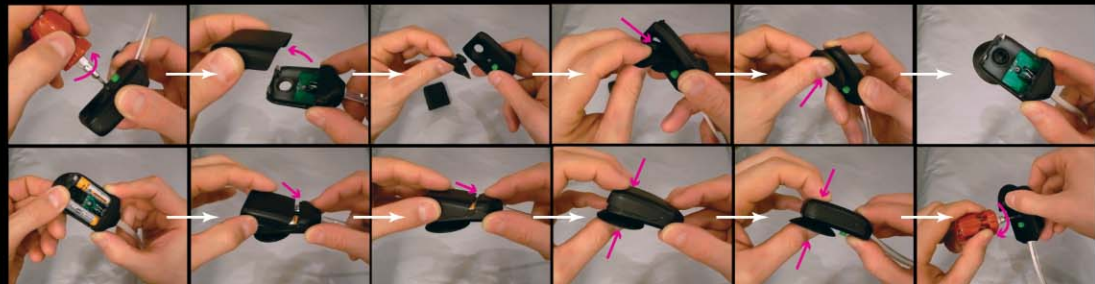

- ALWAYS CHECK FOR CORRECT POLARITY ORIENTATION WHEN INSERTING BATTERIES
- WHEN TIGHTENING CENTRAL SCREW AVOID OVER TIGHTENING WITH EXCESSIVE FORCE

SILICONE 'LADDER SLING' INSERTION PROCEDURE



ATTACHING SILICONE LADDER SLING TO BICYCLE HELMET



- USE THE LADDER SLING TO THREAD THROUGH THE VENTS IN YOUR HELMET, FIND THE CORRECT 'RUNG' AND SECURE FIRMLY
- EACH HELMET IS UNIQUE, SO BE SURE TO EXPERIMENT WITH DIFFERENT LOCATIONS AND POSITIONS BEFORE TRIMMING SLINGS
- WHEN TRIMMING EXCESS LADDER SLING, BE SURE TO LEAVE ENOUGH EXCESS REMAINING TO BE 'TUCKED' UNDER THE HOUSING

ADHESIVE 'LANDING PAD' APPLICATION



- FOR OPTIMUM SUCTION CUP ADHESION TO ALMOST ANY SURFACE USE ADHESIVE 'LANDING PADS' PROVIDED
- WHEN APPLYING SUCTION CUPS TO THE 'LANDING PADS' BE SURE THEY ARE CENTRED AND NOT OVER THE EDGE OF THE 'PAD'
- WHEN APPLYING SUCTION CUPS TO ANY SMOOTH SURFACE BE SURE THE SUCTION CUPS ARE CLEAN AND FREE FROM DIRT
- LANDING PADS ARE DURABLE AND CAN BE REMOVED AND RE-APPLIED MULTIPLE TIMES SO YOU CAN FIND THE PERFECT LOCATION
- IF THE SURFACE IS A MAT FINISH, DIRTY, SCRATCHED OR WORN 'LANDING PADS' SHOULD ALWAYS BE USED
- WHEN APPLYING 'LANDING PADS' BE SURE THE SURFACE IS CLEAN AND FREE FROM DIRT AND DUST FIRST
- WHEN MOUNTING M.V.P. IN A STRIGHT LINE AVOID APPLYING TENSION TO THE OPTIC; ALLOW THE OPTIC TO 'FLOAT' ABOVE THE SURFACE OF THE HELMET; IF TENSION IS APPLIED BETWEEN OPTIC AND HELMET SURFACE FALSE TRIGGERING MAY OCCUR

TURNING YOUR M.V.P ON / OFF (& SWITCHING BETWEEN PROGRAMS)

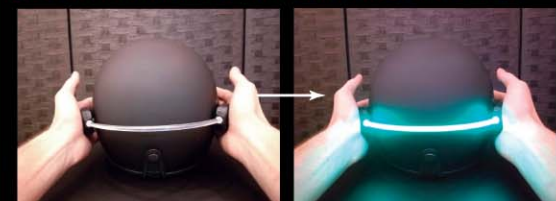

- EACH END OF THE M.V.P. IS ELECTRONICALLY INDEPENDENT.
- WHEN TURNING THE M.V.P. 'ON/OFF (OR CHANGING PROGRAMS) ALWAYS PRESS BOTH ENDS AT THE SAME TIME
- TO TURN 'ON' TO THE 'SOLID/CONSTANT PROGRAM' SIMPLY PRESS BOTH HOUSINGS AT THE SAME TIME (ONCE)
- TO TURN 'ON' TO THE 'FLASHING PROGRAM' SIMPLY PRESS BOTH HOUSINGS (TOGETHER) A SECOND TIME
- TO TURN 'OFF' SIMPLY PRESS BOTH HOUSINGS (TOGETHER) A THIRD TIME
- DO NOT MOUNT WITH TENSION BETWEEN OPTIC AND HELMET; FIBRE OPTIC SHOULD 'FLOAT' ABOVE HELMET SURFACE
- IF TENSION IS APPLIED BETWEEN OPTIC AND HELMET SURFACE FALSE TRIGGERING MAY OCCUR

Patents Pending.
 Copyright 2011 A.L.L. Innovations Pty Ltd.
 'Fibre Flare™' is a trademark of A.L.L. Innovations Pty. Ltd.
 Designed in Australia.  
 Made in China.
 For warranty information see:
WWW.FIBREFLARE.COM

ADJUSTING FIBREOPTIC WHILE MOUNTED

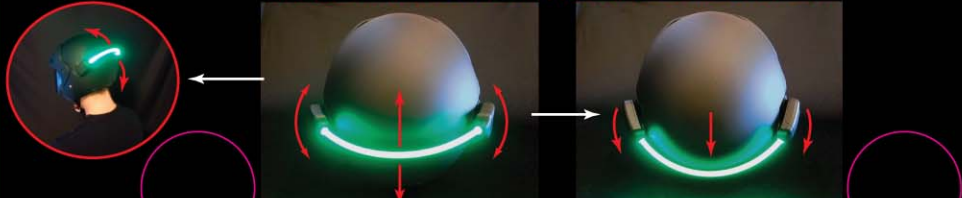

- M.V.P. HOUSINGS CAN BE ROTATED TO DESIRED POSITION WHILST MOUNTED
- TO ALLOW EASY ROTATION DO NOT MOUNT WITH TENSION BETWEEN OPTIC AND HELMET; FIBRE OPTIC SHOULD 'FLOAT' ABOVE HELMET SURFACE

WARNING:

Always check your local laws for proper vehicle lighting regulations before using the M.V.P. on the road.