

Giamore rings are specified using ISO standard sizes.
Find your own ring size by following one of the methods below.

1 FIND YOUR RING SIZE USING AN EXISTING RING

Use this method if you have a ring that perfectly fits the finger where you want to wear your Giamore ring.

1. Print this document, make sure the printer is set to 100%. Confirm the printout by measuring the bar below. If the measurement is not correct, you need to reprint before you continue.



2. Place the ring on the circles to the right. The selected circle should be visible inside your ring:
 - If you can't see the printed circle, move to a smaller size.
 - If you see some space between your ring and the circle, choose a bigger size.
 - In case you're in between sizes choose the next bigger size.

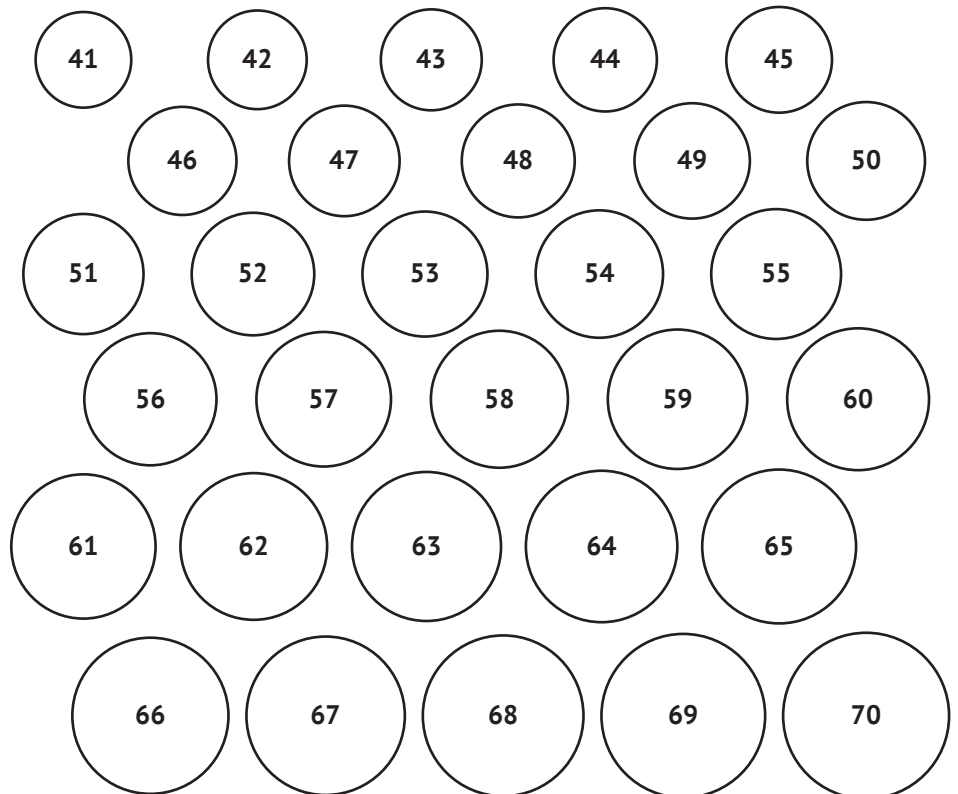

2 FIND YOUR RING SIZE BY MEASURING YOUR FINGER

Choose the finger you want to wear the ring on. We recommend to measure at the end of the day. Also, please try to avoid days that are too hot or cold because it may affect the size.

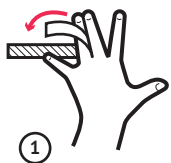

Use a strip of paper to wrap around your finger. The size should be measured around the largest part of your finger, usually the knuckle.

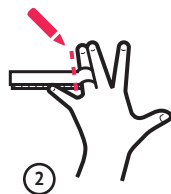

Carefully mark the paper on both sides close to your finger. The fit should not be too tight or too loose.

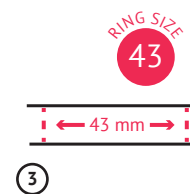

Remove the paper and measure the stretch between your marks. The length in mm is your ringsize.