

2007-2008 CHEVROLET SILVERADO / SUBURBAN / TAHOE / AVALANCHE / GMC SIERRA / YUKON

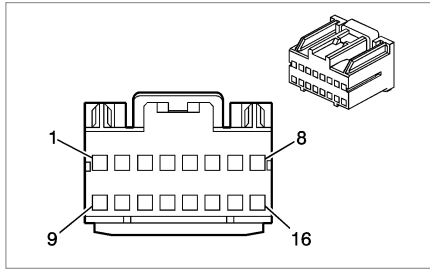

NOTE: IF THERE ARE ANY WIRES CURRENTLY IN PLACE IN POSITIONS 1, 2, 3, OR 4, THEY MUST BE REMOVED PRIOR TO INSTALLING THE NEW MIRROR!!.

Pin	Wire (COLORS MAY VARY)	Function
1	RED	**NEW** Camera Video Feed +
2	BLACK	**NEW** Camera Video Feed -
3-4	--	Not Used
5	GREY	Automatic Day/Night Mirror Signal (DF5 with DL3 or DL4)
6	DARK GREEN/WHITE	Ambient Air Temperature Sensor Signal (Manual A/C w/DF5)
7	YELLOW	Low Reference (Manual A/C w/DF5)
8	BLACK	Ground
9	DARK BLUE	Backup Lamp Relay Control (YE9)
10	--	Not Used
11	DARK GREEN/WHITE	OnStar Keypad Signal (UE1)
12	LIGHT GREEN/BLACK	Keypad Supply Voltage (UE1)
13	PINK	Ignition 1 Voltage (YE9)
14	YELLOW/BLACK	Keypad Green LED Signal (UE1)
15	BROWN/WHITE	Keypad Red LED Signal (UE1)
16	PINK	Low Reference (DF5 with DL3 or DL4)

****NOTE**NOTE**NOTE**NOTE**NOTE**NOTE**NOTE**NOTE**NOTE**NOTE**NOTE**NOTE**NOTE****

The mirror will only show an image when the vehicle is on and in reverse. The image will only be displayed for a maximum of about 2 minutes; after that it will shut off until the next time you put your vehicle in reverse. This is how these mirrors are designed, so as to prevent the LCD screen from overheating.

Please see the separately provided information on how to remove wires from the mirror plug, as well as how to add new wires to the existing plug.

Once you have added the video wires to positions 1 and 2 of your mirror plug, run the cable along the leading edge of the headliner, down the A-pillar (trim removal instructions appear later in this document), to the bottom of the dash.

You will need to separately purchase and install a backup camera of your choice. This mirror works with just about any backup camera (be sure it is NTSC format though). You can power your camera from the reverse lights at the back of your truck, or you can run the camera power wires into the cab of your truck & connect them to the left electrical center connector X9 or X10 (see following pages) & then just ground the camera wherever convenient. The connector pinouts are provided as a courtesy; I cannot guarantee that these connection points are there and/or live, as there are numerous wiring variations on the trucks.

Once you have run the camera's video cable into the cab of your truck (a good place to do this is under the driver's side carpet, via the parking brake cable rubber boot – cut a slit in it, push the video cable thru, seal the slit with polyurethane or butyl rubber caulk (don't use silicone, latex, or acrylic caulk)), then plug the camera's video cable into the mirror's video cable. This cable is only for video; it does not provide power for your backup camera.

Junction Block - Left Electrical Center Connector X9 (BLACK)

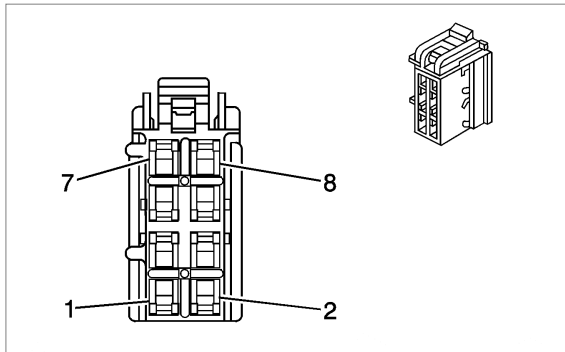

Pin	Wire	Circuit	Function
1	0.35 PK	1639	Ignition 1 Voltage (YE9) or (DL3 with DD8 or DRC)
2	0.35 WH/BK	5515	Inside Air Temperature Sensor Assembly Control (CJ2)
3	0.5 OG	1054	Stop Lamp Supply Voltage Signal
4	0.35 D-GN	734	Inside Air Temperature Sensor Signal (CJ2)
5	0.35 PK	1139	Ignition 1 Voltage (AL0 or C99)
6	0.5 WH/BK	158	Courtesy Lamp Supply Voltage
7	0.35 D-GN	6101	Low Reference (CJ2)
8	0.5 GY	157	Courtesy Lamp Control

Either of the two highlighted terminals above can be used to power the rearview mirror (and backup camera if you so desire to connect your camera's power wires here instead of at the reverse lights). This wire supplies power to the mirror when the ignition is on. This only applies to trucks that DO NOT have this wire in place in the existing mirror plug.

If you do not find the highlighted wires in the plug, you will need to find an alternative wire that you can tap into that is hot only with the ignition on. For more information please consult your local GM dealer.

Junction Block - Left Electrical Center Connector X10 (GREY)

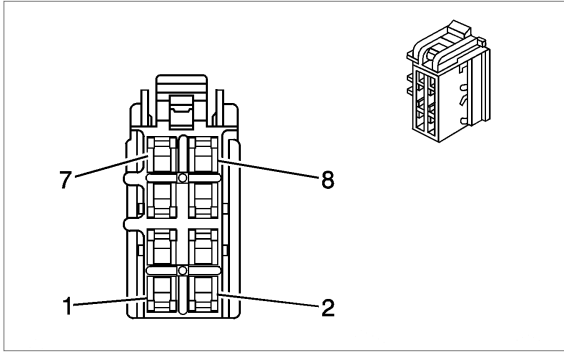

Pin	Wire	Circuit	Function
1	0.5 RD/WH	240	Battery Positive Voltage (TRW, 5Y0, 5X7 or UG1)
2	0.35 OG	6815	Inadvertent Power Control
	0.35 OG	6815	Inadvertent Power Control (Extended Cab or Crew Cab without YE9)
3	0.35 PK	1691	Low Reference (DL3 with DD8 or DRC)
4	0.35 BN/WH	230	Instrument Panel Lamps Dimming Control
5	--	--	Not Used
6	0.35 D-GN	6134	Linear Interconnect Network Bus (YE9)
7	0.35 GY	1690	Automatic Day/Night Mirror Signal (DL3 with DD8 or DRC)
8	0.35 D-BU	38	Backup Lamp Relay Control (YE9)

The #8 wire needs to be connected to your rearview mirror, pin #9. This is to turn on the LCD screen in the mirror. This only applies to trucks that DO NOT have this wire in place in the existing mirror plug.

The backup camera can be powered from pin #8 of this connector (if you wish to connect your camera's power wires here instead of at the reverse lights).

If you do not find the highlighted wire in the plug, you will need to find an alternative wire that you can tap into that is hot only when your truck is put in reverse. For more information please consult your local GM dealer.

Kick Panel Trim Panel Removal / Replacement

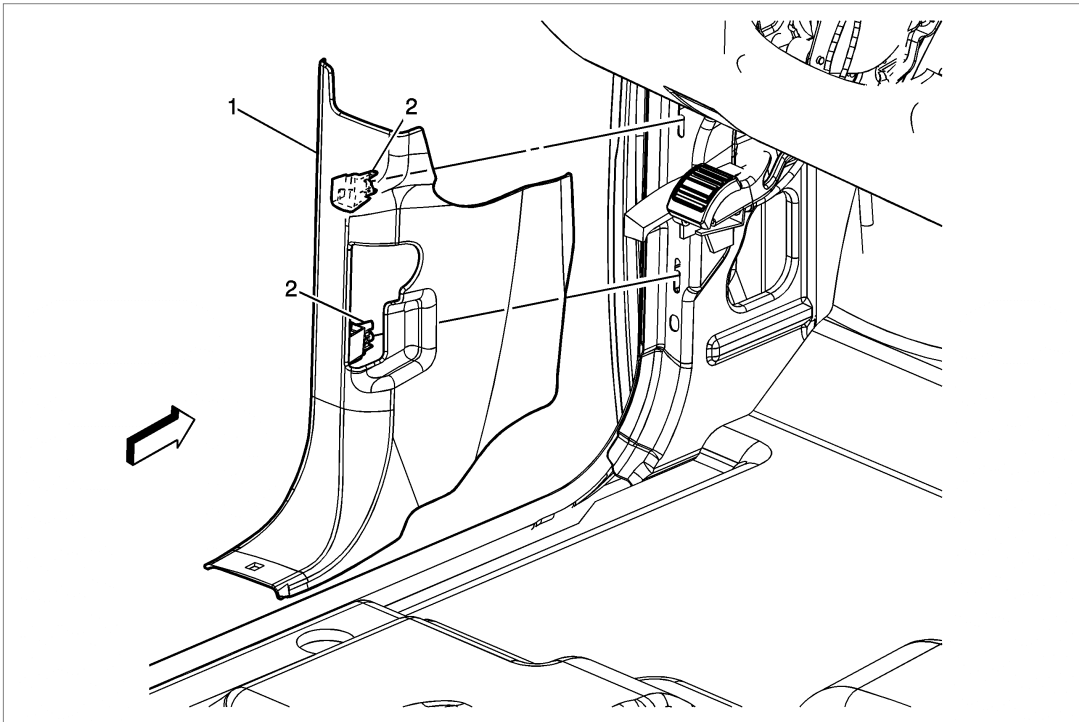

Component Name	
Preliminary Procedures	
Remove front door sill trim panel. Refer to Front Side Door Sill Trim Plate Replacement .	
1	Front Hinge Pillar / Kick Panel Trim Panel Assembly Tip The hood release handle must be in the open position for removal or installation of the LH hinge pillar panel.
2	Front Hinge Pillar Trim Panel Assembly Retainer (Qty: 2)

Front Side Door Sill Trim Plate Replacement (Regular Cab/Crew Cab)

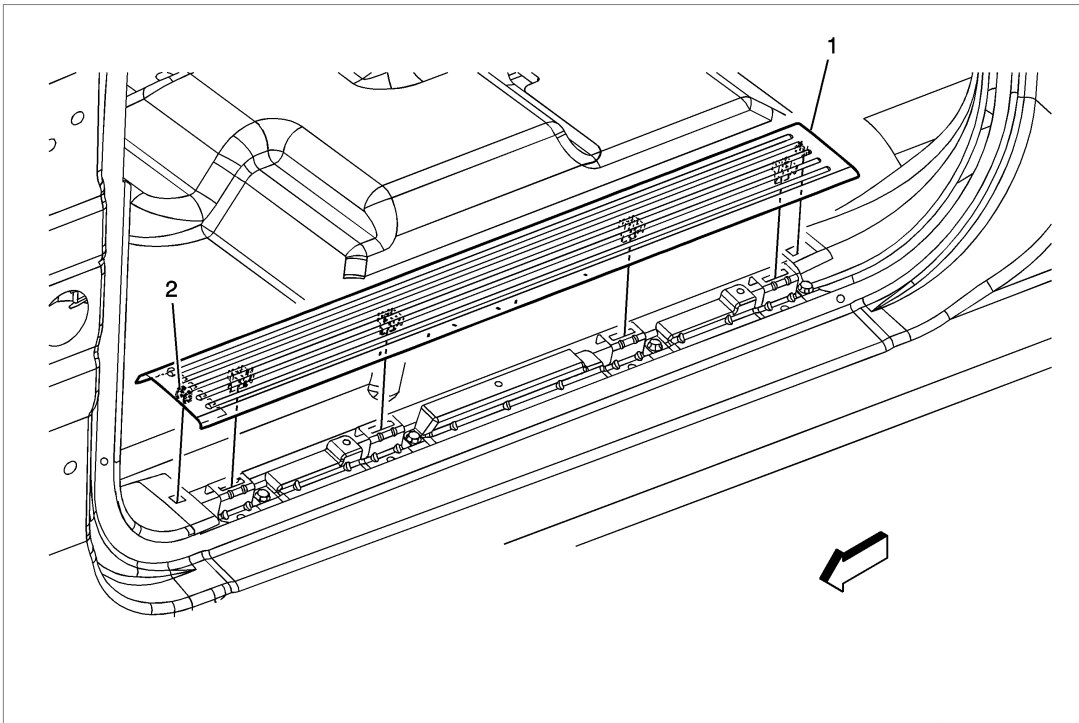

	Component Name
1	Front Side Door Sill Trim Plate Assembly
2	Front Side Door Trim Plate Retainer (Qty: 6)

Front Side Door Sill Trim Plate Replacement (Extended Cab)

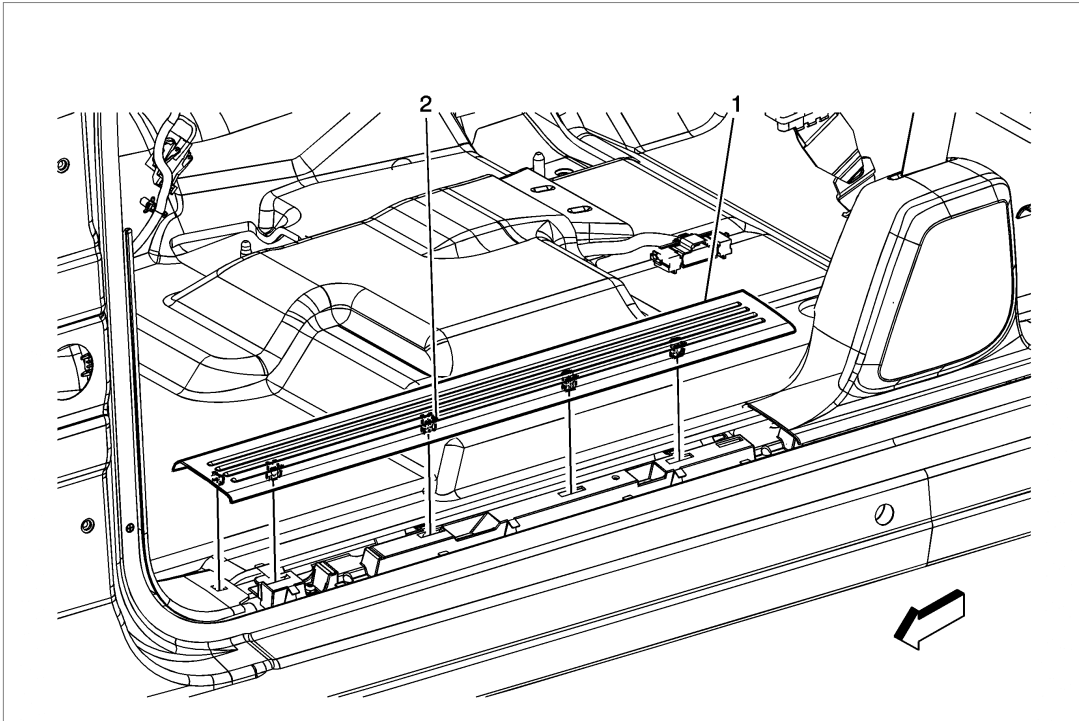

	Component Name
1	Front Side Door Sill Trim Plate Assembly
2	Front Side Door Trim Plate Retainer (Qty: 5)

NOTE: THIS PAGE DOES NOT APPLY TO TRUCKS THAT ARE PRE-WIRED FOR THE BACKUP CAMERA OPTION (INDICATED BY HAVING THE WHITE & BLUE WIRES IN THE EXISTING MIRROR PLUG).

ON THE FOLLOWING PAGE ARE INSTRUCTIONS ON REMOVING THE "A" PILLAR TRIM. IT IS NOT NECESSARY TO REMOVE THIS PIECE OF TRIM, AS THE NEW VIDEO CABLE FOR THE MIRROR CAN BE TUCKED UNDER THE EDGE OF THE "A" PILLAR TRIM WHEN RUNNING IT DOWN TO THE BOTTOM OF THE DASH.

PLEASE BE ADVISED THAT YOUR TRUCK MAY HAVE AN AIRBAG BEHIND THE "A" PILLAR TRIM; THEREFORE REMOVAL OF THE TRIM IS NOT ADVISED.

HOWEVER, IF YOU CHOOSE TO REMOVE THE "A" PILLAR TRIM, YOU ARE DOING THIS AT YOUR OWN RISK, AND I CANNOT BE RESPONSIBLE FOR ANY DAMAGE THAT MAY RESULT FROM ACCIDENTS, IMPROPER REMOVAL OF THE TRIM OR AIRBAG, ETC. PLEASE USE EXTREME CAUTION WHEN WORKING AROUND ANY AIRBAG COMPONENTS, AND WHENEVER POSSIBLE, DO NOT UNPLUG ANY AIRBAG COMPONENTS WITHOUT FIRST REFERRING TO THE FACTORY GM SERVICE MANUAL AND FOLLOWING THE REQUIRED PROCEDURE EXACTLY.

Windshield A Pillar Garnish Molding Replacement

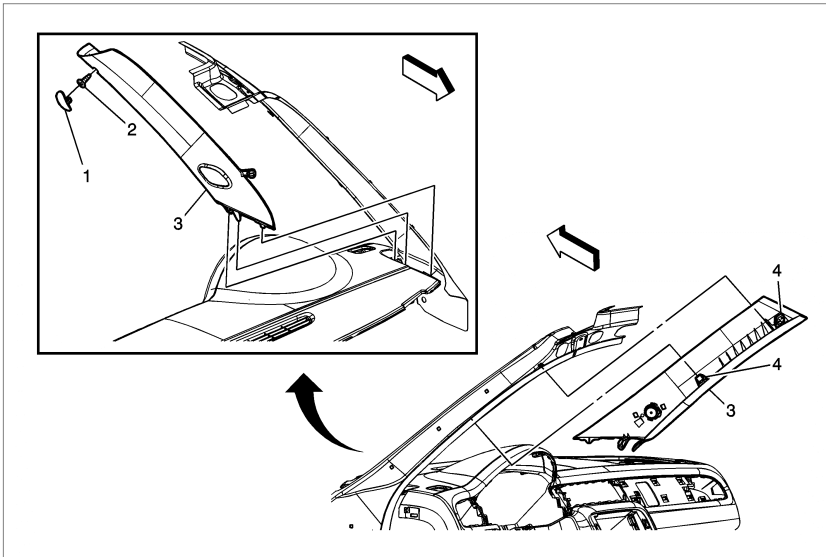

	Component Name
	<p>Preliminary Procedures</p> <ol style="list-style-type: none"> 1. Disable the roof rail SIR system. Refer to SIR Disabling and Enabling . 2. Remove the front assist handle, passenger side only. Refer to Front Assist Handle Replacement .
1	Windshield Side Garnish Molding Cover
2	<p>Windshield Side Garnish Molding Screw</p> <p>Caution: Refer to Fastener Caution .Tighten 2 N·m (18 lb in)</p>
3	<p>Windshield Side Garnish Molding Assembly</p> <p>Procedure</p> <ol style="list-style-type: none"> 1. Tabs must be installed prior to retainers. 2. Tabs to be fully seated in I/P trim panel retainer and valance panel. 3. Disconnect electrical connectors.
4	Windshield Side Garnish Molding Retainer (Qty: 2)