

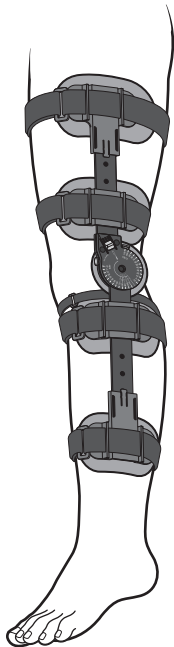

Revolution 3

Application Instructions

CP020248 Rev B 11/11



Revolution 3

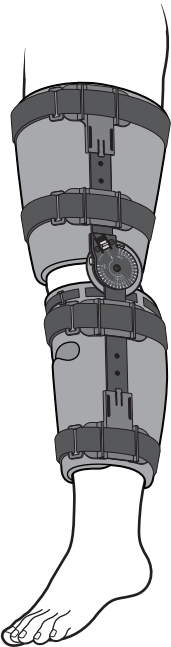

Revolution 3 Full Cuff

This device is offered for sale by or on the order of a physician or other qualified medical professional. This device is not intended for reuse on a second patient or for extended use beyond 180 days.

INDICATIONS: Indicated for immediate application following injury or operative procedures to reduce pain and swelling and aid in healing.

CAUTION: Activity modification and proper rehabilitation are an essential part of a safe treatment program. If any additional pain or other symptoms occur while using this device, discontinue use and seek medical attention.

CAUTION: This device is not intended to prevent injury, or reduce or eliminate the risk of re-injury.

CAUTION: The range-of-motion stops on both the medial and lateral hinges must be set the same.

CAUTION: This device has been developed for the indications listed above, and may be damaged by unusual activities such as sports, falls, or other accidents, or exposure of the hinges to debris or liquids. Do not leave this device in a car on a hot day, or in any other place where the temperature may exceed 150F (65 C.) for any extended period of time. To avoid the risk of accident and possible injury to the patient, discontinue use if such an incident has occurred.

WARRANTY: This device is warranted to be free from defects in material and workmanship for a period of 90 days. These warranties apply to devices that have not been modified or subjected to misuse, abuse or neglect. This device is expressly subject to Bledsoe's Product Line Limited Warranty. Copies of this limited warranty can be obtained from your medical professional, via the internet at www.BledsoeBrace.com, or by calling 1-888-BLED SOE (253- 3763).

For product information or questions pertaining to sales or service, please contact Bledsoe Brace Systems™.

© 2011 Medical Technology Inc., d/b/a Bledsoe Brace Systems™. All Rights Reserved.
2601 Pinewood Drive, Grand Prairie, Texas, 75051, USA
Toll Free Tel.1.888.BLED SOE (253.3763)
Or 1.800.527.3666 • Local 972.647.0884
Local FAX 972.660.5495
International FAX 972.606.0649
www.BledsoeBrace.com

TO FIT THE REVOLUTION 3

- ① **LOOSEN ALL FOUR STRAPS**
Pull each strap through the D-ring and attaching it back on itself to prevent entanglement.

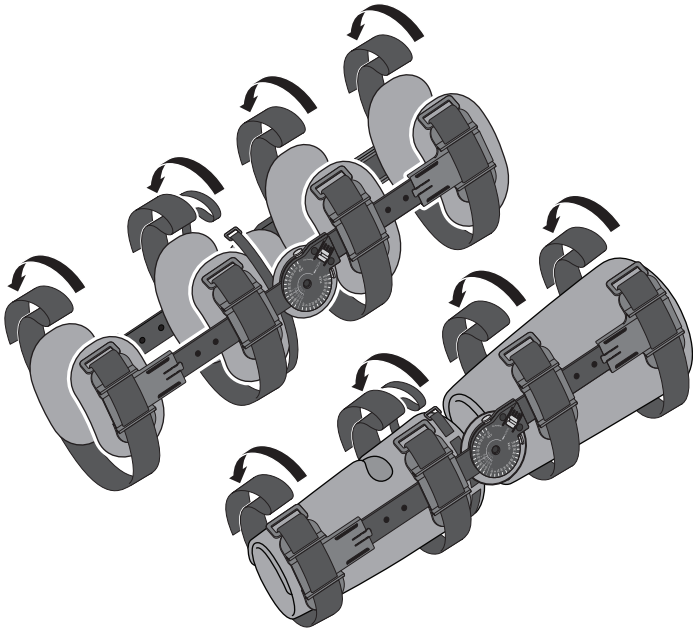

- ② **FIT THE BRACE**
Hold the brace beside the leg to determine the proper length, aligning the hinge with the center of the knee.

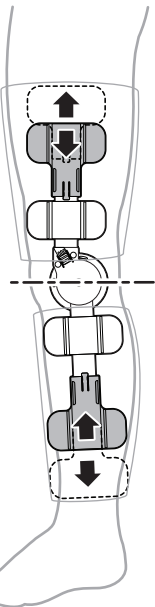

- ③ **SET CALF AND THIGH LENGTH**
Lift the locking tab up to free the extension arm (of the desired arm - top or bottom). Slide the extension arms to desired length and release locking tab back in place to lock extension arm.

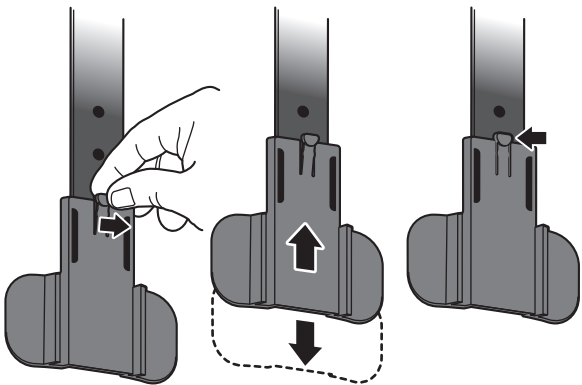

TO APPLY THE REVOLUTION 3

- ④ **APPLY BRACE TO LEG**
Revolution 3: With the leg extended, slide the brace underneath the leg with closure at front (Rear Closure brace = closures at back). Make sure the center of the hinge is aligned with the center of the knee. Align the arms of the brace along the midline of the leg. The hinges should be parallel with the knee joint.

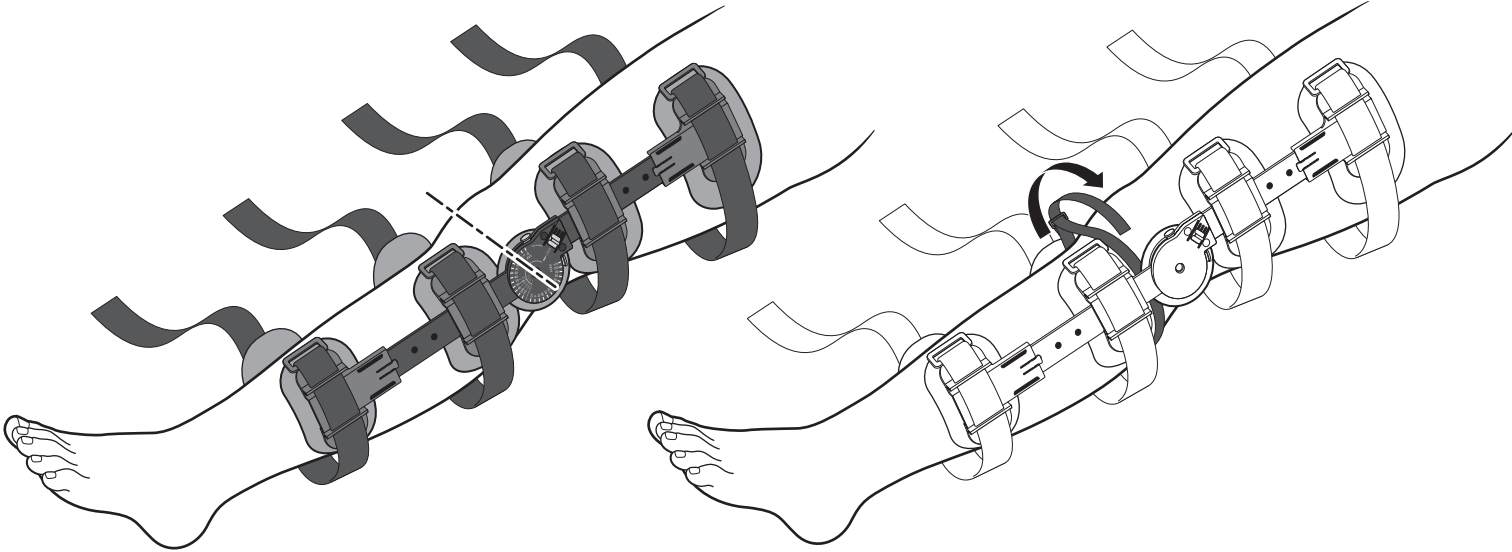

Attach 1" gastroc strap (smallest strap located above the calf area). Wrap the strap around the leg and pull through the D-ring, then attach to double-sided hook, and trim off excess.

TO APPLY THE REVOLUTION 3 FULL CUFF

- APPLY BRACE TO LEG**
Remove hinge arm that does not have D-rings and let it hang free from the other hinge arm side. With the leg extended, slide the brace underneath the leg with closure at front. Open both cuffs, wrap the cuffs around the leg, trim cuffs to desired length, and close the cuffs with hook attachment.

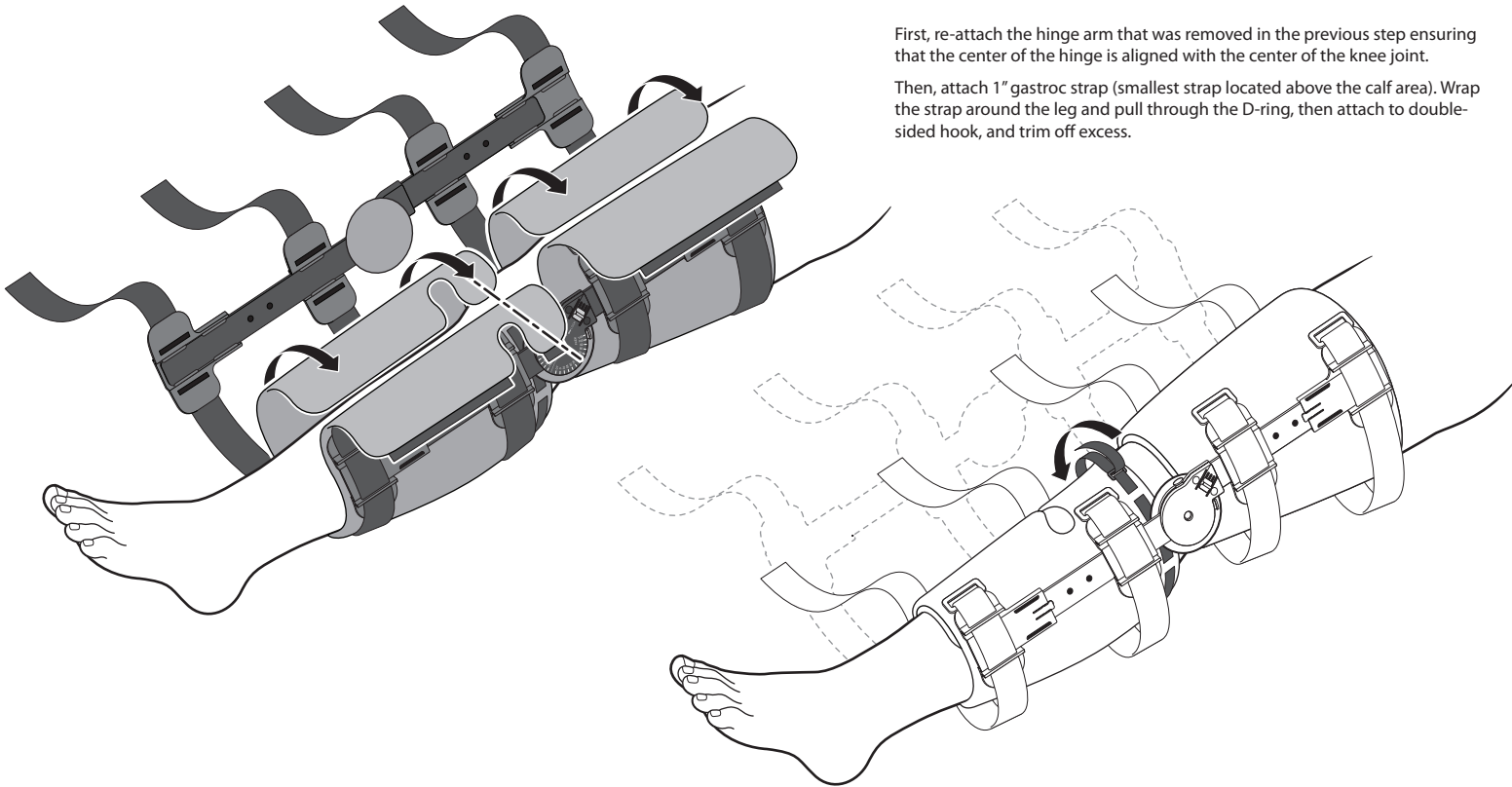

First, re-attach the hinge arm that was removed in the previous step ensuring that the center of the hinge is aligned with the center of the knee joint.

Then, attach 1" gastroc strap (smallest strap located above the calf area). Wrap the strap around the leg and pull through the D-ring, then attach to double-sided hook, and trim off excess.

APPLICATION INSTRUCTIONS CONTINUED NEXT PAGE

APPLICATION INSTRUCTIONS CONTINUED

- 5

APPLY STRAPS

Pull straps tight against back of the leg (Rear Closure = pull straps against front of the leg). Feed the strap end through the corresponding D-ring, then attach to double sided hook and trim off excess.

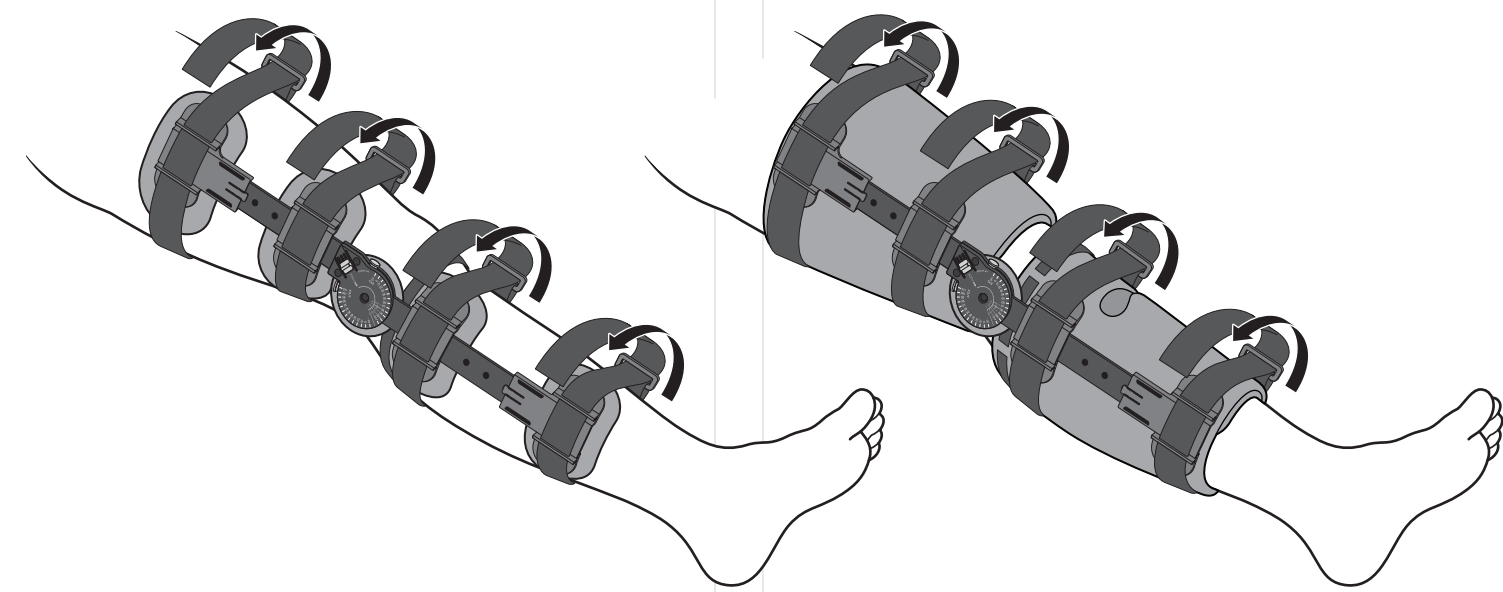

TO TRIM THE STRAP LENGTH

Determine the length of strap desired and trim the excess with scissors. Remove the double-sided hook from the trimmed portion and re-attach it to the shortened length of strap.

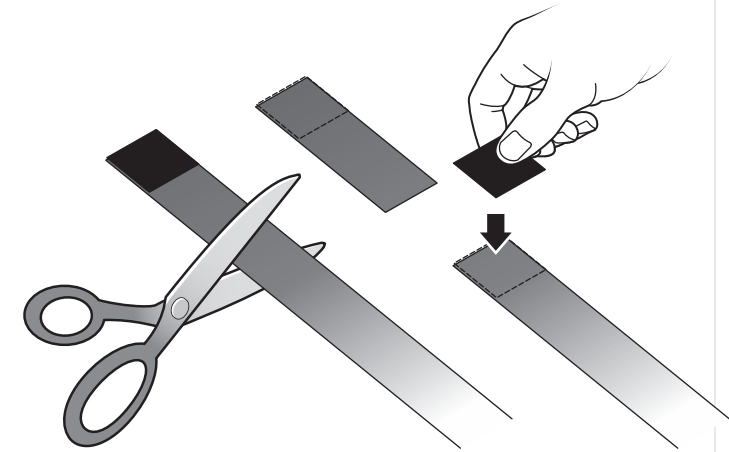

HINGE INSTRUCTIONS

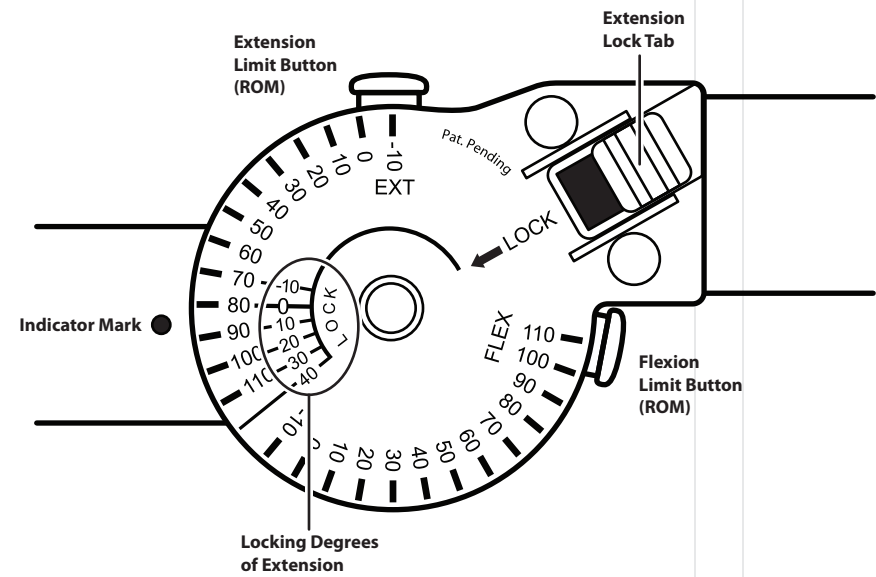

- 1

SET RANGE-OF-MOTION

Depress extension ROM button and slide to desired ROM setting. Depress flexion ROM button and slide to desired ROM setting. Adjust opposite hinge to match the setting of first hinge (this step is vital to ensure proper knee protection). NOTE: Settings automatically lock into place.

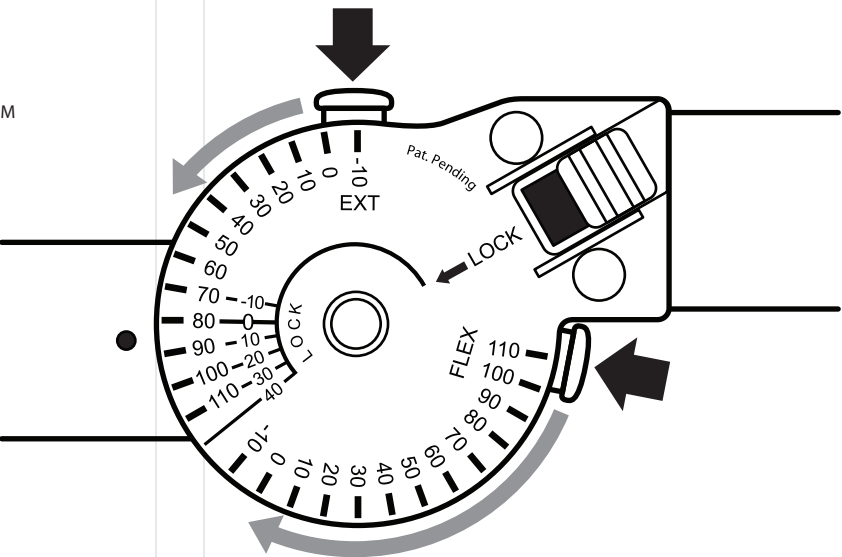

- 2

LOCK HINGE

Lock hinge at a desired -10, 0, 10, 20, 30, or 40 . Bend the leg to desired setting and engage lock. This will lock the brace in place independent of ROM settings. Make sure ROM settings do not interfere with desired lock setting.

